

TD0121- Low Eave Sheeted Wall w/Horizontal Gutter

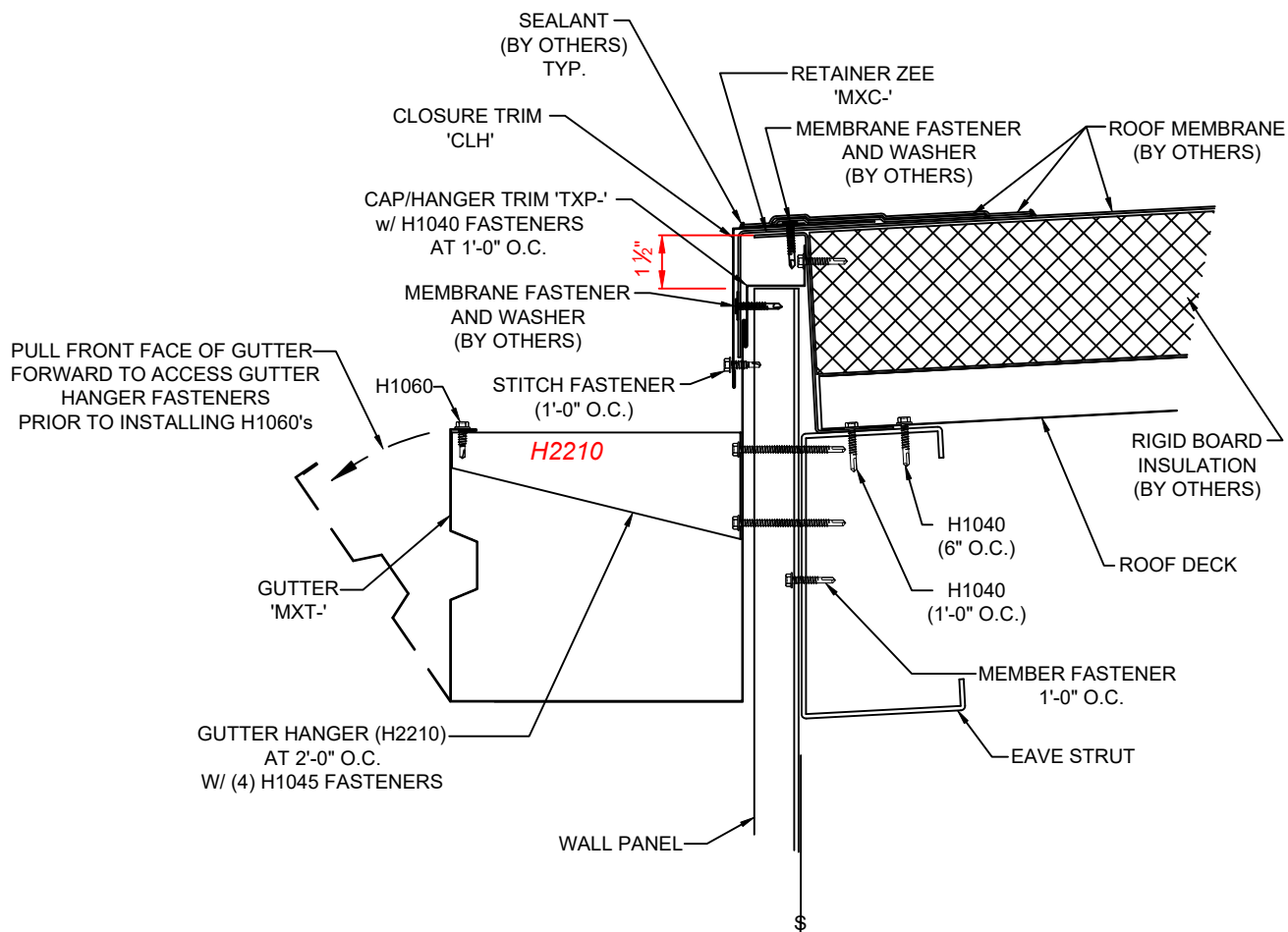

NOTES:

1. FIELD TRIM BOTH FLANGES OF INSIDE GUTTER SECTION AS SHOWN.
2. APPLY 1/4" BEAD OF SEALANT 3/4" FROM THE END OF THE GUTTER.
3. PLACE GUTTER SECTIONS TOGETHER WITH 1" LAP.
4. SECURE GUTTER SECTIONS TOGETHER WITH POP RIVETS.

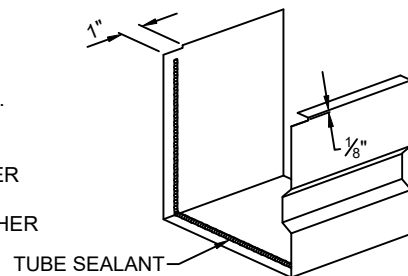

TD0121K

MEMBRANE W/ HORIZONTAL GUTTER AND SHEETED WALL