

Kirby (KFS_) 1" Flat Soffit / Roof Liner

- SB0001 - Fastener Installation and Spacing
 - SB0002 - Eave Extension (LSW) at Sheeted Wall
 - SB0003 - Eave Extension (HSW) at Sheeted Wall
 - SB0004 - Flat Soffit Splice Detail
 - SB0005 - Flat Soffit @ Peak w/ Panels Running w/E'Wall Detail
 - SB0015 - Flat Soffit @ Peak w/ Panels Perpendicular to E'Wall Detail
 - SB0006 - Horizontal Flat Soffit Panel at Sheeted Wall
 - SB0100 - Flat Soffit (Mitered) Corner Detail
 - SB0020 - Eave Extension w/ Horizontal Soffit Template Detail
 - SB0325 - End Framing Detail for Horizontal Soffit
 - SB0327 - Transition Framing to E'wall, Panels Perpendicular to E'wall
 - SB0328 - Transition Framing to E'wall, Panels Running w/E'wall
 - SB0329 - Detail Thru End Framing (See SB0327 & SB0328)
-

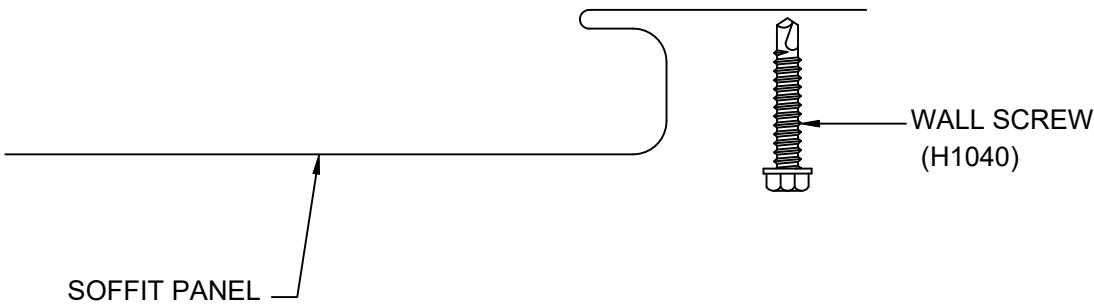

DETAIL "A"

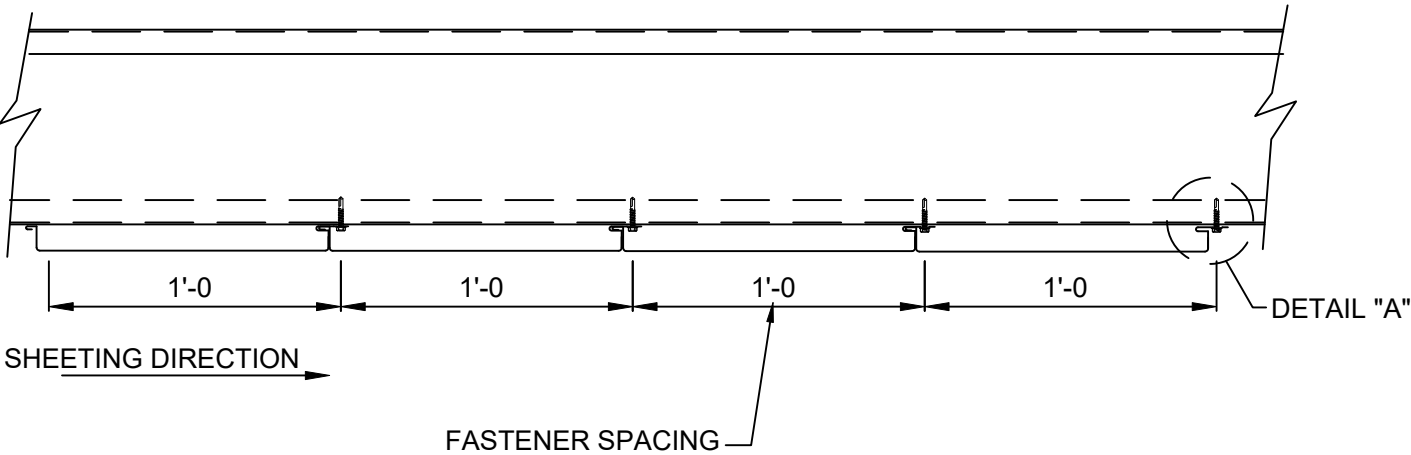

TYPICAL @
ALL EAVE STRUTS
ALL PURLINS
ALL GIRTS

SB0001

FASTENER INSTALLATION AND SPACING
FOR KFS_ 1" FLAT SOFFIT/LINER PANEL

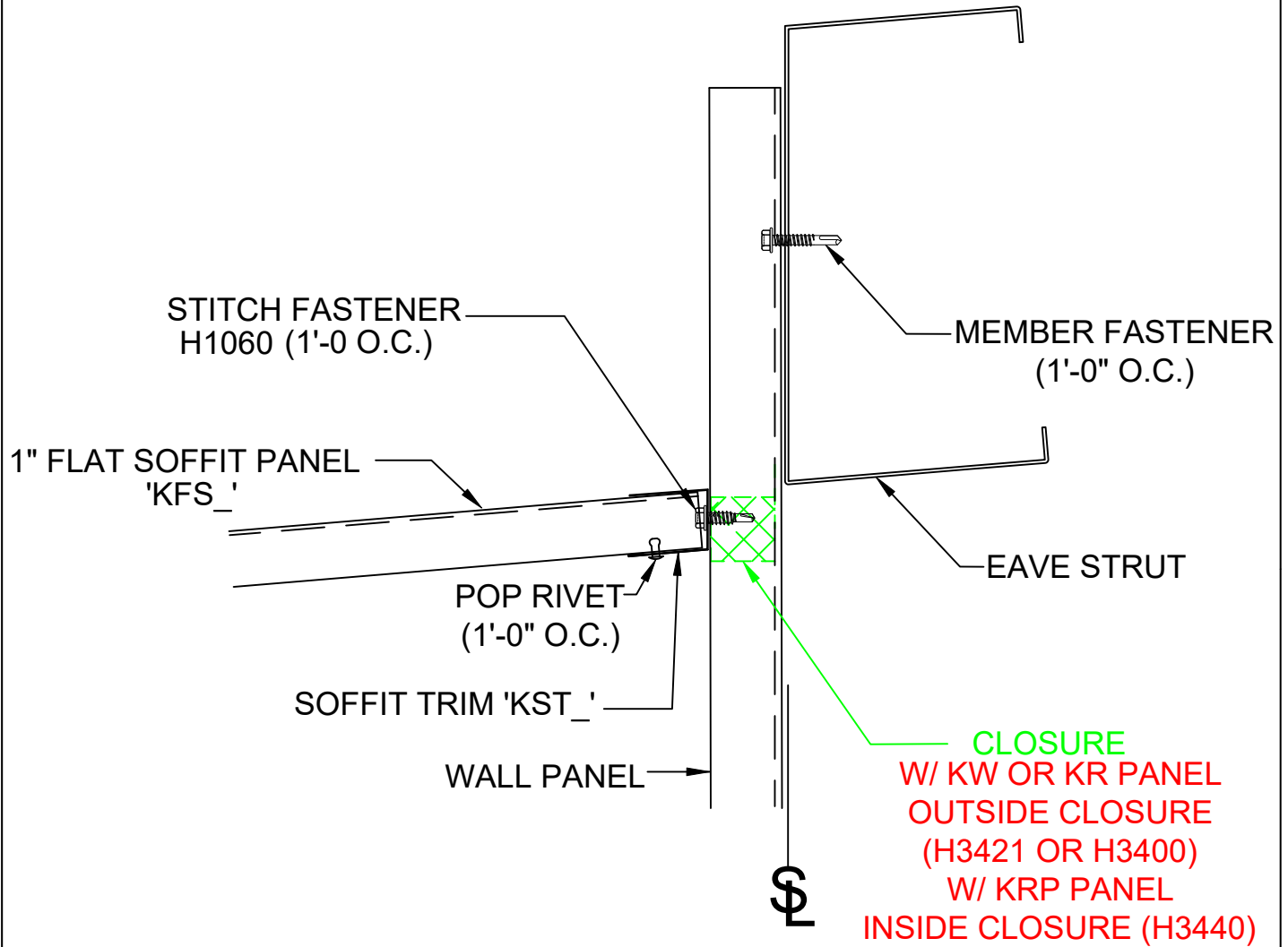

SB0002

EAVE EXTENSION (LSW) WITH 1" FLAT SOFFIT
@ SHEETED WALL

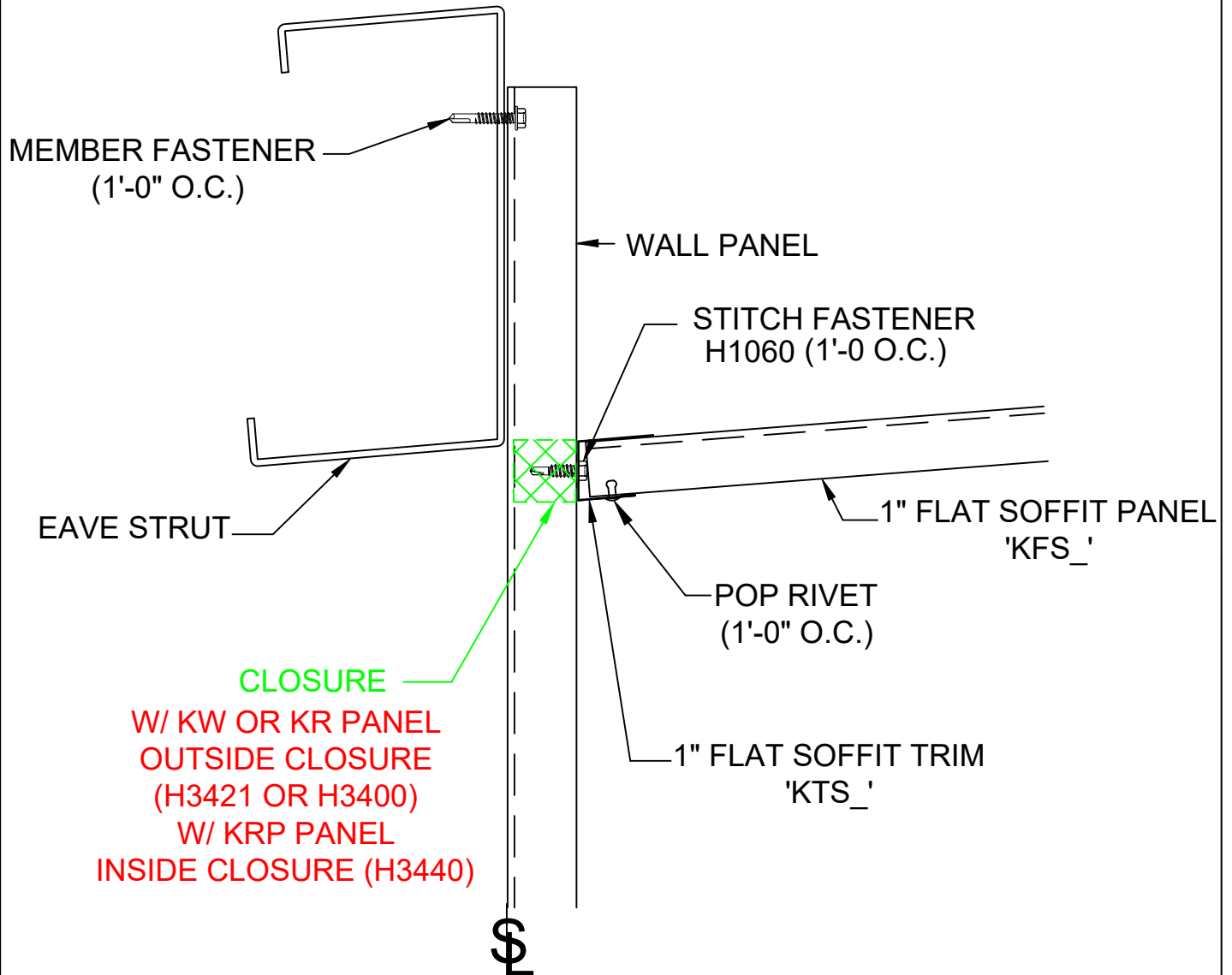

SB0003

EAVE EXTENSION (HSW) WITH 1" FLAT SOFFIT
@ SHEETED WALL**KIRBY
BUILDING
SYSTEMS**

A NUDOR COMPANY

BETTER SOLUTIONS. BETTER BUILDINGS.

PREPARED BY: IJB

DATE: 4-24-20

SB0003

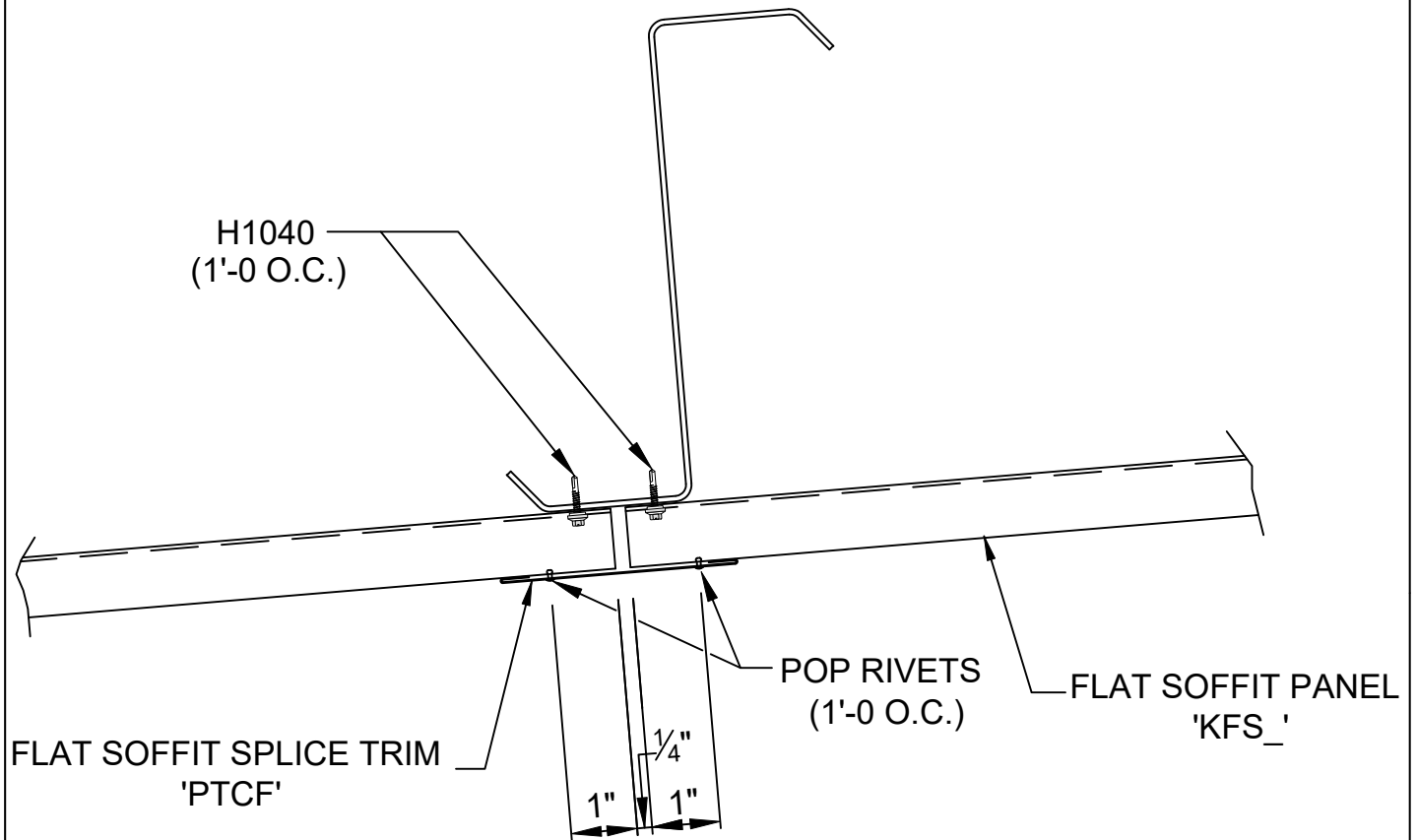

SB0004

1" FLAT SOFFIT/LINER PANEL SPLICE DETAIL

**KIRBY
BUILDING
SYSTEMS**

A NUDOR COMPANY

BETTER SOLUTIONS. BETTER BUILDINGS.

PREPARED BY: IJB

DATE: 8-2-2018

SB0004

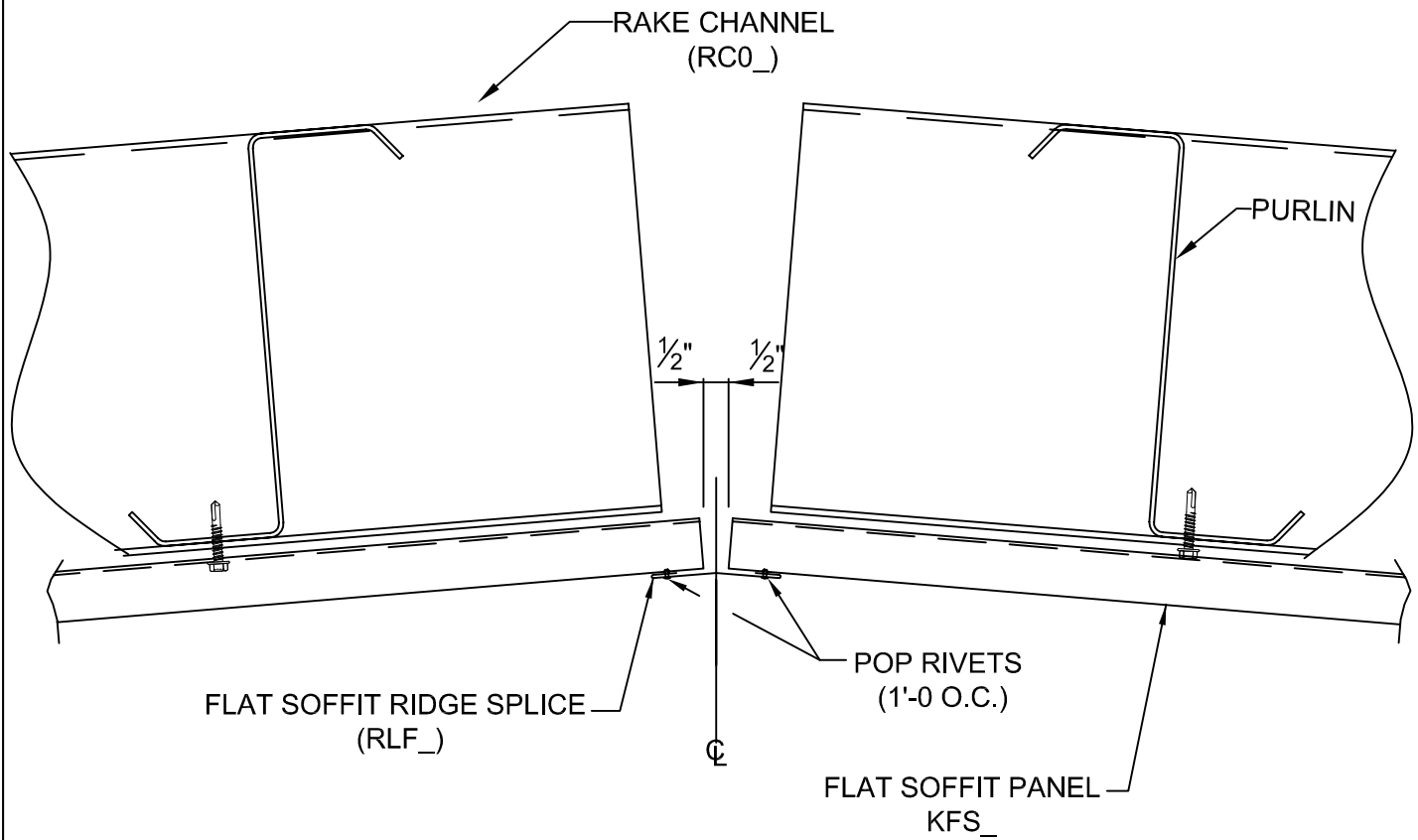

SB0005

1" FLAT SOFFIT / ROOF LINER PANEL AT PEAK DETAIL,
PANELS RUNNING WITH THE ENDWALL

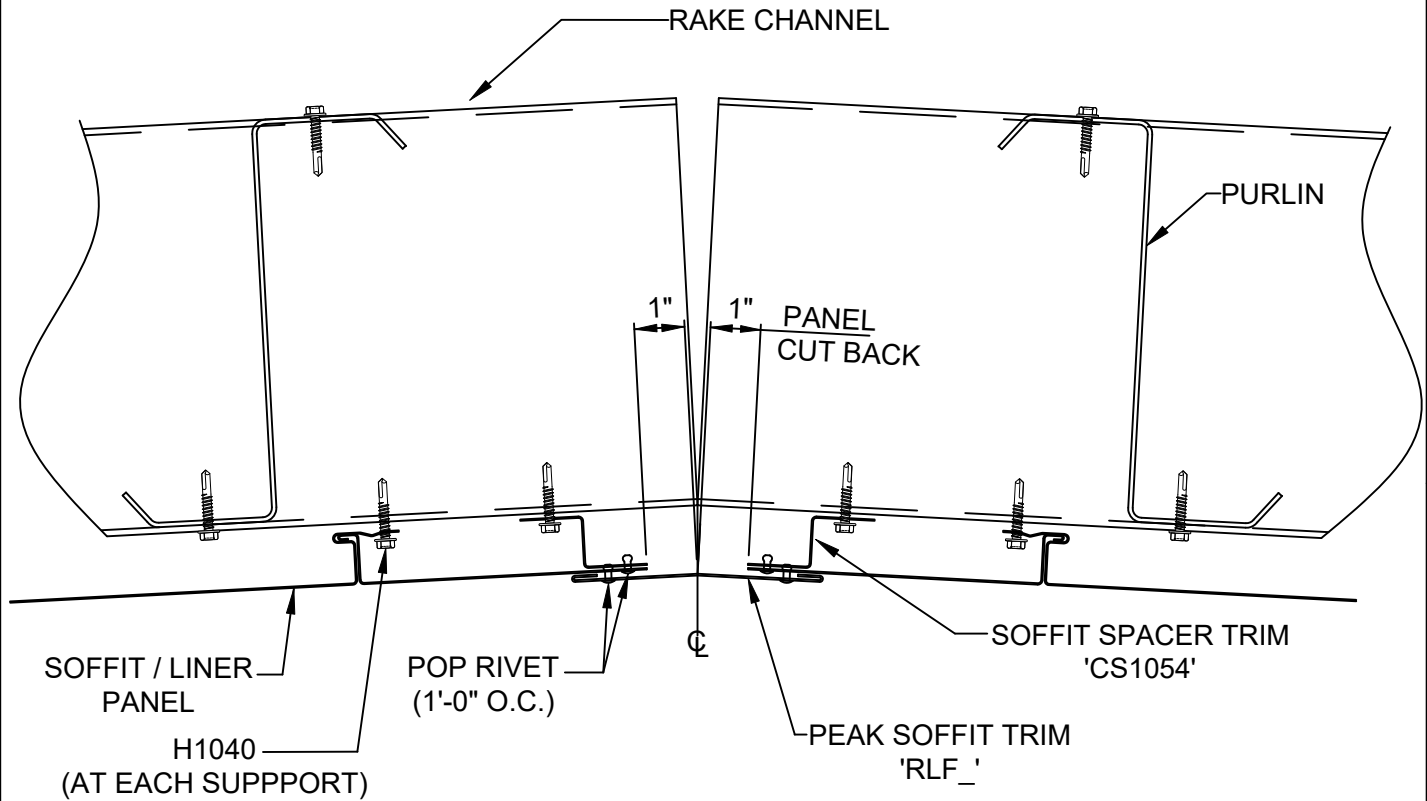

SB0015

1" FLAT SOFFIT / ROOF LINER PANEL AT PEAK DETAIL,
PANELS RUNNING PERPENDIULAR TO THE ENDWALL

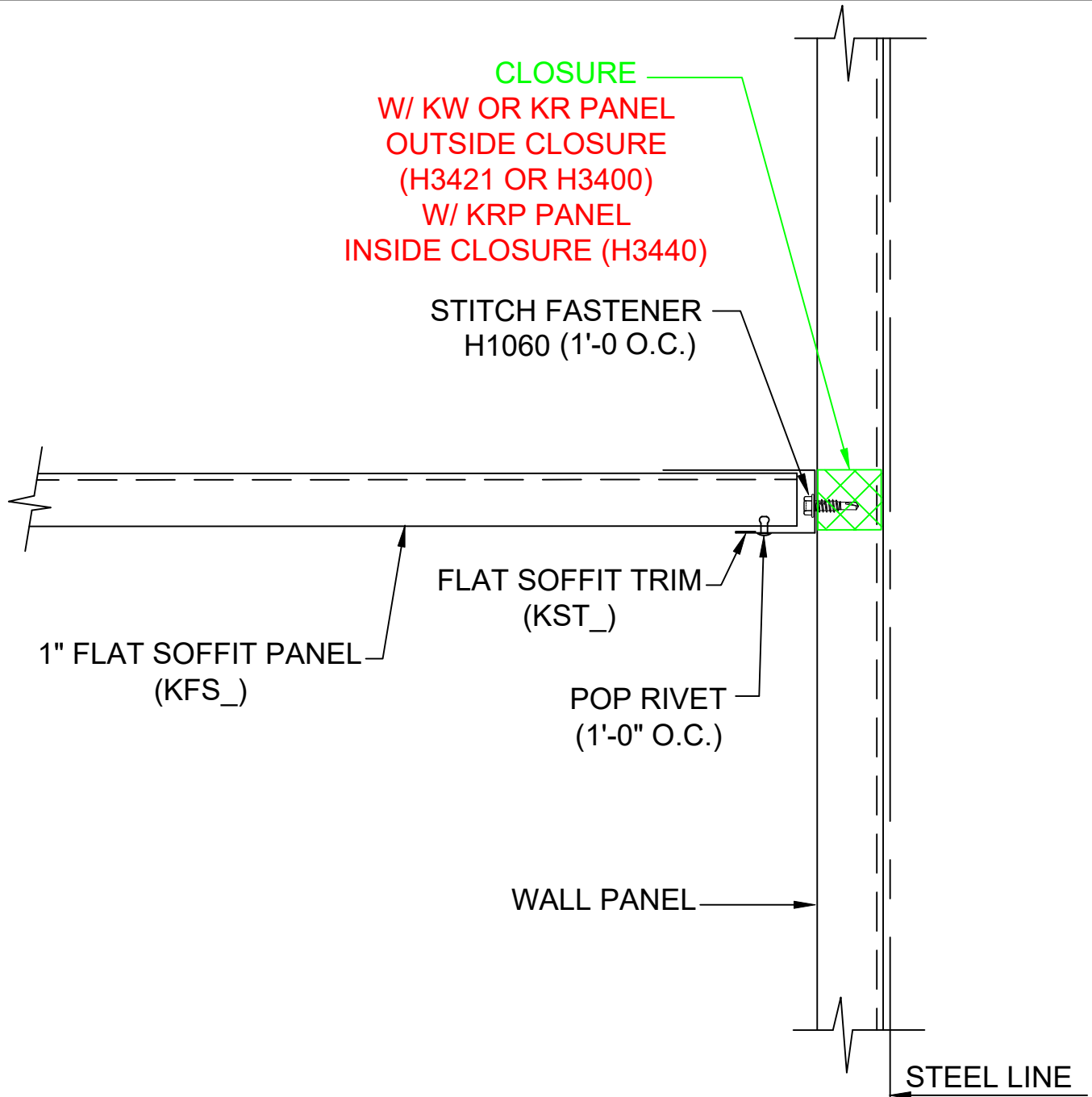

SB0006

HORIZONTAL 1" FLAT SOFFIT PANEL DETAIL
@ SHEETED WALL



KIRBY
BUILDING
SYSTEMS

A NUBOR COMPANY

BETTER SOLUTIONS. BETTER BUILDINGS.

PREPARED BY: IJB

DATE: 4-24-20

SB0006

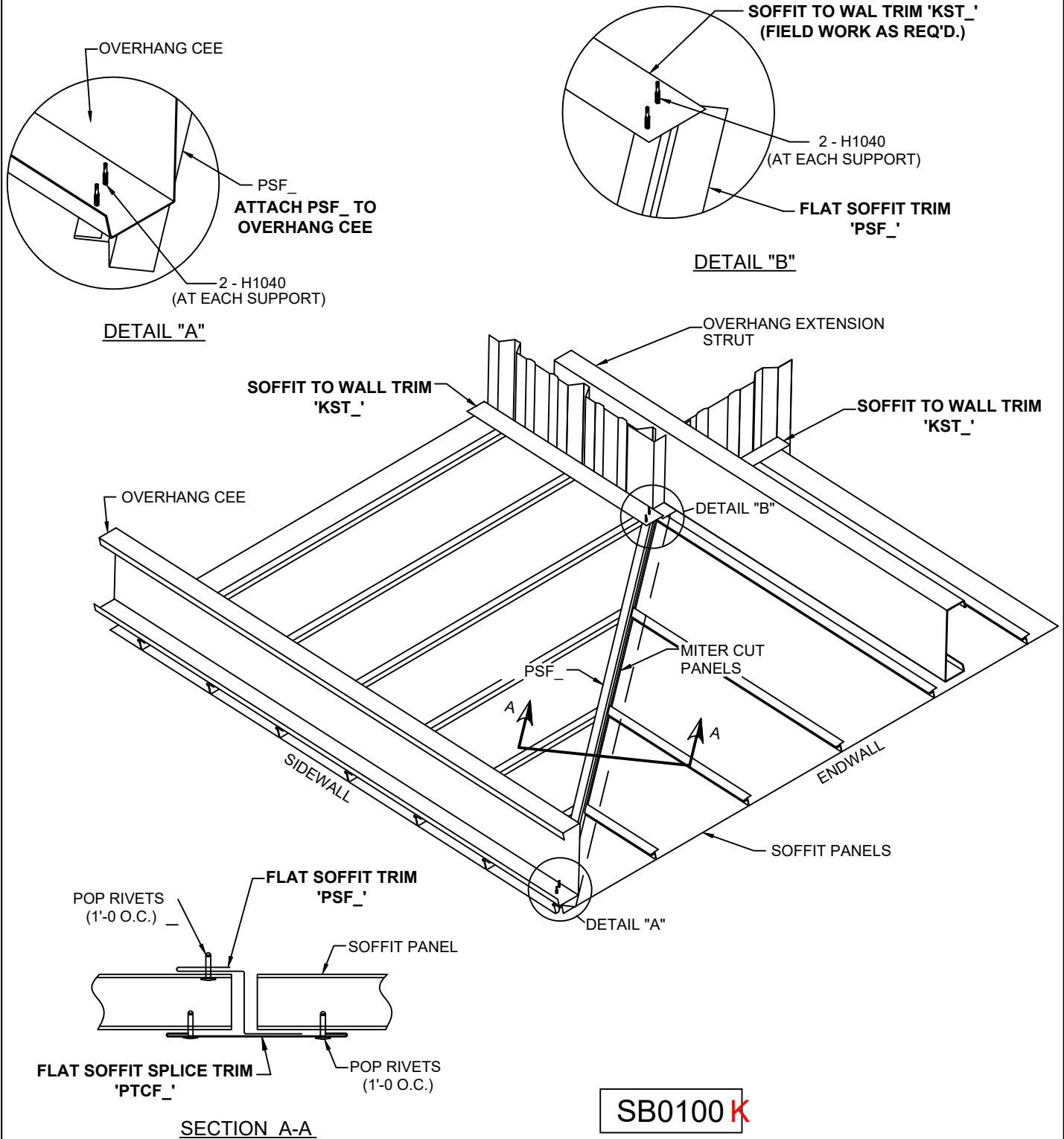

EAVE EXTENSION OR FACADE CORNER DETAIL
WITH PANELS MITERED CUT

DETAIL TO BE USED FOR ALL TYPES ROOF PANELS AND GUTTER TYPES. DETAILER TO SELECT THE DETAIL NEEDED AND DELETE STD SOFFIT ON SELECTED DETAIL AND INSERT THIS BLOCK DETAIL

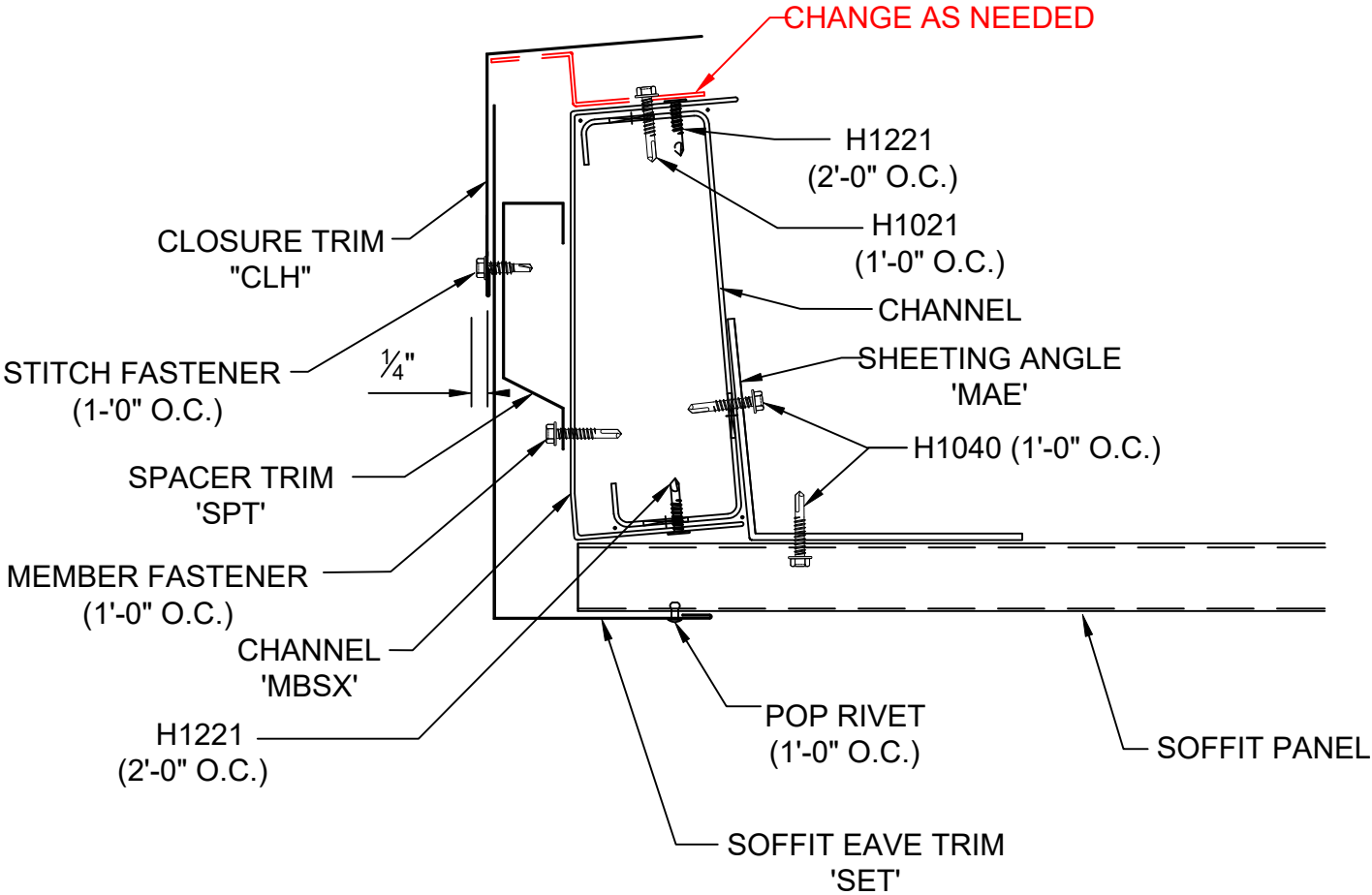

SB0020K

EAVE EXTENSION WITH HORIZONTAL 1" FLAT SOFFIT



KIRBY
BUILDING
SYSTEMS
A NUDOR COMPANY
BETTER SOLUTIONS. BETTER BUILDINGS.

PREPARED BY: IJB

DATE: 8-10-2018

SB0020

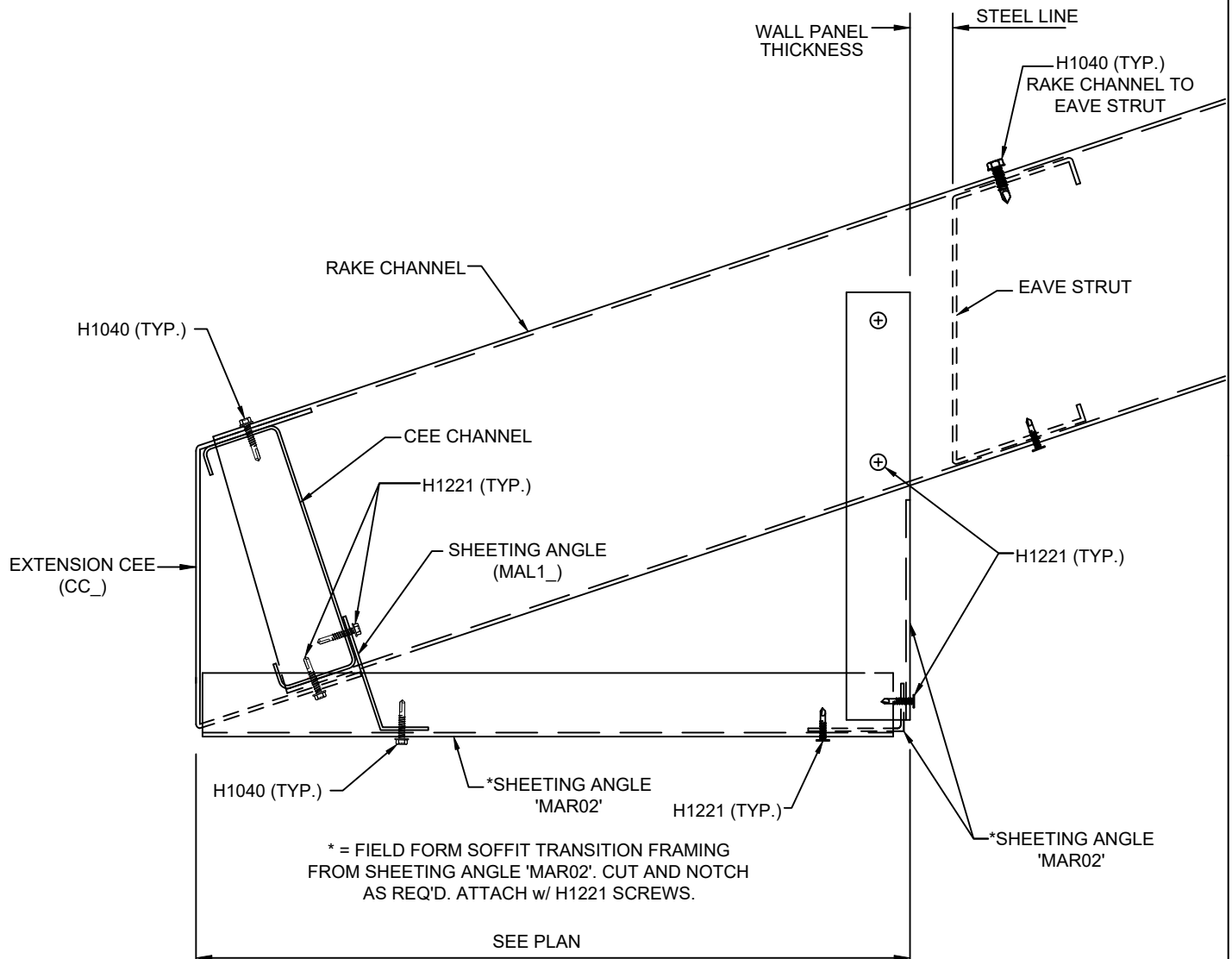

SB0325K

EAVE EXTENSION END FRAMING FOR HORIZONTAL
FLAT SOFFIT AT RAKE TRANSITION
KIRBY
BUILDING
SYSTEMS

A NUCCA COMPANY

BETTER SOLUTIONS. BETTER BUILDINGS.

PREPARED BY: IJB/BKC

DATE: 4-24-20

SB0325

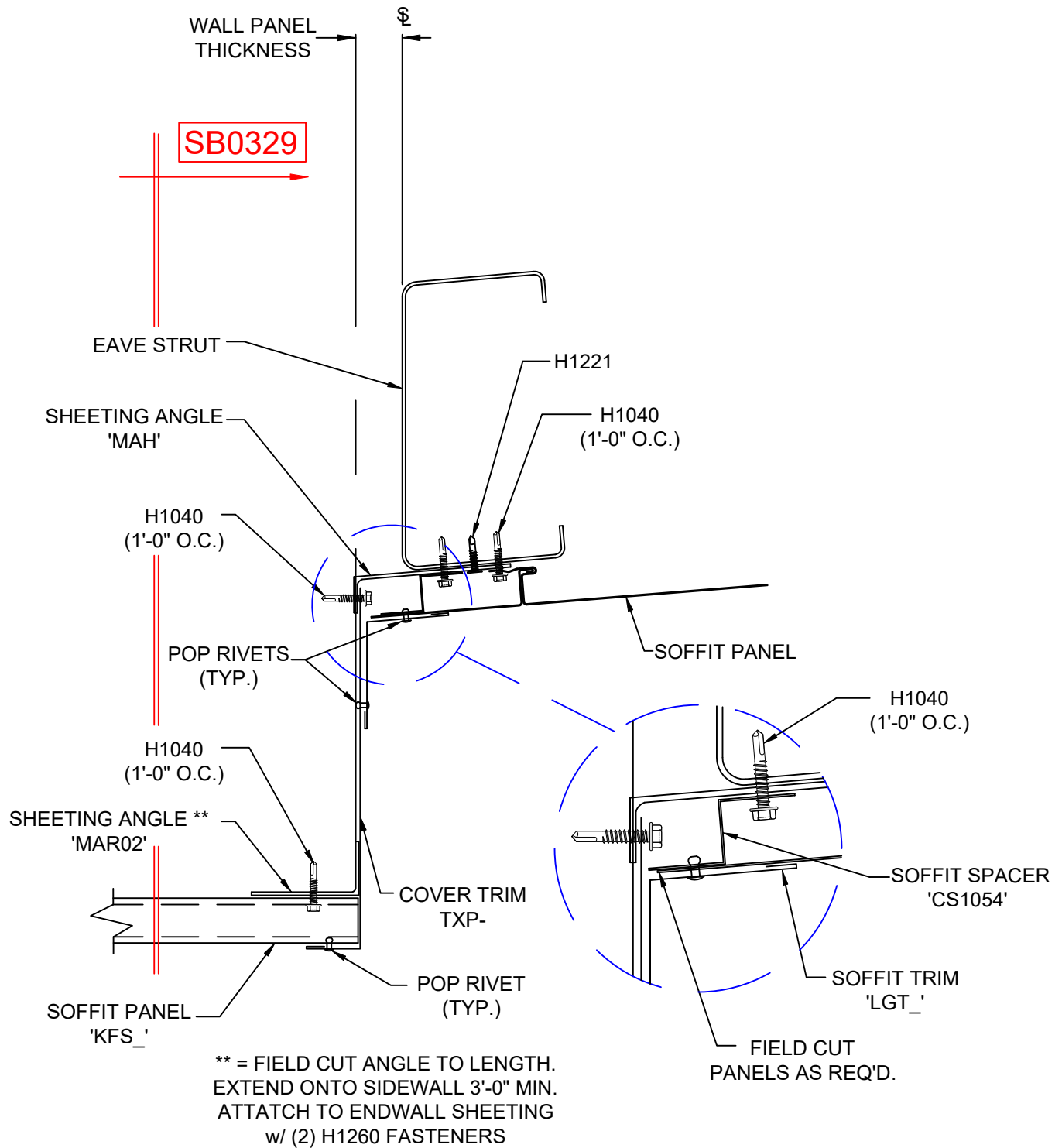

SB0327K

TRIM FOR HORIZONTAL SOFFIT AT END OF
RAKE TRANSITION W/ SOFFIT PERPENDICULAR TO ENDWALL

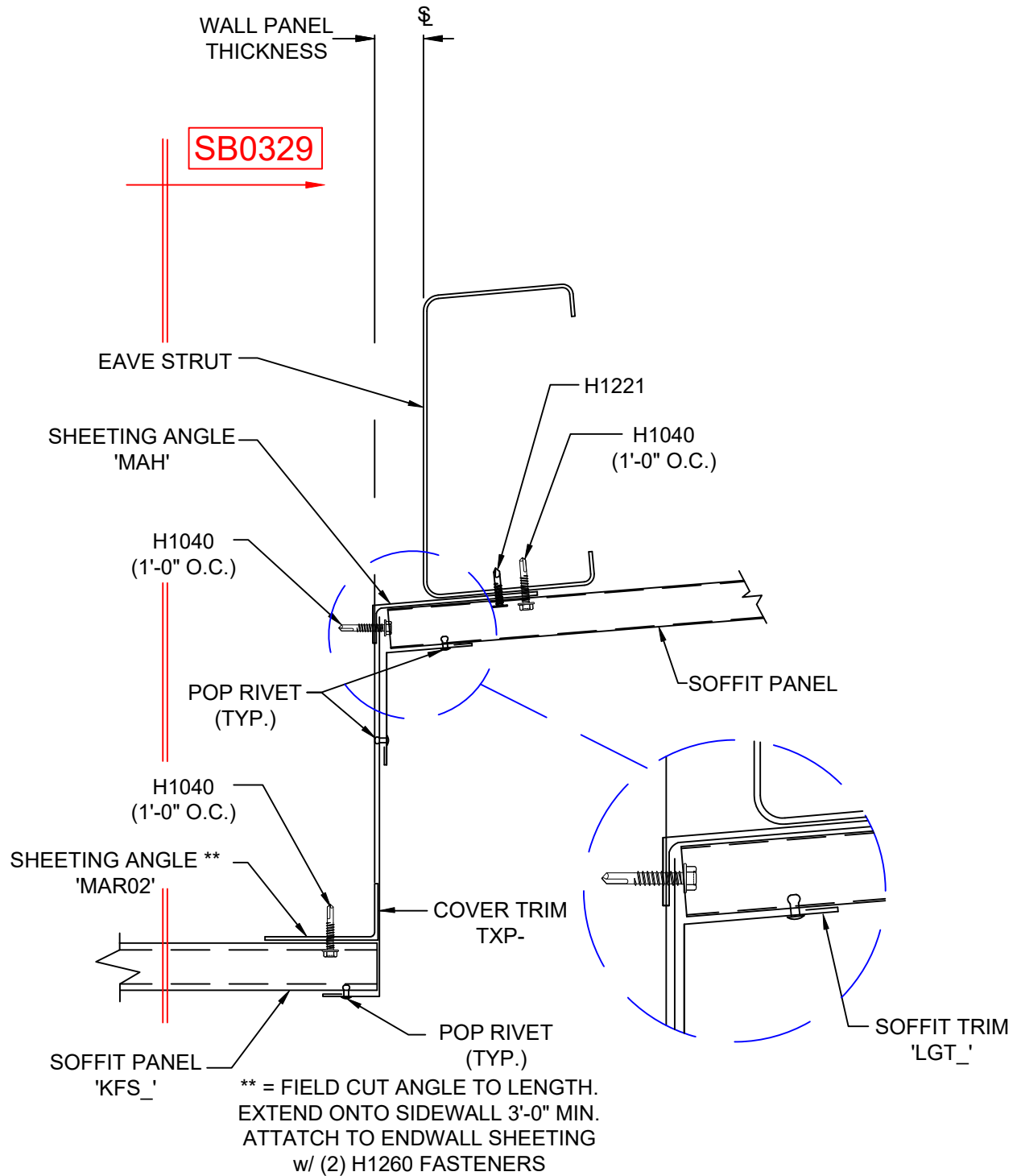

SB0328K

TRIM FOR HORIZONTAL SOFFIT AT END OF
RAKE TRANSITION W/ SOFFIT RUNNING PARALLE TO ENDWALL

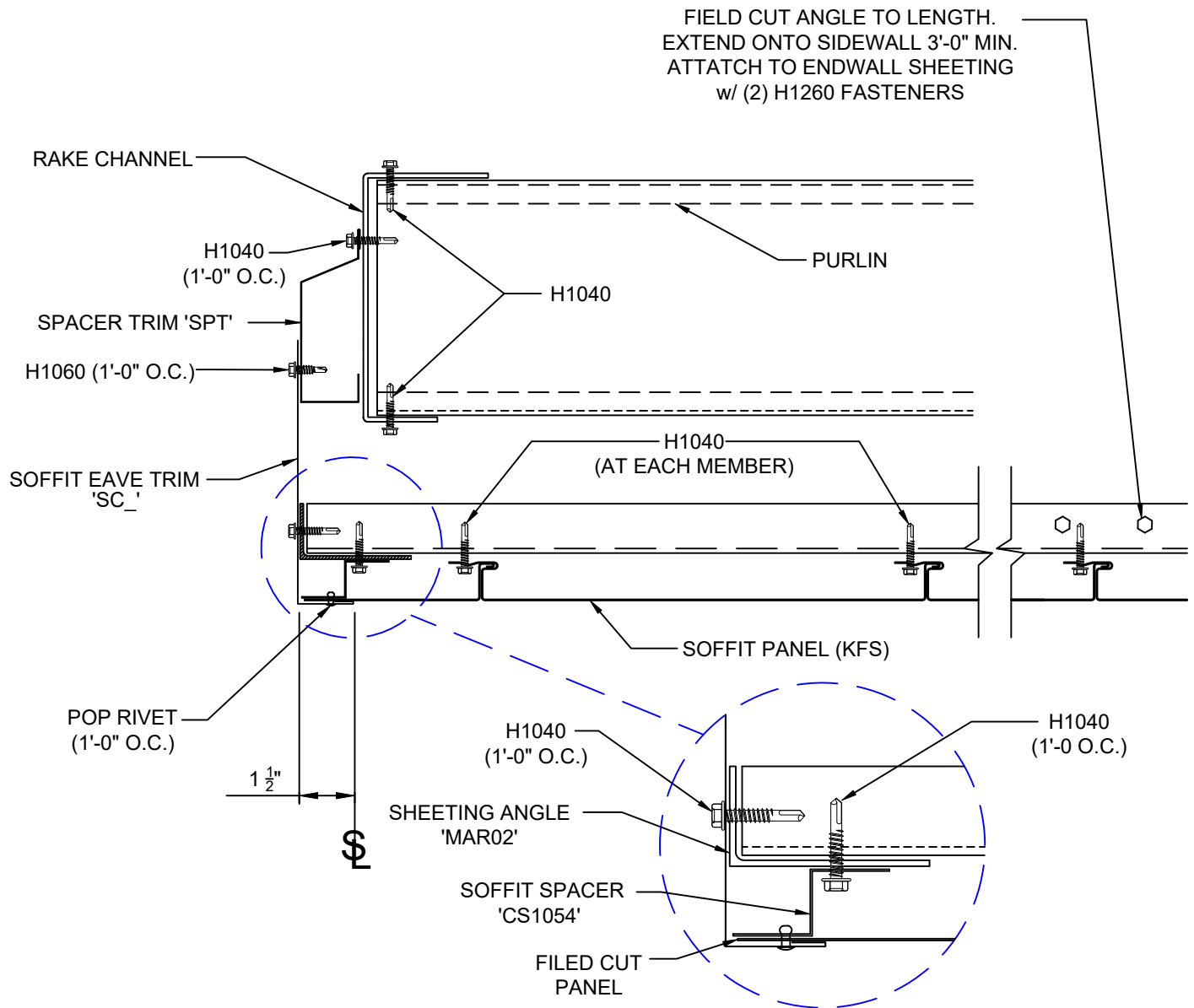

SB0329K

TRIM FOR HORIZONTAL SOFFIT AT RAKE TRANSITION
VIEWED THRU EAVE CANOPY
REFERENCE SB0327 OR SB0328