

KR2 Corner Details

- IA0201 - Flush/Inset Rigid Frame Corner
- IA0202 - By-Frame Rigid Frame Corner
- IA0203 - Flush/Inset P&B EW w/ Rotated Corner Col.
- IA0204 - By-Frame P&B EW w/ Rotated Corner Col.
- IA0206 - Flush P&B EW "I" Col. In Girt Line Corner
- IA1206 - Flush P&B EW CEE Col. In Girt Line Corner
- IA0207 - Flush/Inset P&B EW "I" Col. Outside Girt Line Corner
- IA1207 - Flush/Inset P&B EW CEE Col. In Pnl. Line Corner
- IA2207 - Flush/Inset P&B EW CEE Col. Outside Girt Line Corner
- IA0208 - By-Frame P&B EW Corner

KR2 Wall Column Details

- IA0210 - Flush/Inset "I" Column in Girt Line
- IA0211 - Flush/Inset "I" Column in Panel Line
- IA0212 - Flush/Inset "I" Column Outside Girt Line
- IA0220 - By-Frame "I" Column
- IA0230 - Flush/Inset CEE Col. in Girt Line
- IA0231 - Flush/Inset CEE Col. in Panel Line
- IA0232 - Flush/Inset CEE Col. Outside Girt Line
- IA0234 - Flush/ Inset CEE Col Girt Depth > Col Depth
- IA0240 - By-Frame CEE Column

KRP/LNR Corner Details

- IA0301 - Flush/Inset Rigid Frame Corner
- IA0302 - By-Frame Rigid Frame Corner
- IA0303 - Flush/Inset P&B EW w/ Rotated Corner Col.
- IA0304 - By-Frame P&B EW w/ Rotated Corner Col.
- IA0306 - Flush P&B EW "I" Col. In Girt Line Corner
- IA1306 - Flush P&B EW CEE Col. In Girt Line Corner
- IA0307 - Flush/Inset P&B EW "I" Col. Outside Girt Line Corner
- IA1307 - Flush/Inset P&B EW CEE Col. In Pnl. Line Corner
- IA2307 - Flush/Inset P&B EW CEE Col. Outside Girt Line Corner
- IA0308 - By-Frame P&B EW Corner

KRP/LNR Wall Column Details

- IA0310 - Flush/Inset "I" Column in Girt Line
 - IA0311 - Flush/Inset "I" Column in Panel Line
 - IA0312 - Flush/Inset "I" Column Outside Girt Line
 - IA0320 - By-Frame "I" Column
-

IA0330 - Flush/Inset CEE Col. in Girt Line

IA0331 - Flush/Inset CEE Col. in Panel Line

IA0332 - Flush/Inset CEE Col. Outside Girt Line

IA0334 - Flush/ Inset CEE Col Girt Depth > Col Depth

IA0340 - By-Frame CEE Column

Interior Ceiling Liner Details

IA0080 - Lap Detail

IA0100 - KW Liner at Int. Rafters

IA0200 - KR2 Liner at Int. Rafters

IA0300 - KRP/LNR at Int. Rafters

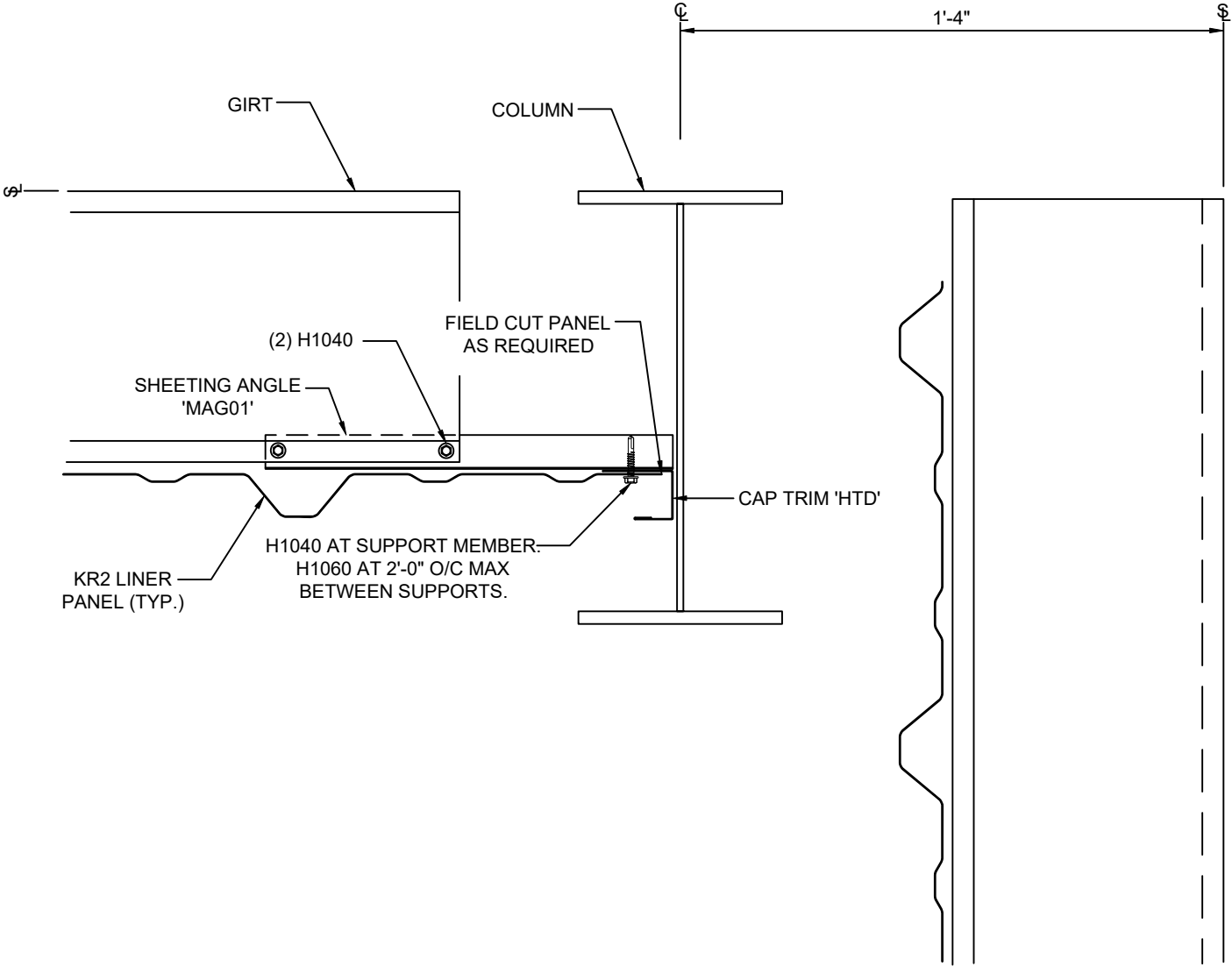

IA0201K

KR2 LINER PANEL AT RF COLUMN FLUSH CORNER

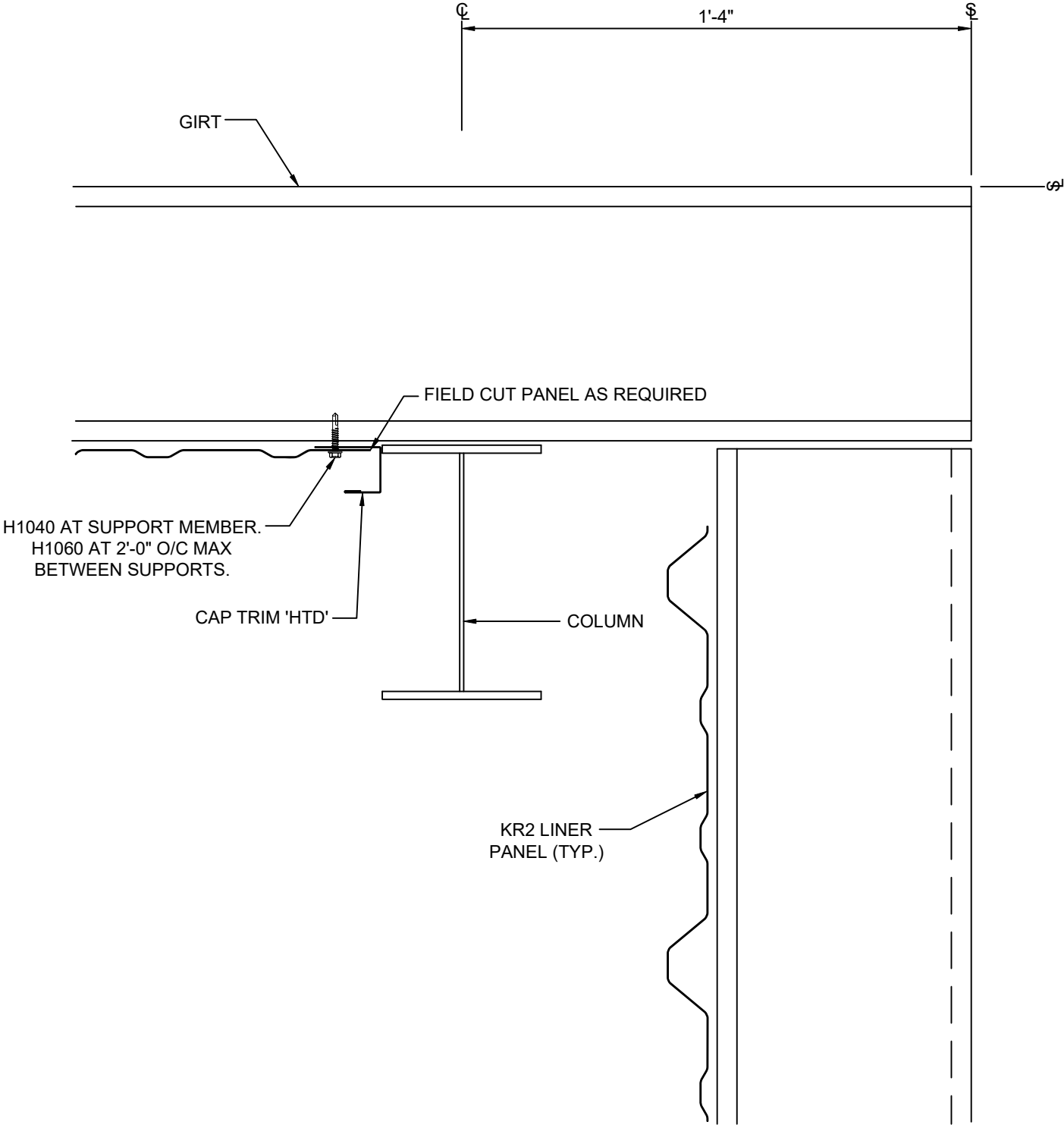

IA0202K

KR2 LINER PANEL AT RF COLUMN BYFRAME CORNER

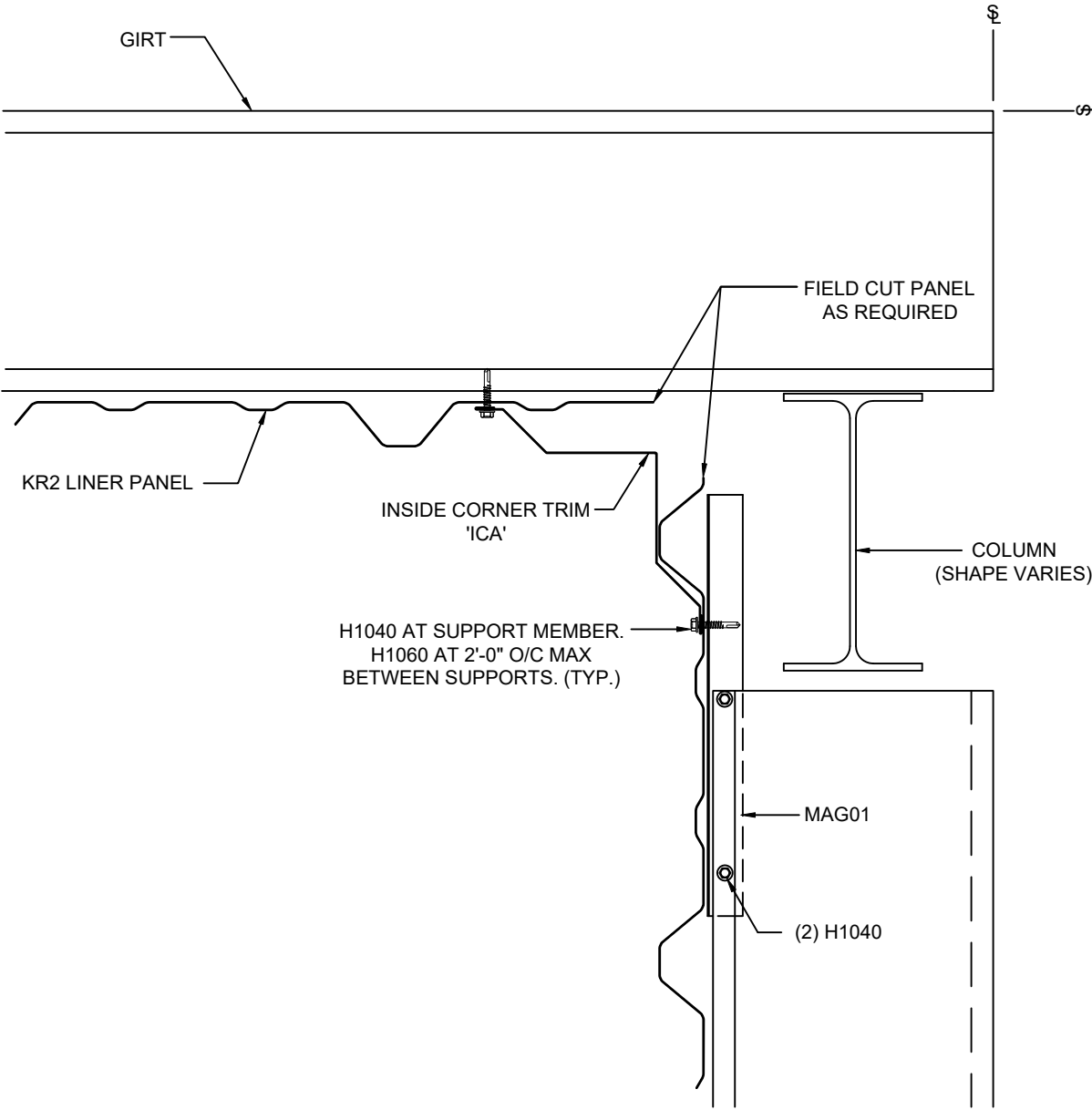

IA0203K

KR2 LINER PANEL AT CORNER w/ FLUSH/INSET POST AND BEAM
ENDWALL AND ROTATED CORNER COLUMN



KIRBY
BUILDING
SYSTEMS

A NUDOR COMPANY

BETTER SOLUTIONS. BETTER BUILDINGS.

PREPARED BY: BKC

DATE: 4-22-20

IA0203

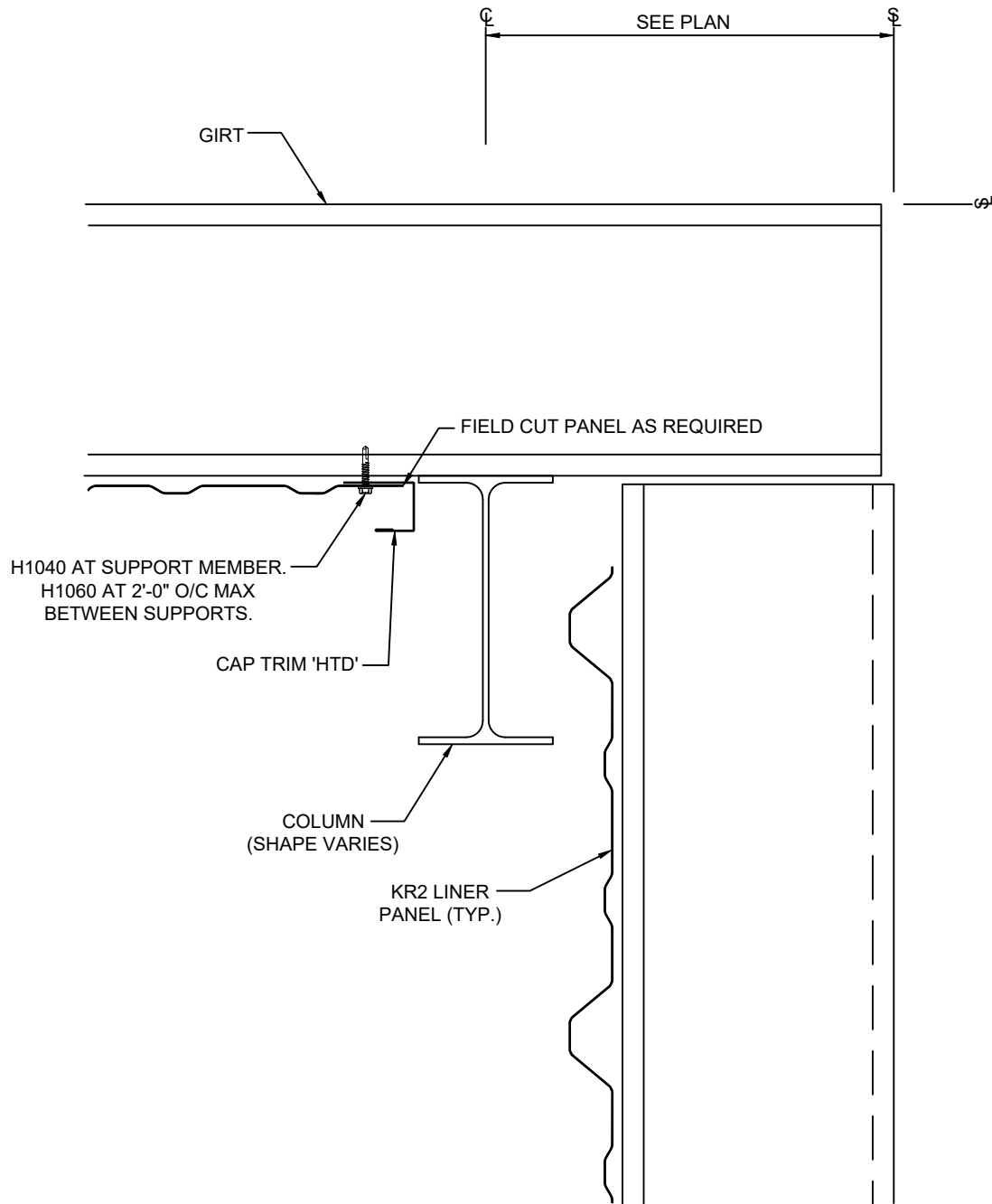

IA0204K

KR2 LINER PANEL AT CORNER w/ BY-FRAME POST AND BEAM
ENDWALL AND ROTATED CORNER COLUMN



KIRBY
BUILDING
SYSTEMS

A NUDOR COMPANY

BETTER SOLUTIONS. BETTER BUILDINGS.

PREPARED BY: BKC

DATE: 4-22-20

IA0204

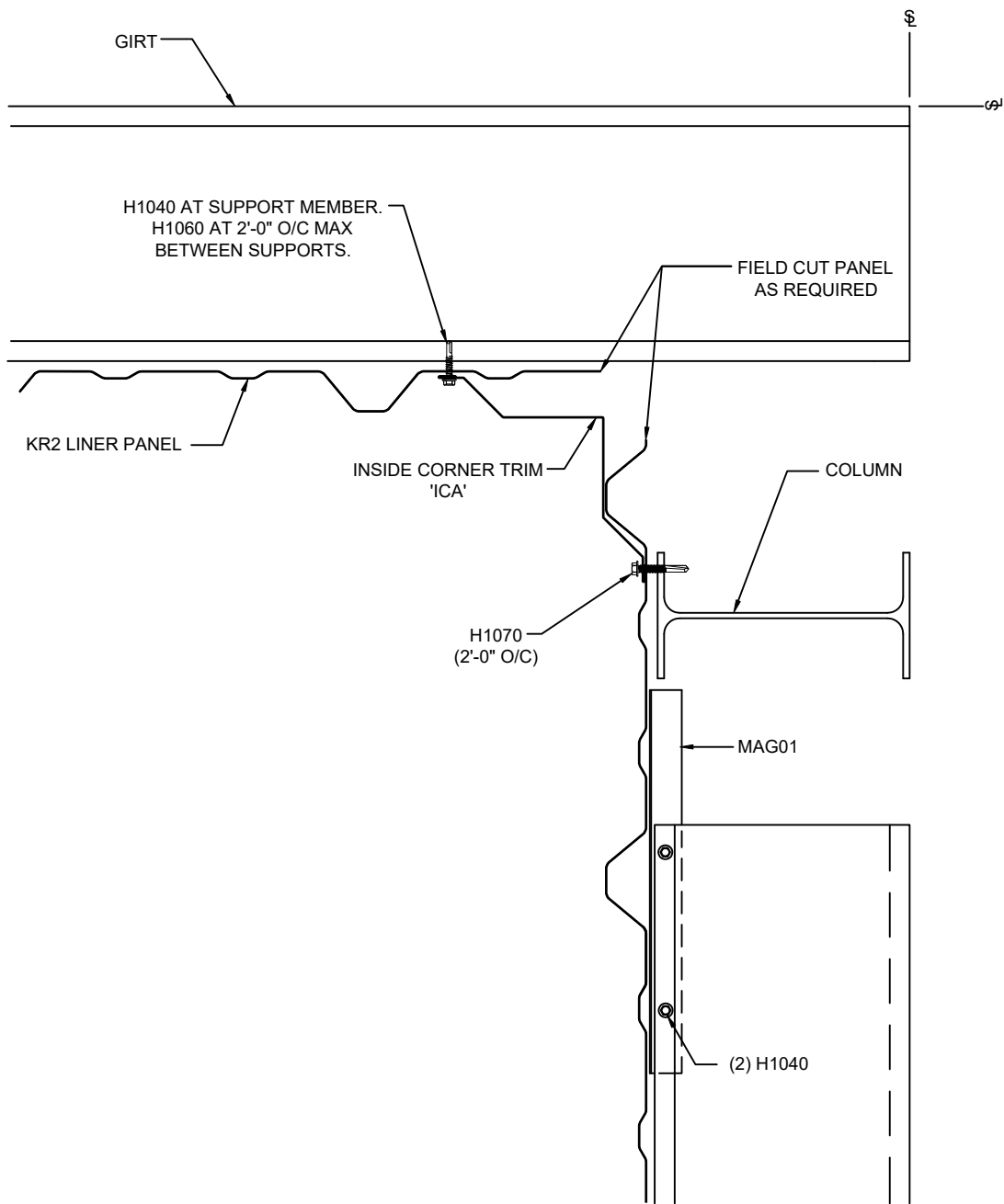

IA0206K

KR2 LINER PANEL AT CORNER w/ FLUSH POST AND BEAM
ENDWALL AND "I" COLUMN WITHIN GIRT LINE

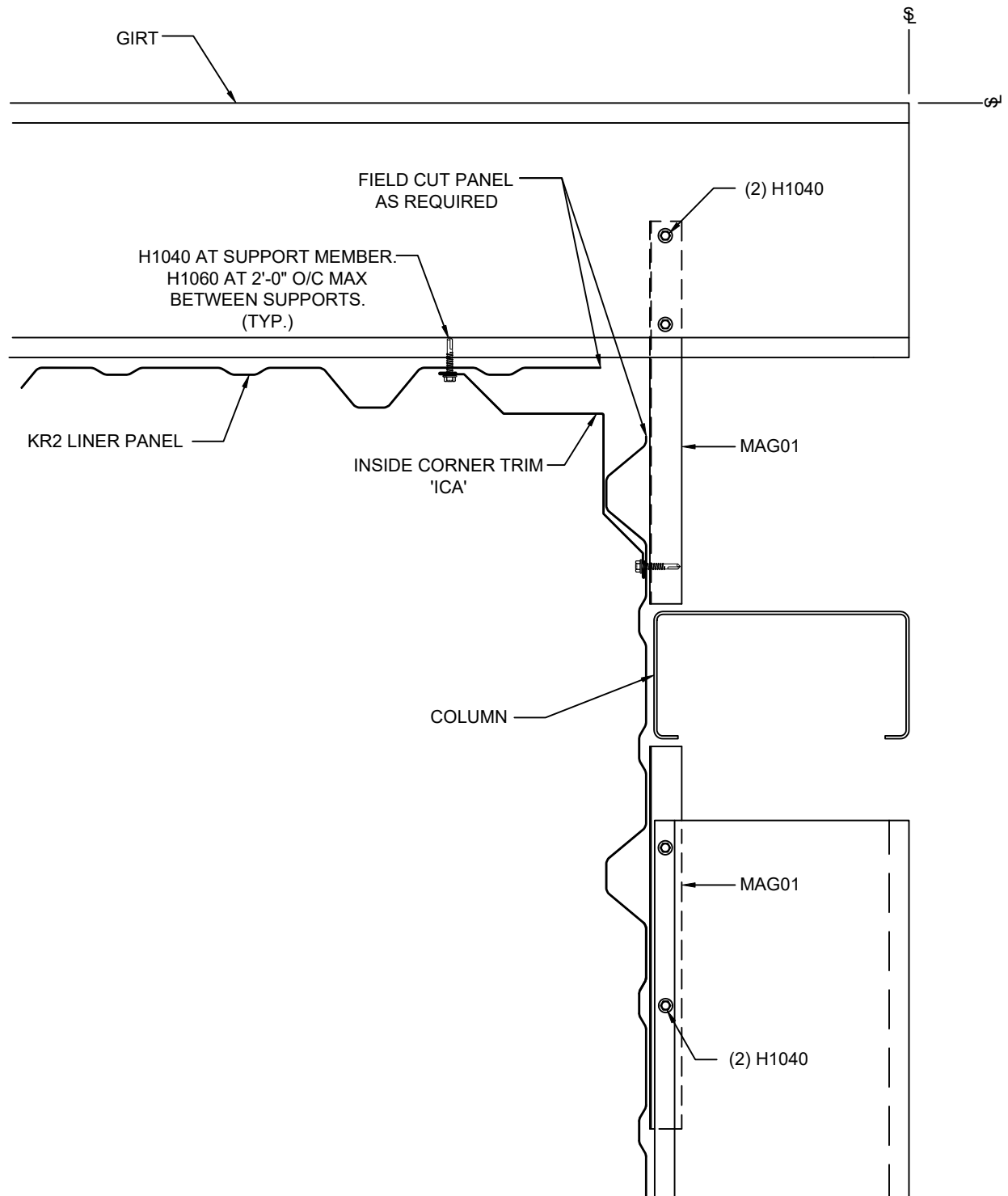

IA1206K

KR2 LINER PANEL AT CORNER w/ FLUSH POST AND BEAM
ENDWALL AND CEE COLUMN WITHIN GIRT LINE

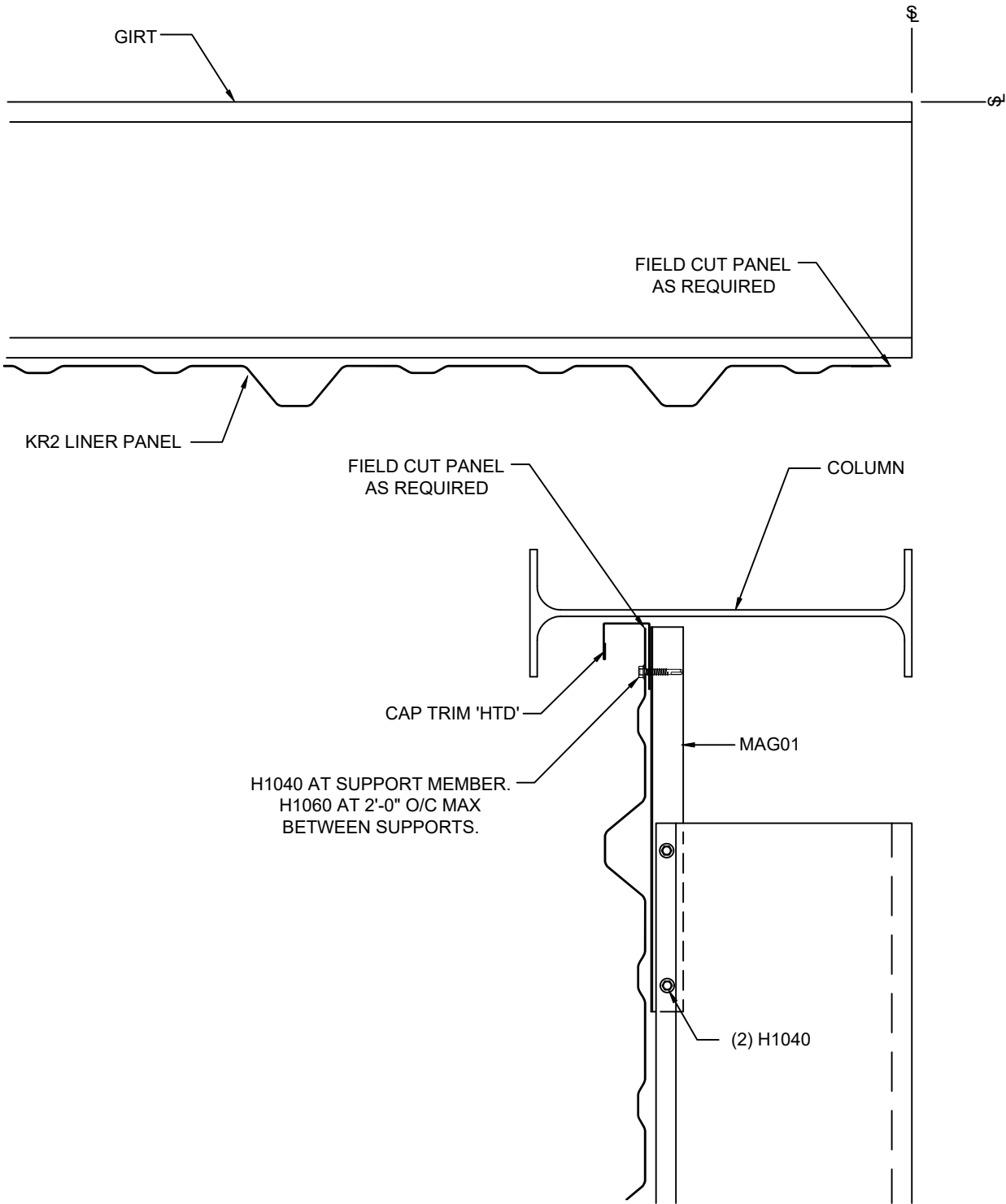

IA0207K

KR2 LINER PANEL AT CORNER w/ FLUSH/INSET POST AND BEAM
ENDWALL AND "I" COLUMN OUTSIDE GIRT LINE

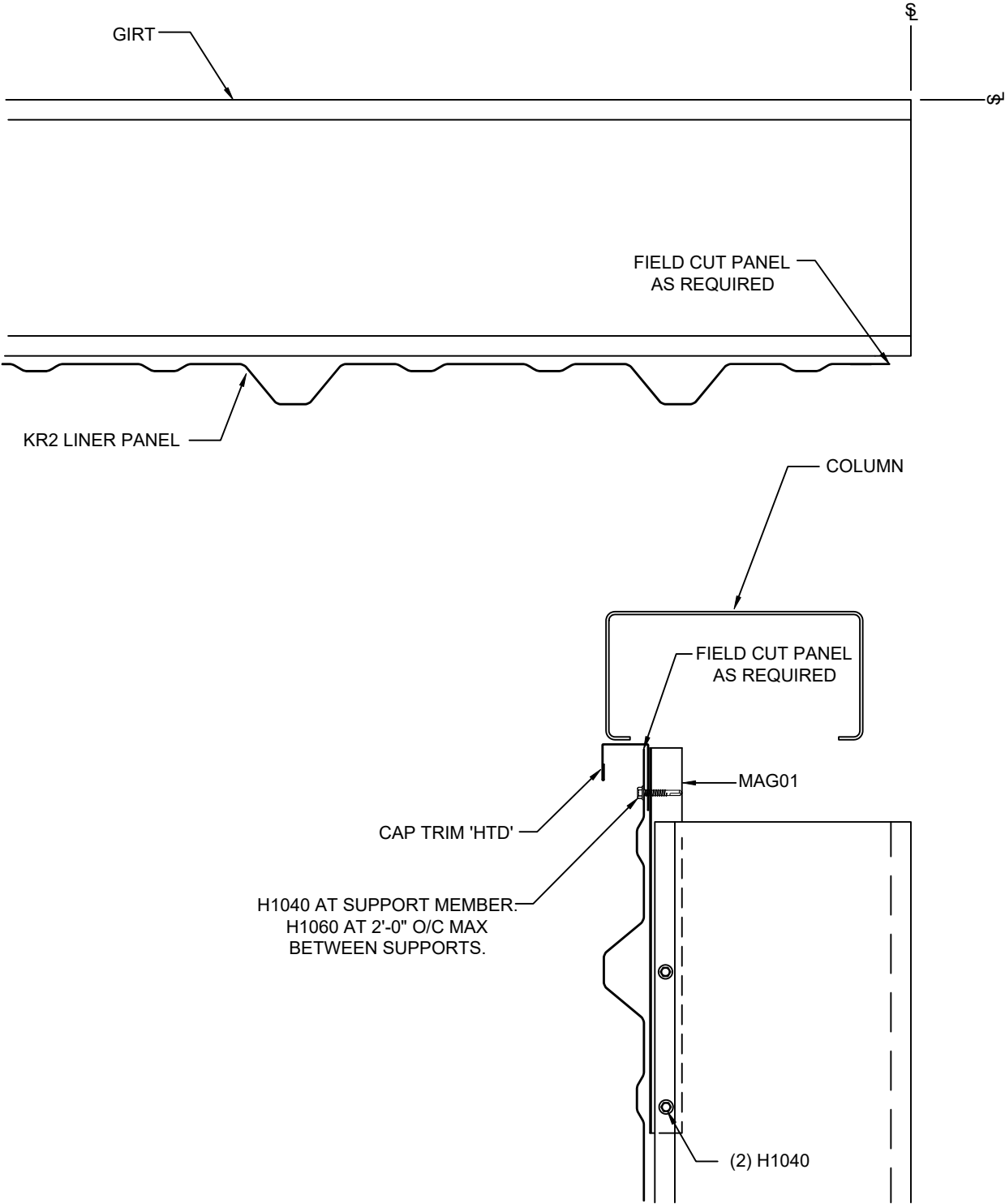

IA1207K

KR2 LINER PANEL AT CORNER w/ FLUSH/INSET POST AND BEAM
ENDWALL AND CEE COLUMN IN PANEL LINE

CED MANUAL

SECTION: **IA**

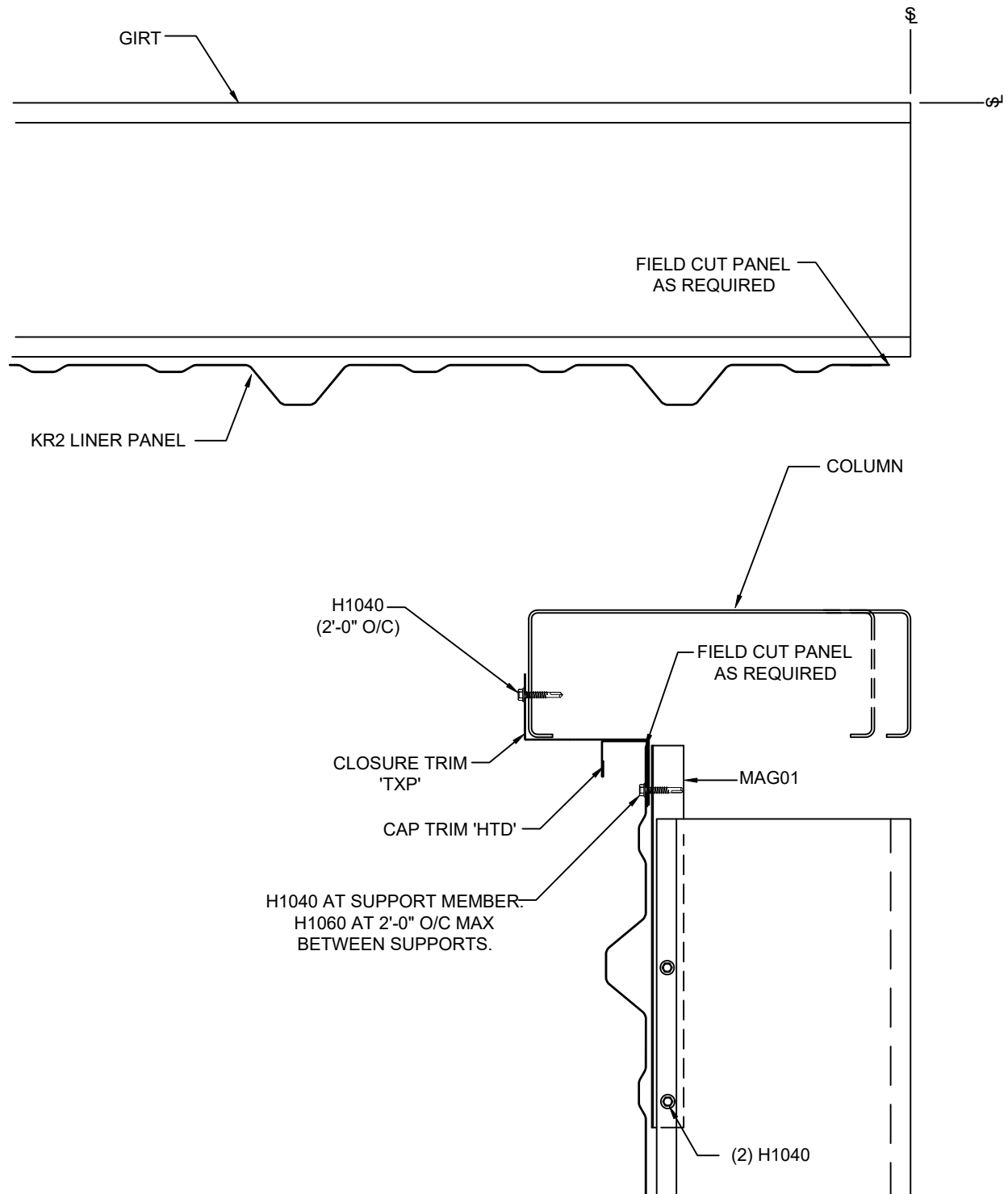

IA2207K

**KR2 LINER PANEL AT CORNER w/ FLUSH/INSET POST AND BEAM
ENDWALL AND CEE COLUMN OUTSIDE GIRT LINE**

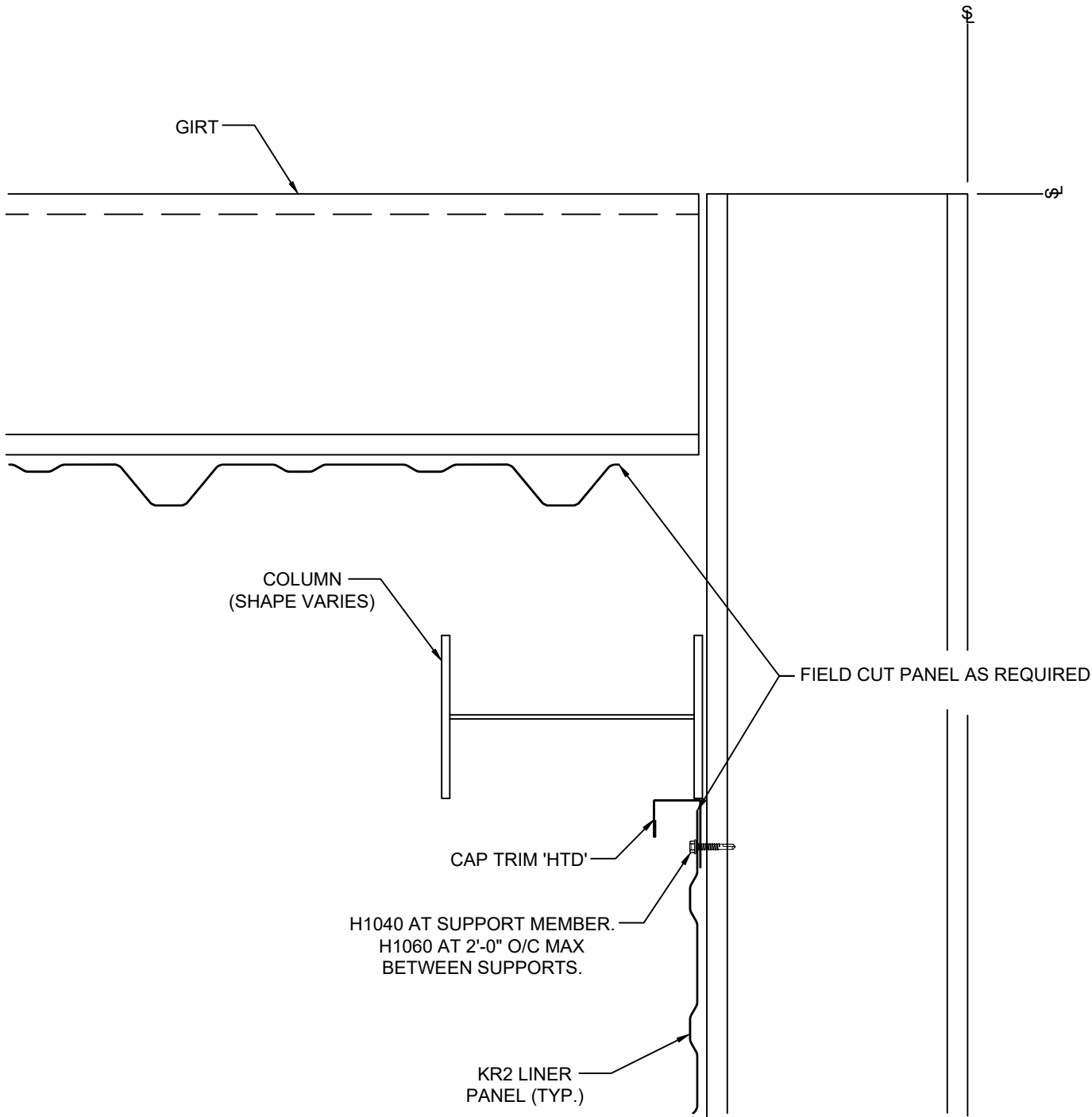

IA0208K

KR2 LINER PANEL AT CORNER w/ BY-FRAME POST AND BEAM

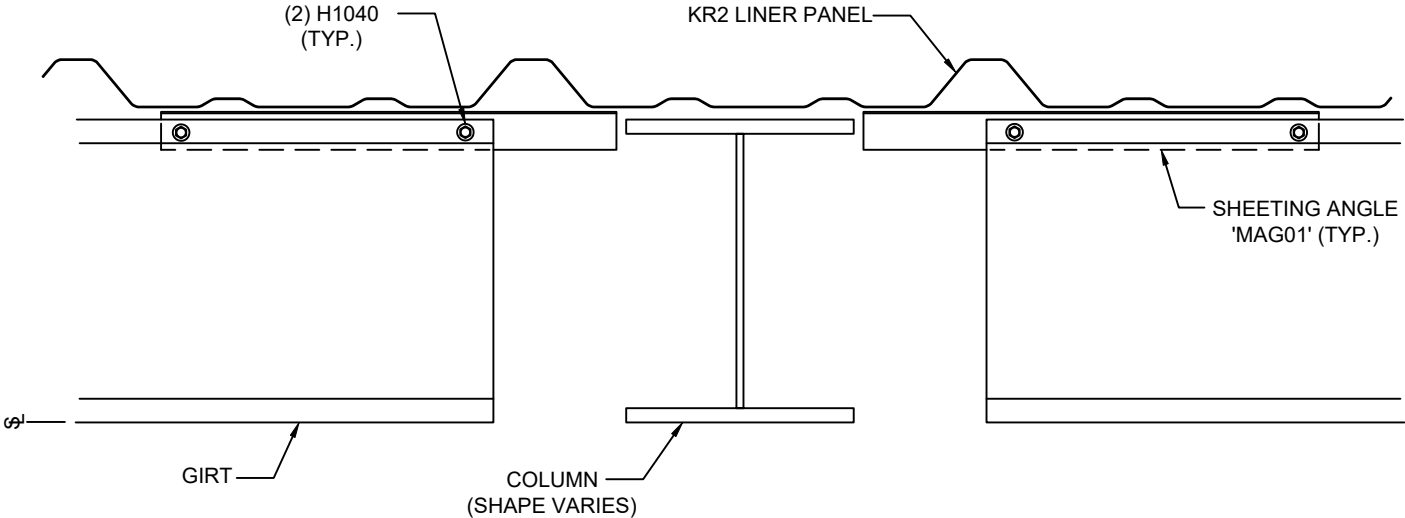

IA0210K

KR2 LINER PANEL AT SIDEWALL
FLUSH COLUMN, COLUMN IN GIRT LINE

ERECTOR NOTE:
FOR INSET CONDITIONS,
FIELD CUT SLIT IN TRIM
& PANEL FOR CLIP

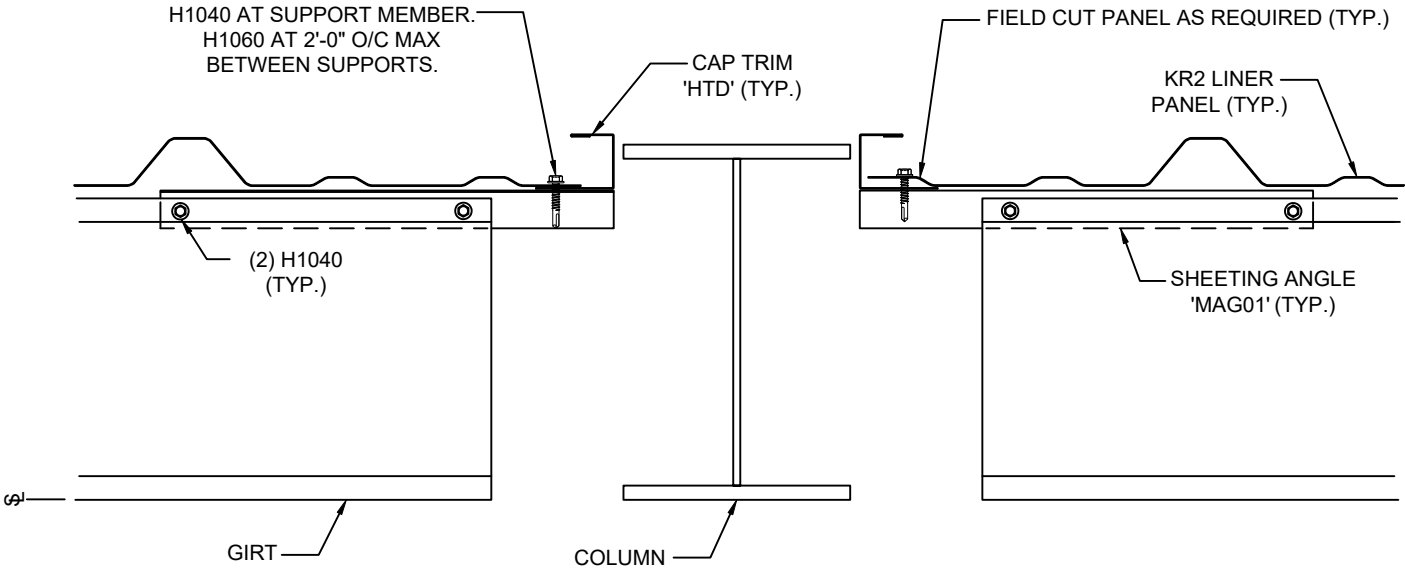

IA0211K

KR2 LINER PANEL AT SIDEWALL FLUSH/INSET COLUMN,
COLUMN FLANGE OUTSIDE GIRT LINE

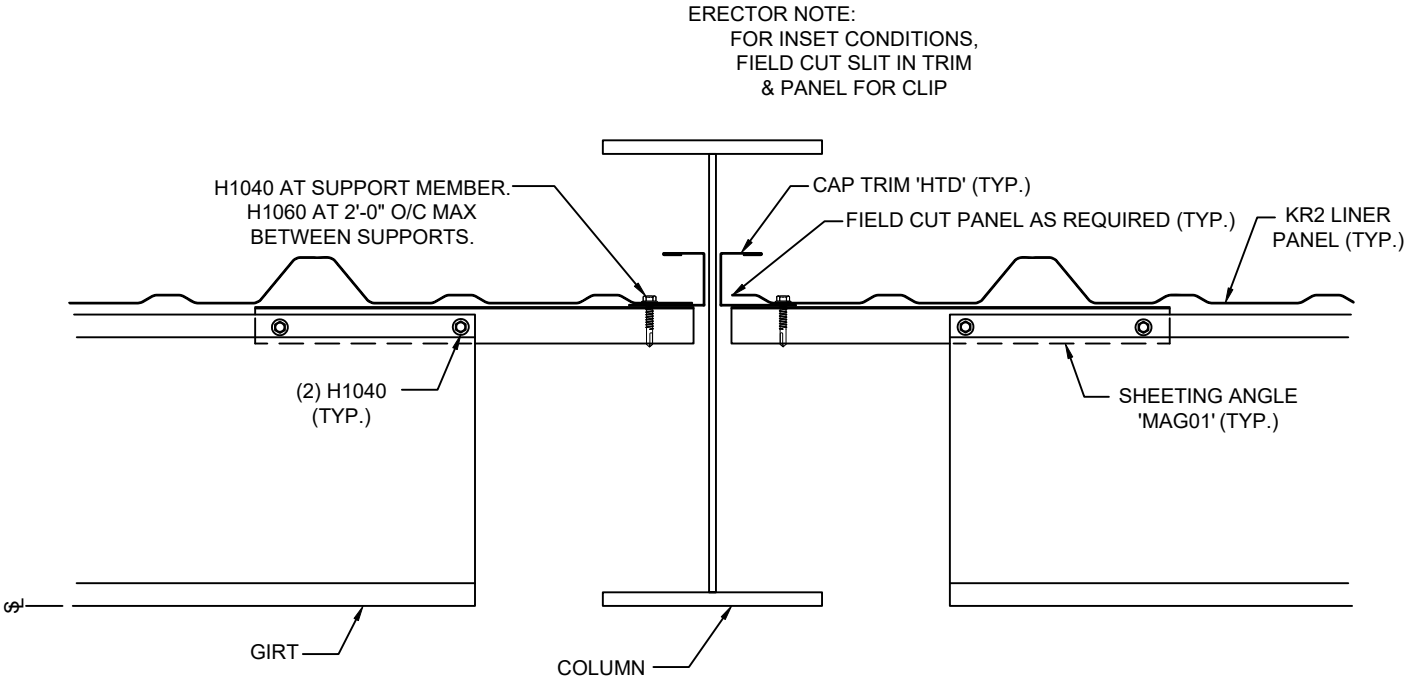

IA0212K

KR2 LINER PANEL AT SIDEWALL FLUSH/INSET COLUMN,
COLUMN OUTSIDE GIRT LINE

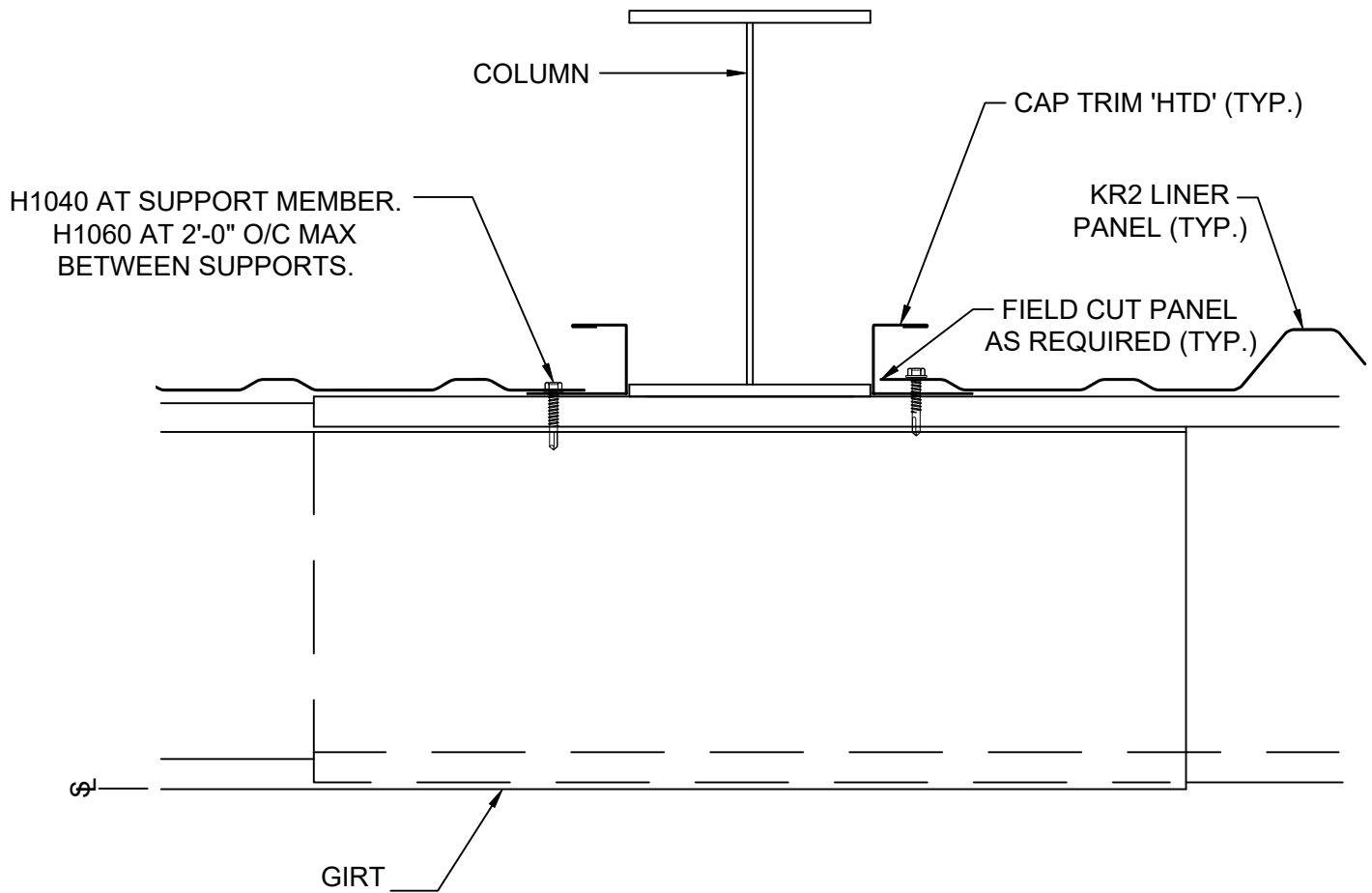

IA0220K

KR2 LINER AT COLUMN w/ BY-FRAME GIRT

**KIRBY**
BUILDING
SYSTEMS

A NUDOR COMPANY

BETTER SOLUTIONS. BETTER BUILDINGS.

PREPARED BY: BKC

DATE: 4-22-20

IA0220

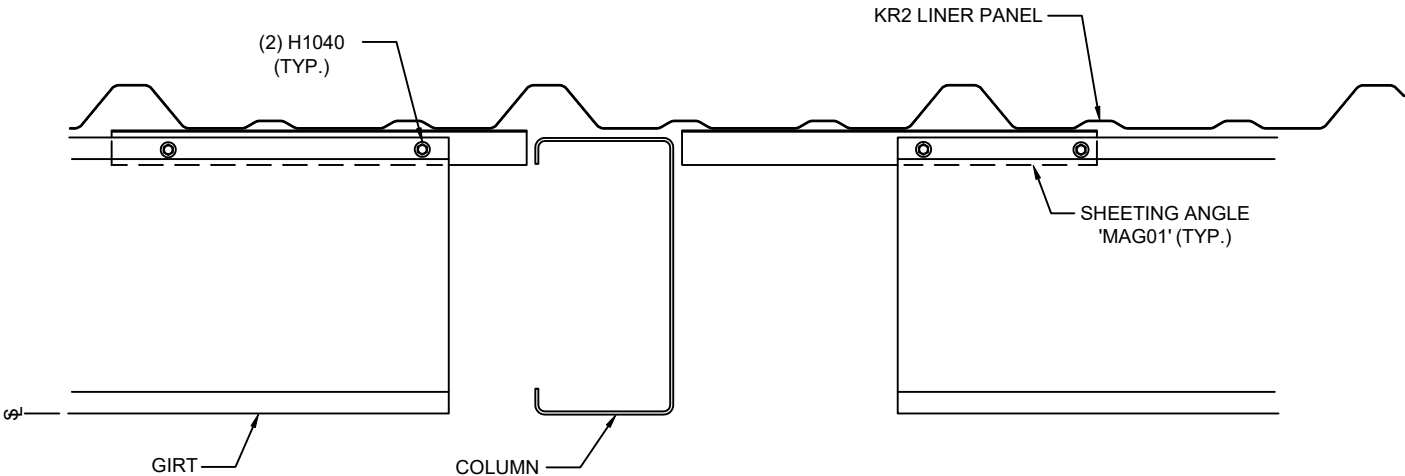

IA0230K

KR2 LINER AT FLUSH "CEE" COLUMN

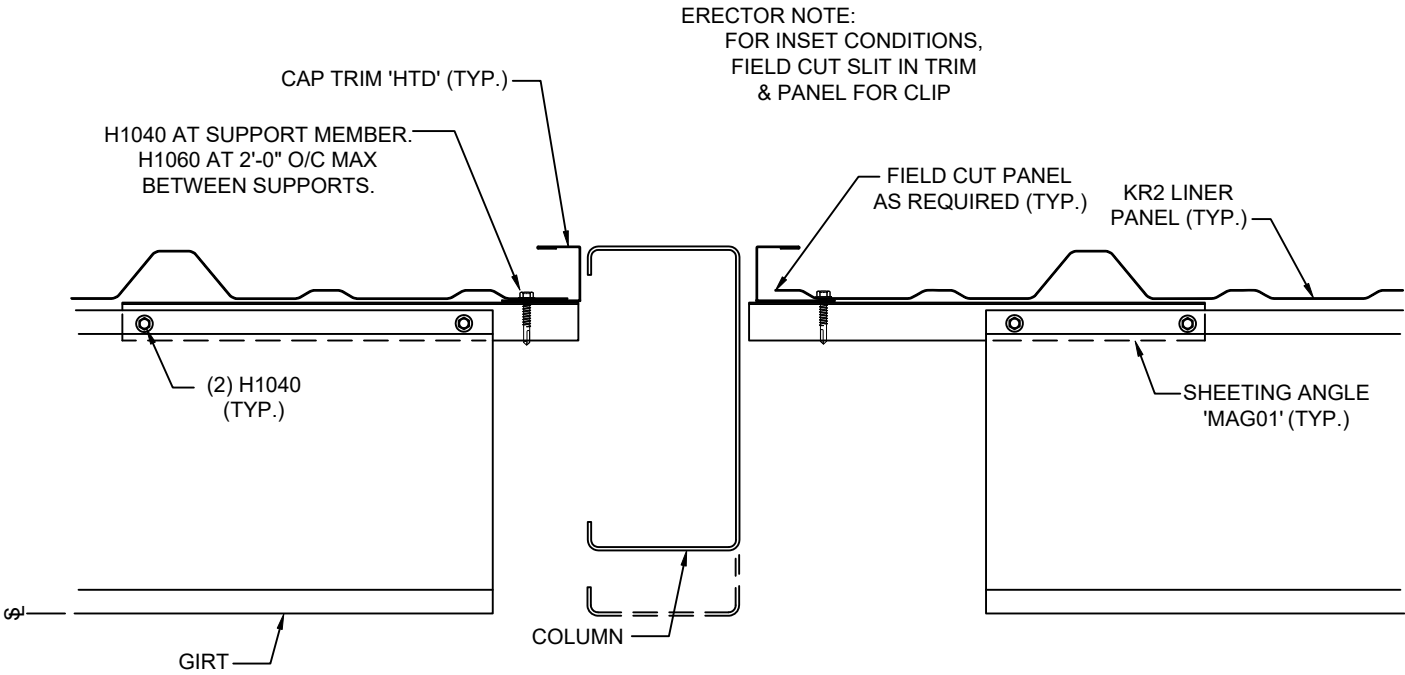

IA0231K

KR2 LINER PANEL AT FLUSH/INSET "CEE" COLUMN
w/COL. FLANGE IN PANEL LINE

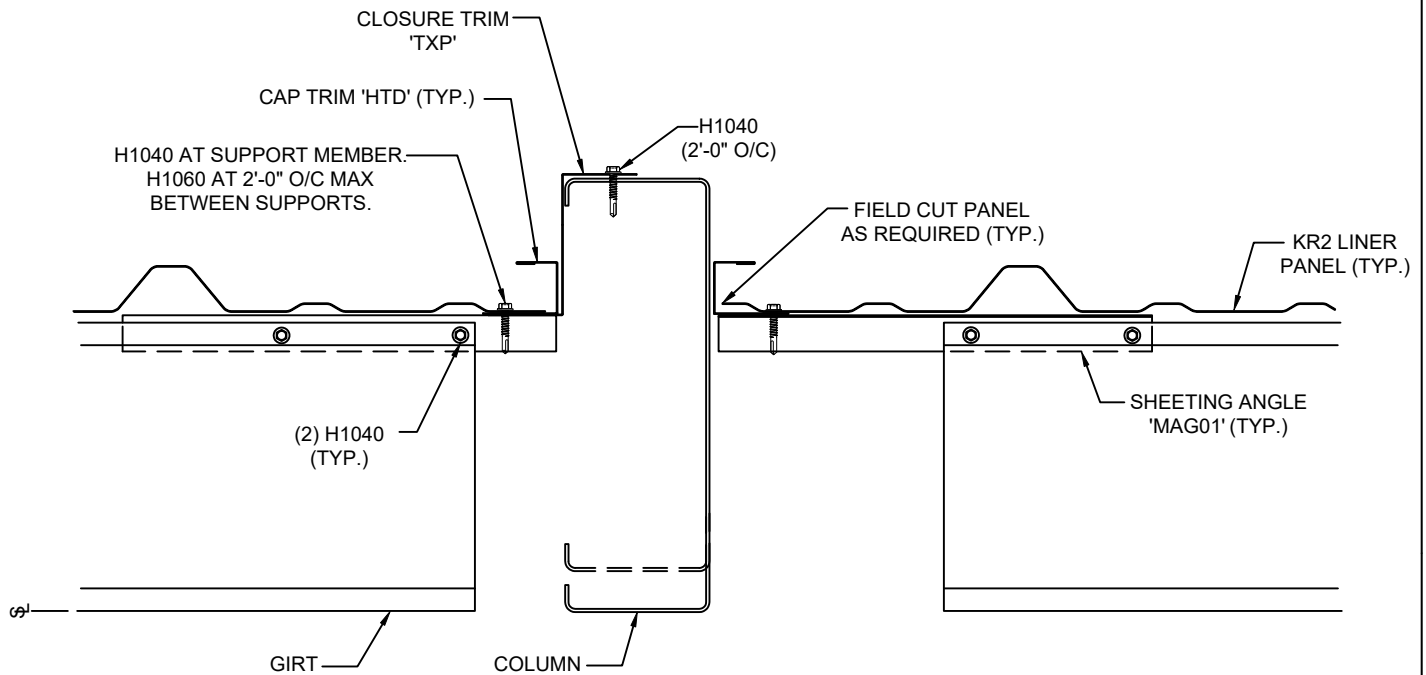

IA0232K

KR2 LINER PANEL AT FLUSH/INSET "CEE" COLUMN
w/COL. OUTSIDE GIRT LINE

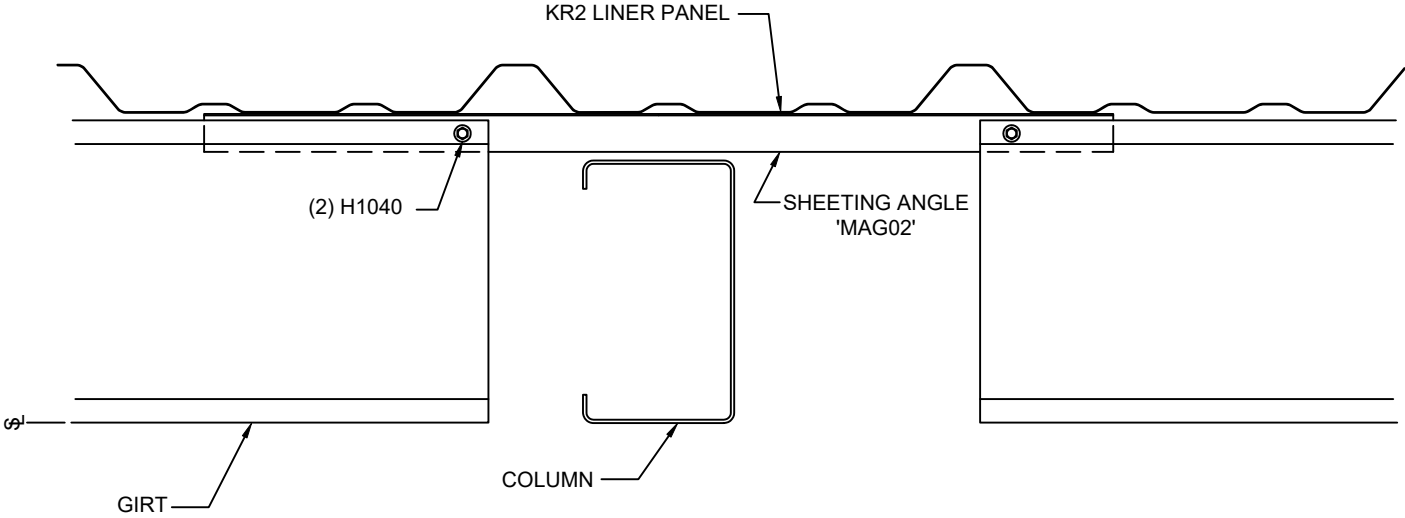

IA0234K

KR2 LINER AT FLUSH "CEE" COLUMN
GIRT DEPTH > COL DEPTH

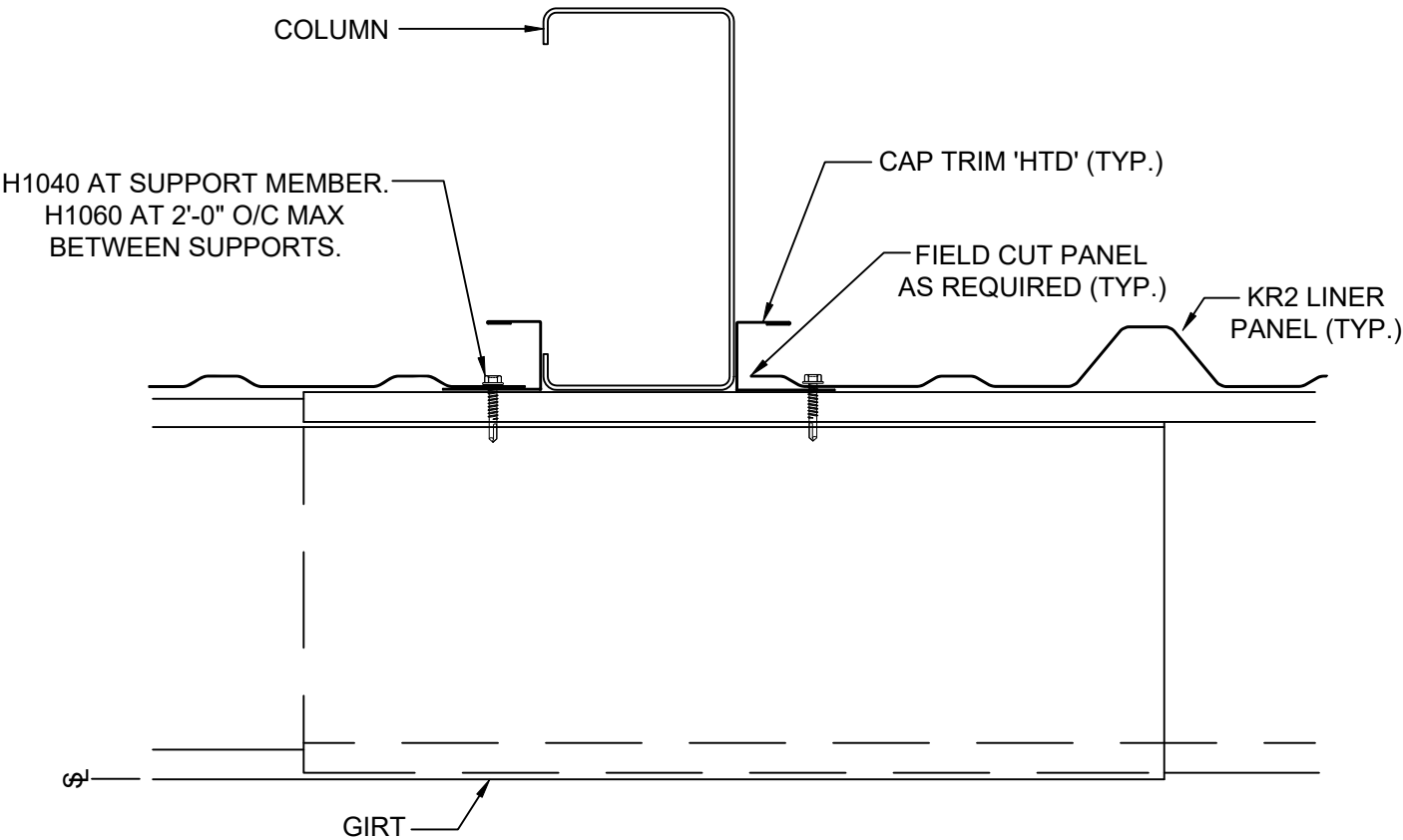

IA0240K

KR2 LINER AT BY-FRAME CEE COLUMN GIRT TERMINATION



KIRBY
BUILDING
SYSTEMS

A NUCCA COMPANY

BETTER SOLUTIONS. BETTER BUILDINGS.

PREPARED BY: BKC

DATE: 4-22-20

IA0240

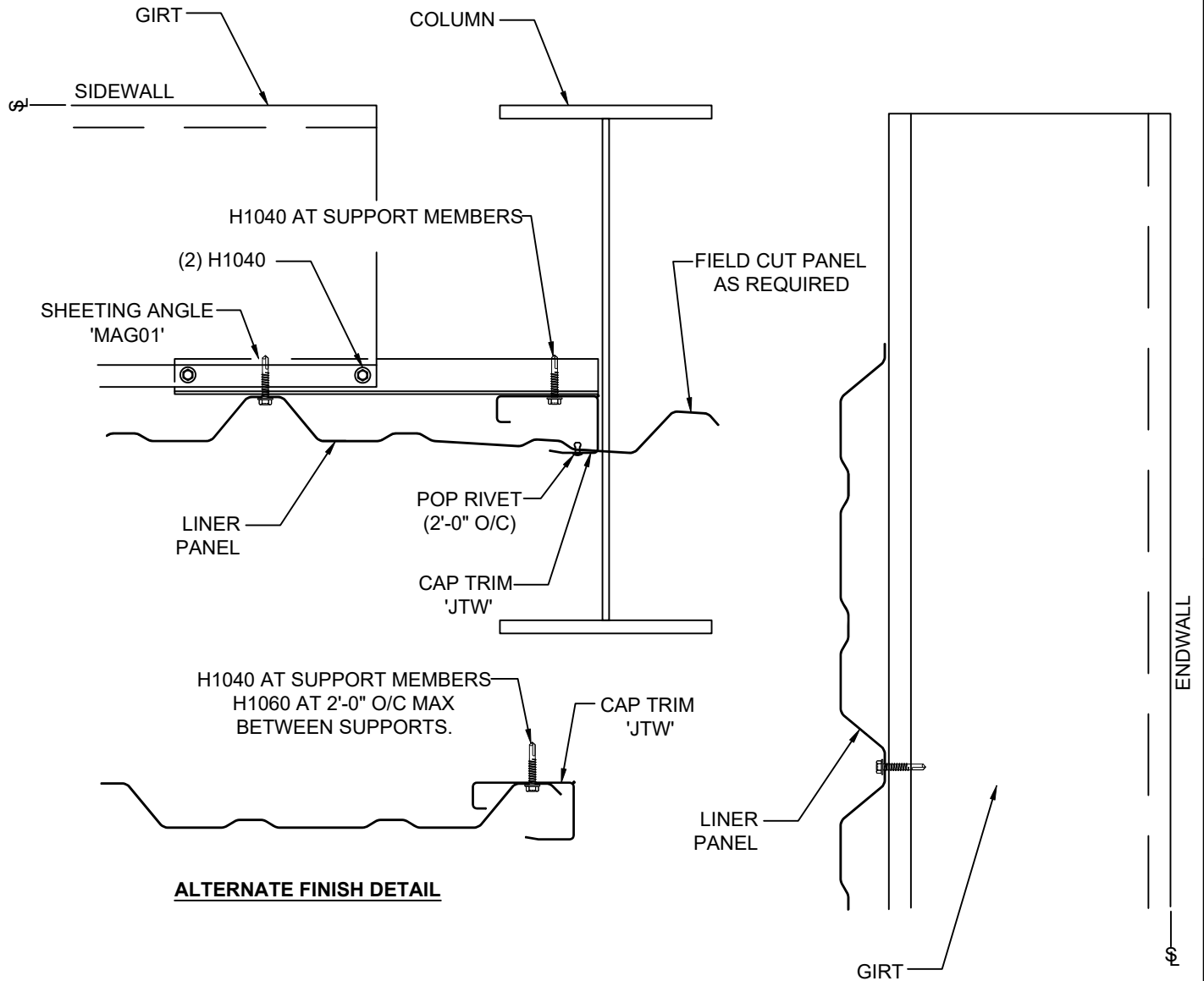

IA0301K

KRP LINER PANEL AT RF COLUMN
FLUSH/INSET CORNER

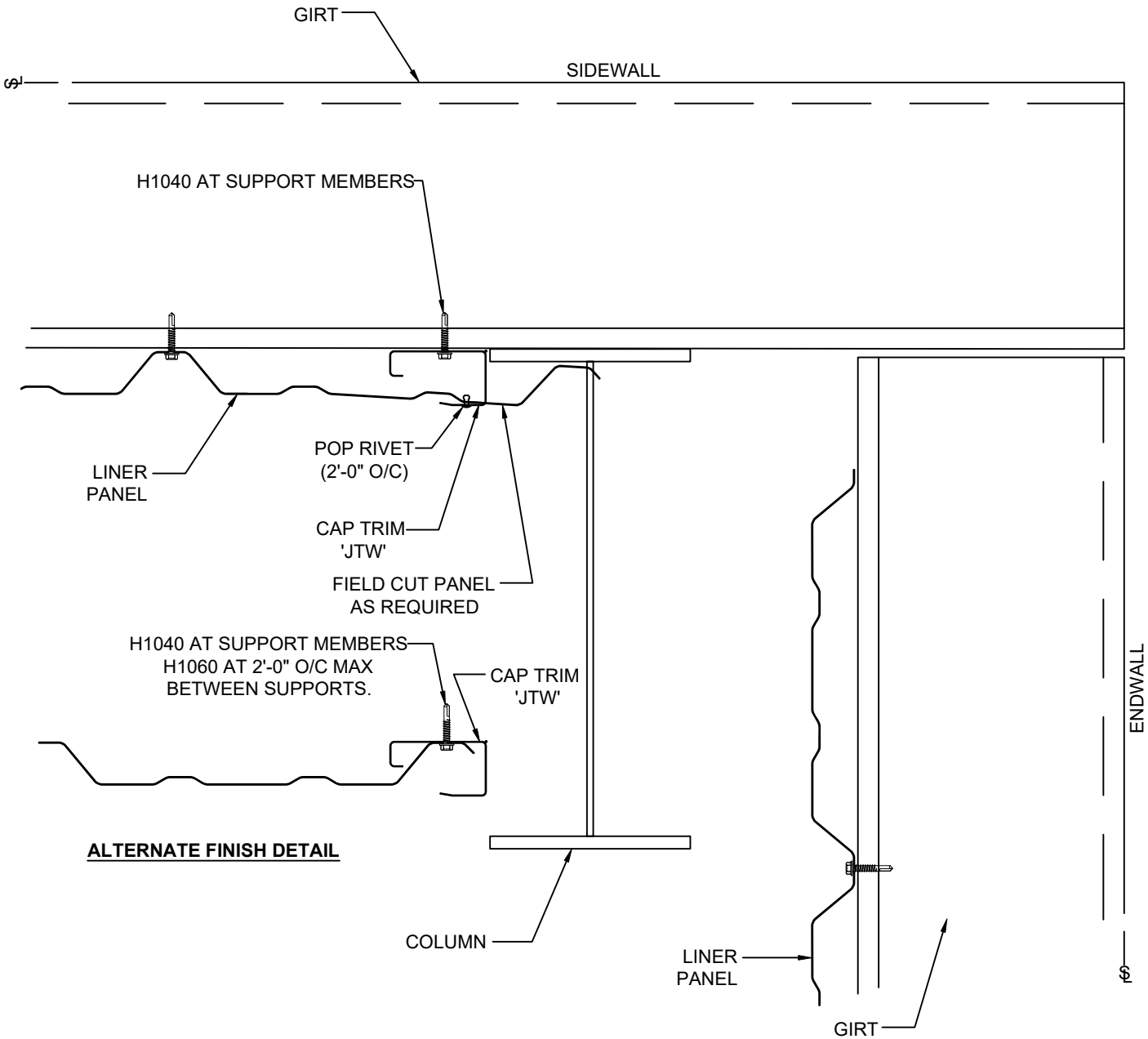

IA0302K

KRP LINER PANEL AT RF COLUMN
BY-FRAME CORNER

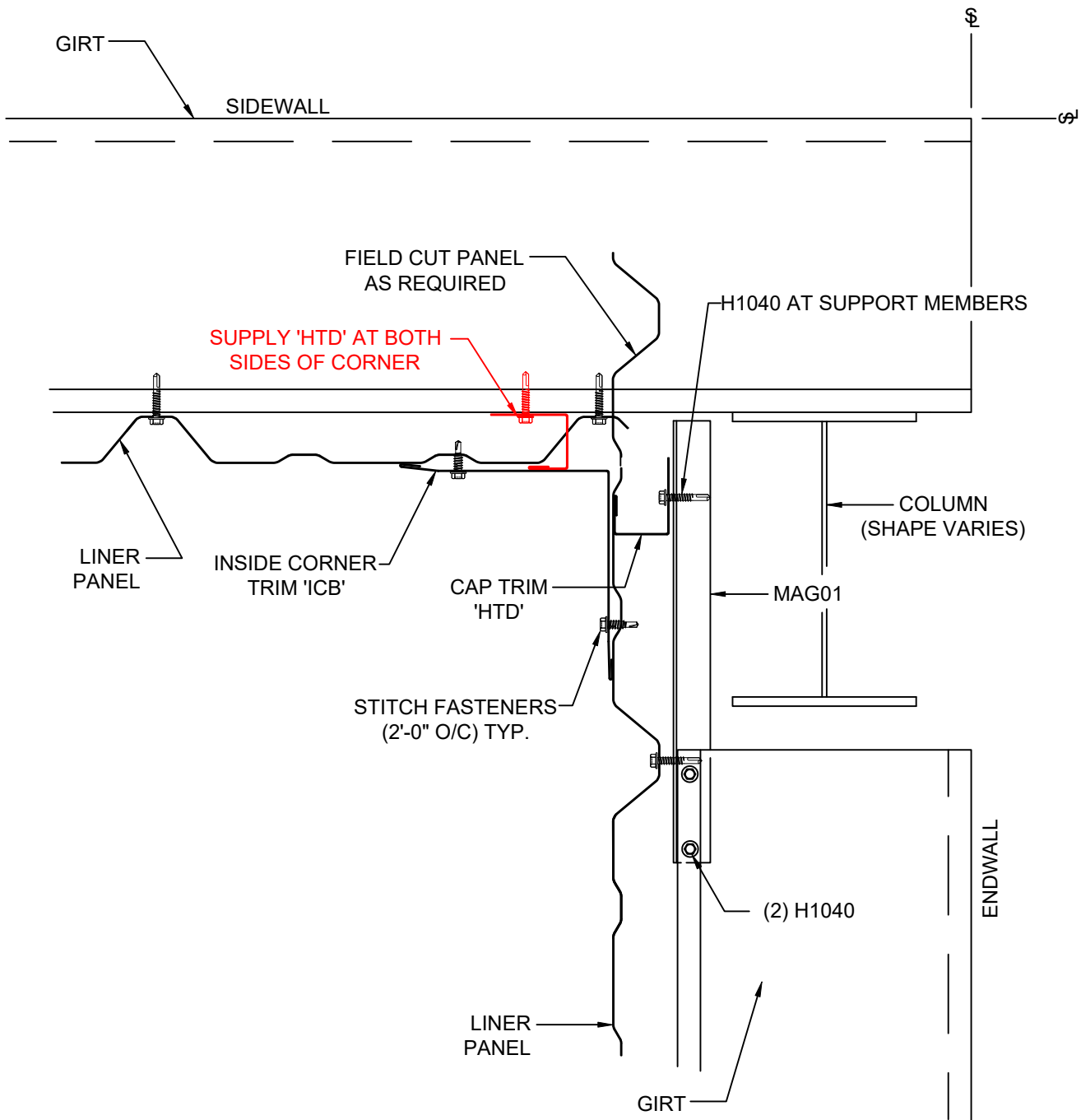
**IA0303K**

**KRP LINER PANEL AT ROTATED CORNER COLUMN
FLUSH/INSET CORNER**

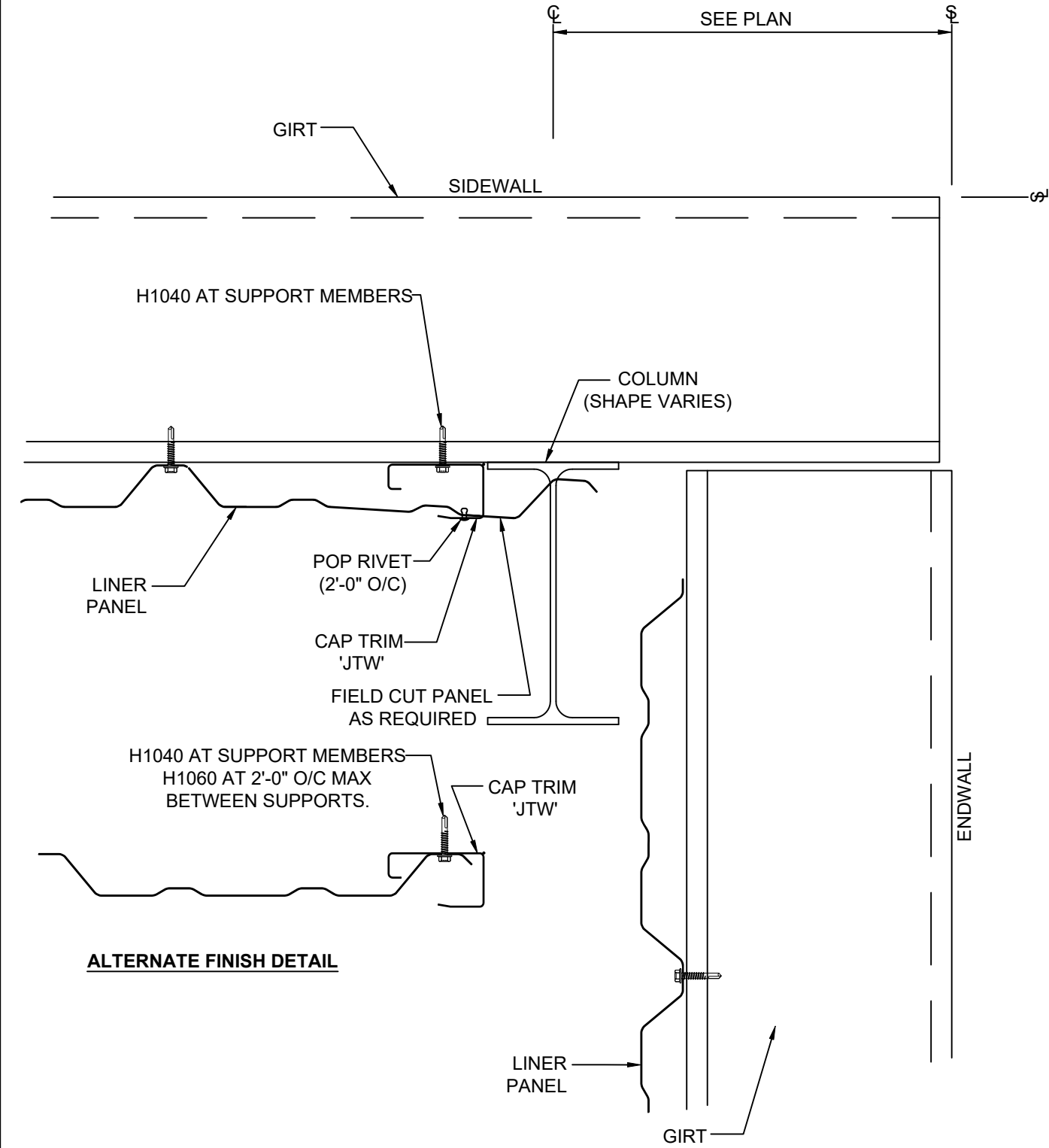

IA0304K

KRP LINER PANEL AT CORNER w/ BY-FRAME POST AND BEAM
ENDWALL AND ROTATED CORNER COLUMN

CED MANUAL

SECTION: **IA**

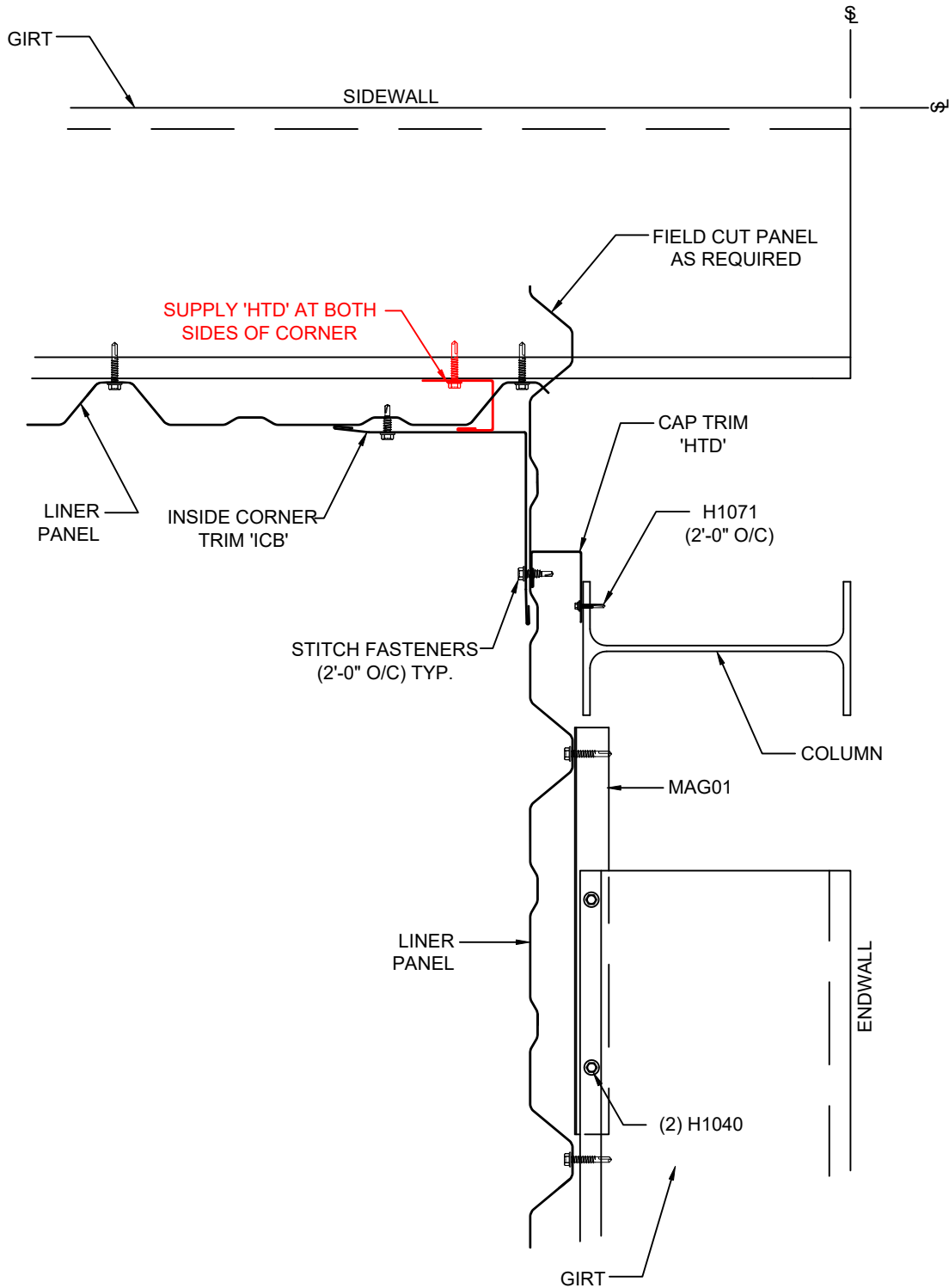

IA0306K

**KRP LINER PANEL AT CORNER w/ FLUSH POST AND BEAM
ENDWALL AND "I" COLUMN WITHIN GIRT LINE**

CED MANUAL

SECTION: XX

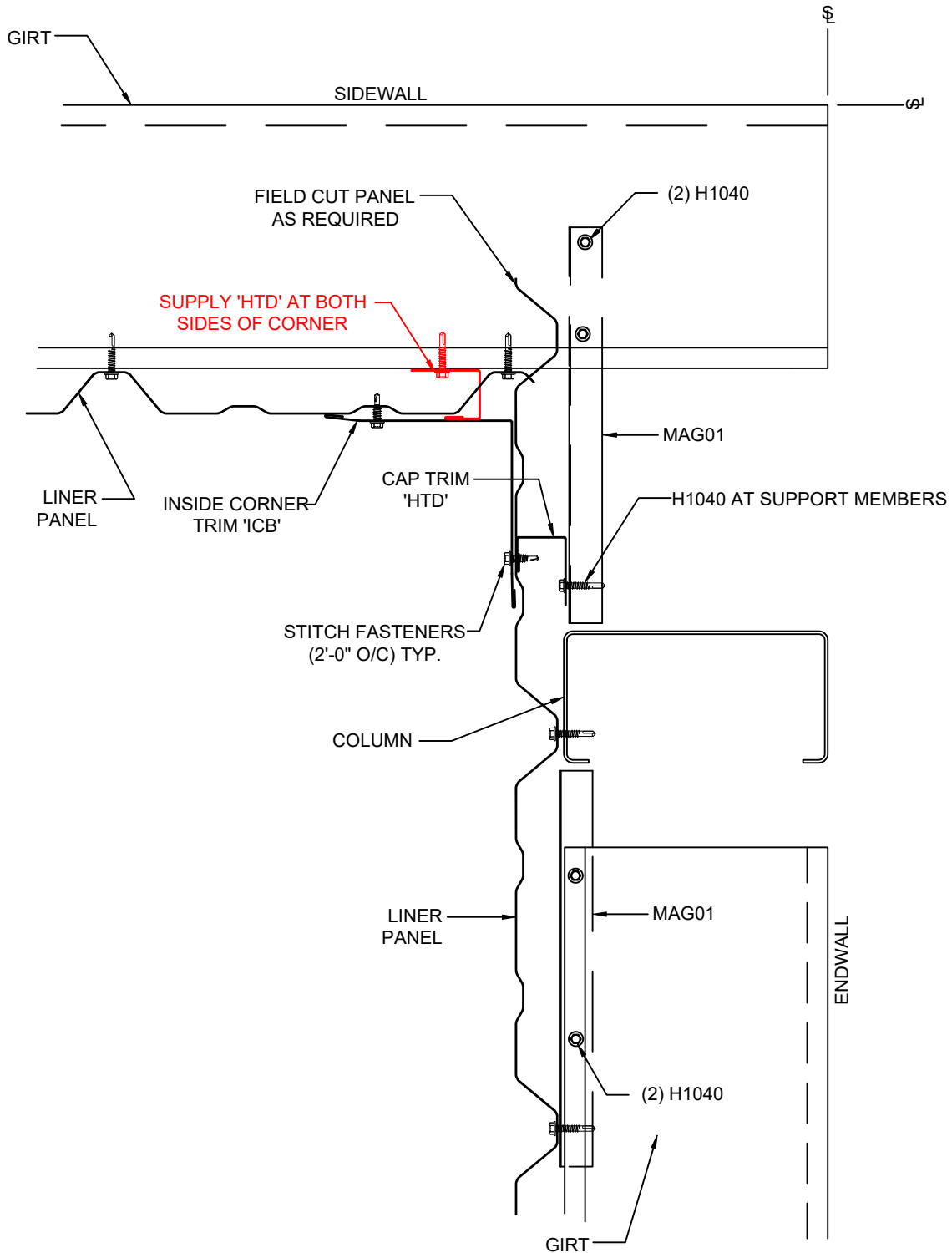

IA1306K

KRP LINER PANEL AT CORNER w/ FLUSH POST AND BEAM
ENDWALL AND CEE COLUMN WITHIN GIRT LINE

CED MANUAL

SECTION: **IA**

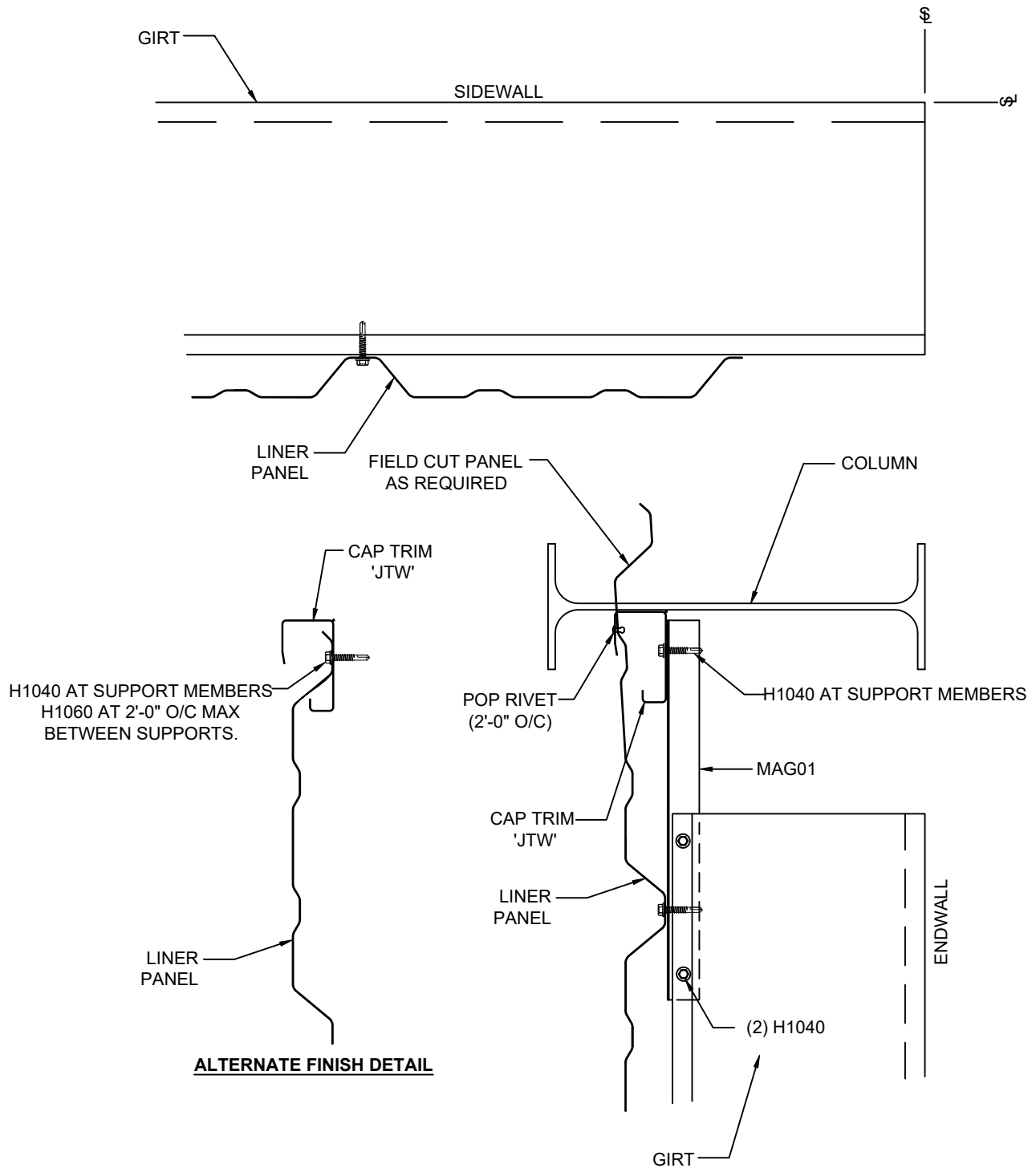

IA0307K

**KRP LINER PANEL AT CORNER w/ FLUSH/INSET POST AND BEAM
ENDWALL AND "I" COLUMN OUTSIDE GIRT LINE**

CED MANUAL

SECTION: **IA**

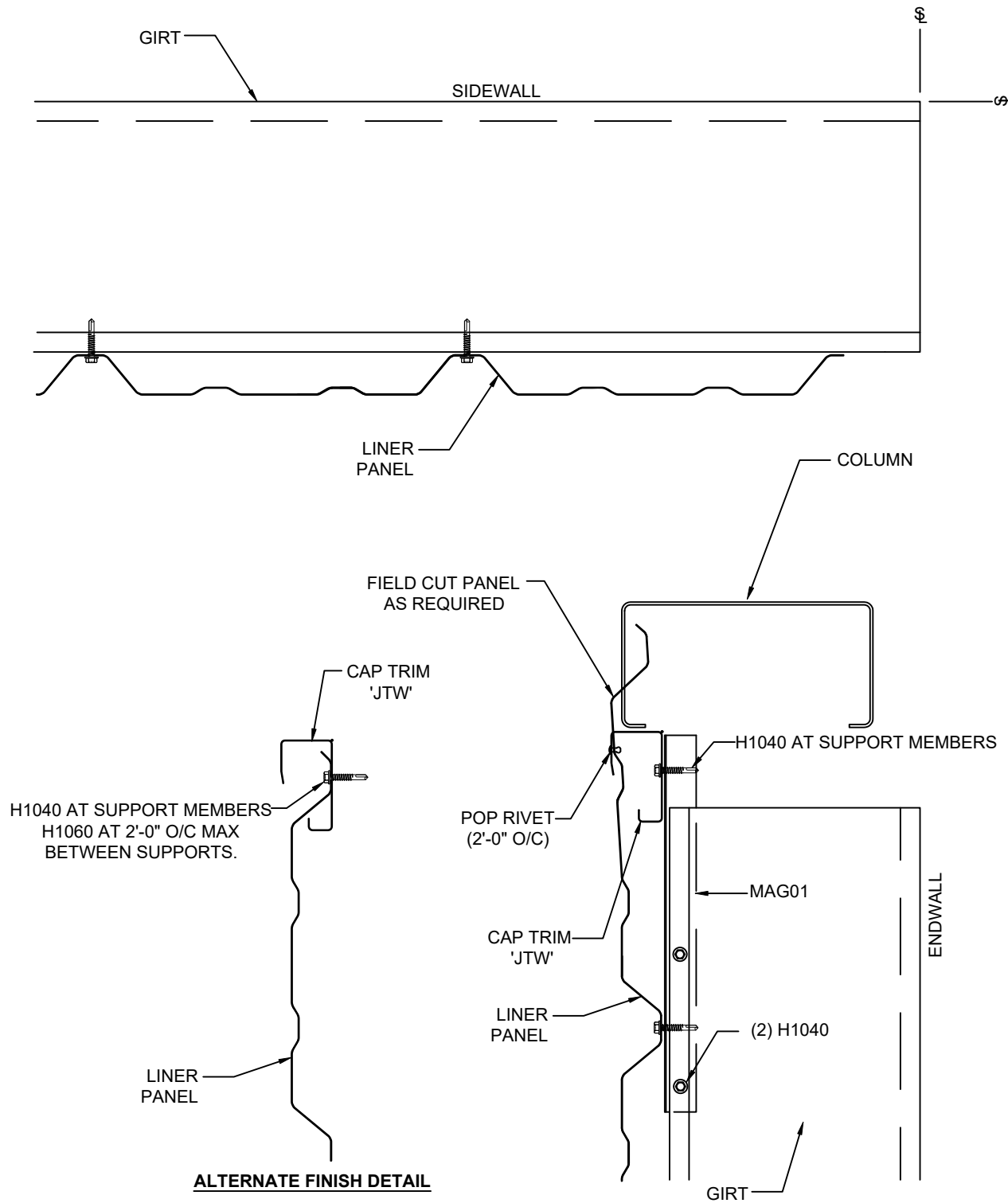

IA1307K

**KRP LINER PANEL AT CORNER w/ FLUSH/INSET POST AND BEAM
ENDWALL AND CEE COLUMN IN PANEL LINE**

CED MANUAL

SECTION: **IA**

The diagram illustrates a cross-section of a wall assembly. At the top, a horizontal line is labeled "GIRT". Below it, a horizontal line is labeled "SIDEWALL". The main body of the wall is composed of a "LINER PANEL" and a "FIELD CUT PANEL AS REQUIRED". A "COLUMN" is shown on the right side. The wall is supported by "H1040 (2'-0\" O/C)" members. "CAP TRIM 'JTW'" is shown at the top and bottom edges. "CLOSURE TRIM 'TXP'" is shown at the bottom edge. "POP RIVET (2'-0\" O/C)" are shown at the bottom edge. "MAG01" is shown at the bottom edge. "H1040 AT SUPPORT MEMBERS" and "H1060 AT 2'-0\" O/C MAX BETWEEN SUPPORTS" are shown at the bottom edge. The right side of the wall is labeled "ENDWALL". At the bottom right, "(2) H1040" is shown. An "ALTERNATE FINISH DETAIL" is shown on the left side of the main wall assembly.

ALTERNATE FINISH DETAIL

IA2307K

**KRP LINER PANEL AT CORNER w/ FLUSH/INSET POST AND BEAM
ENDWALL AND CEE COLUMN OUTSIDE GIRT LINE**

IA2307

CED MANUAL

SECTION: **IA**

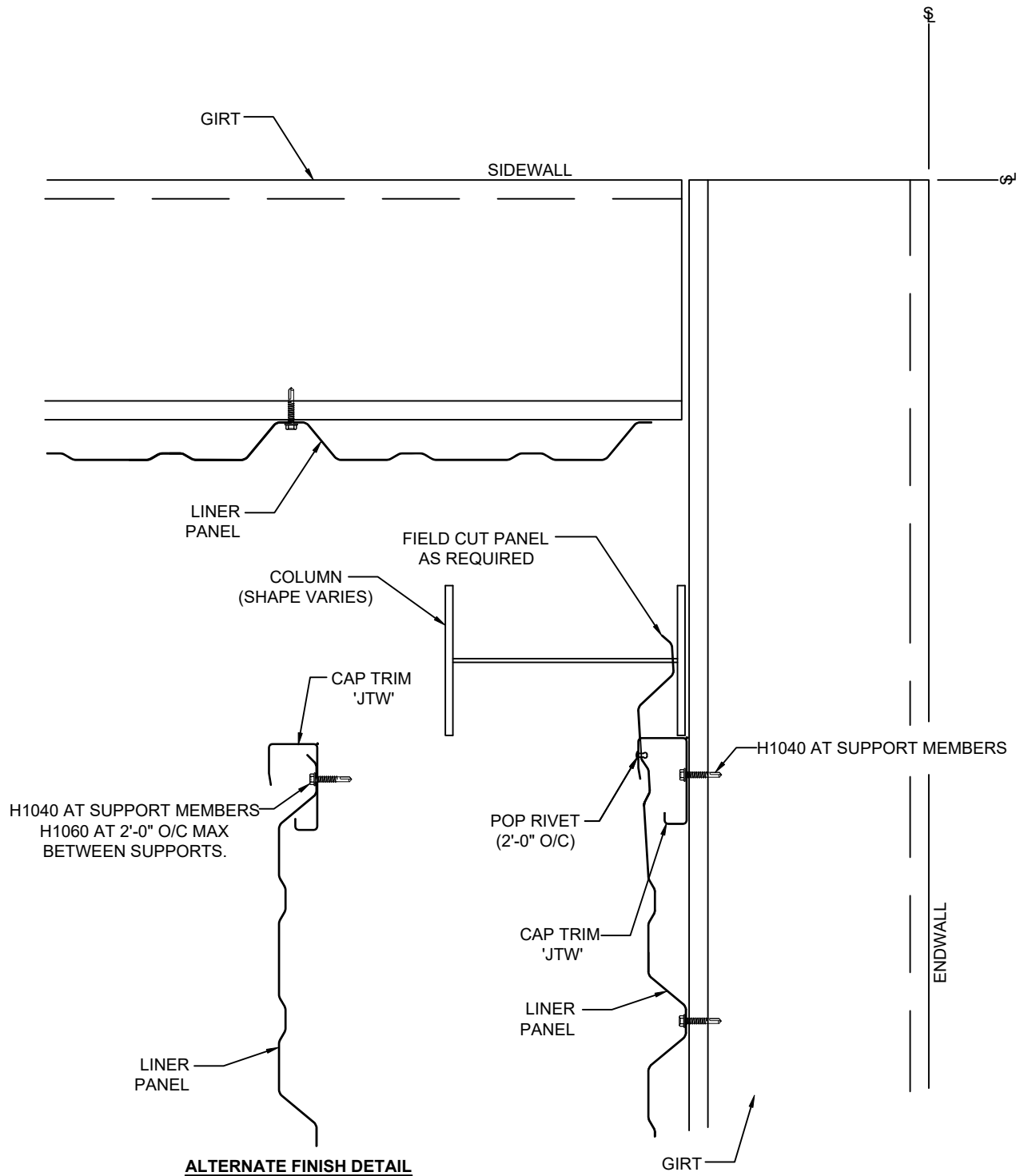

IA0308K

**KRP LINER PANEL AT CORNER
w/ BY-FRAME POST AND BEAM ENDWALL**

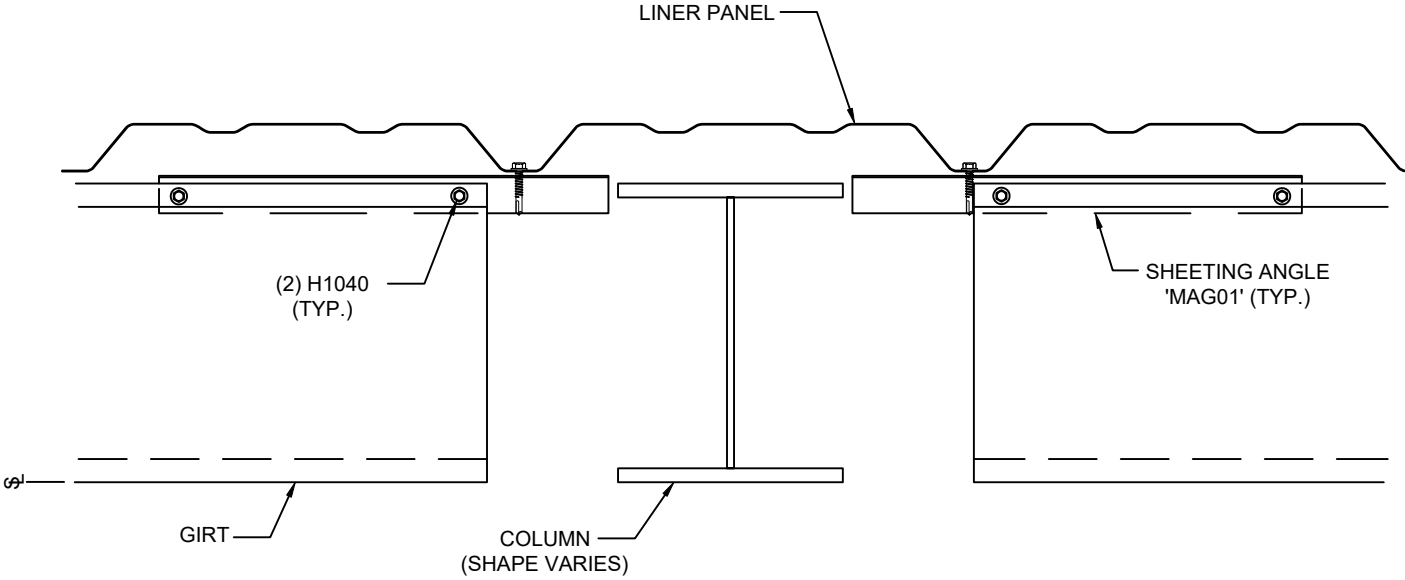

IA0310K

KRP LINER PANEL AT SIDEWALL
FLUSH COLUMN, COLUMN IN GIRT LINE

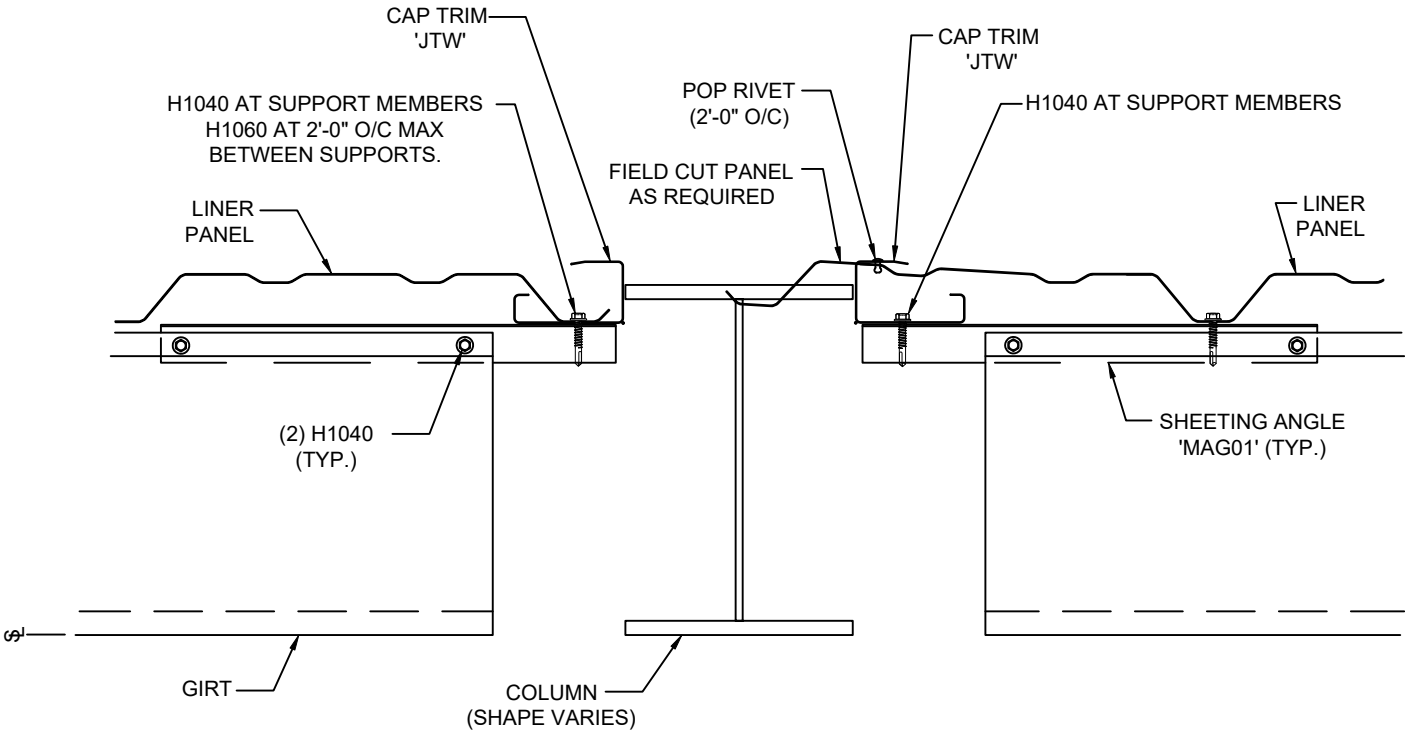

IA0311K

KRP LINER PANEL AT SIDEWALL FLUSH/INSET COLUMN,
COLUMN FLANGE OUTSIDE GIRT LINE

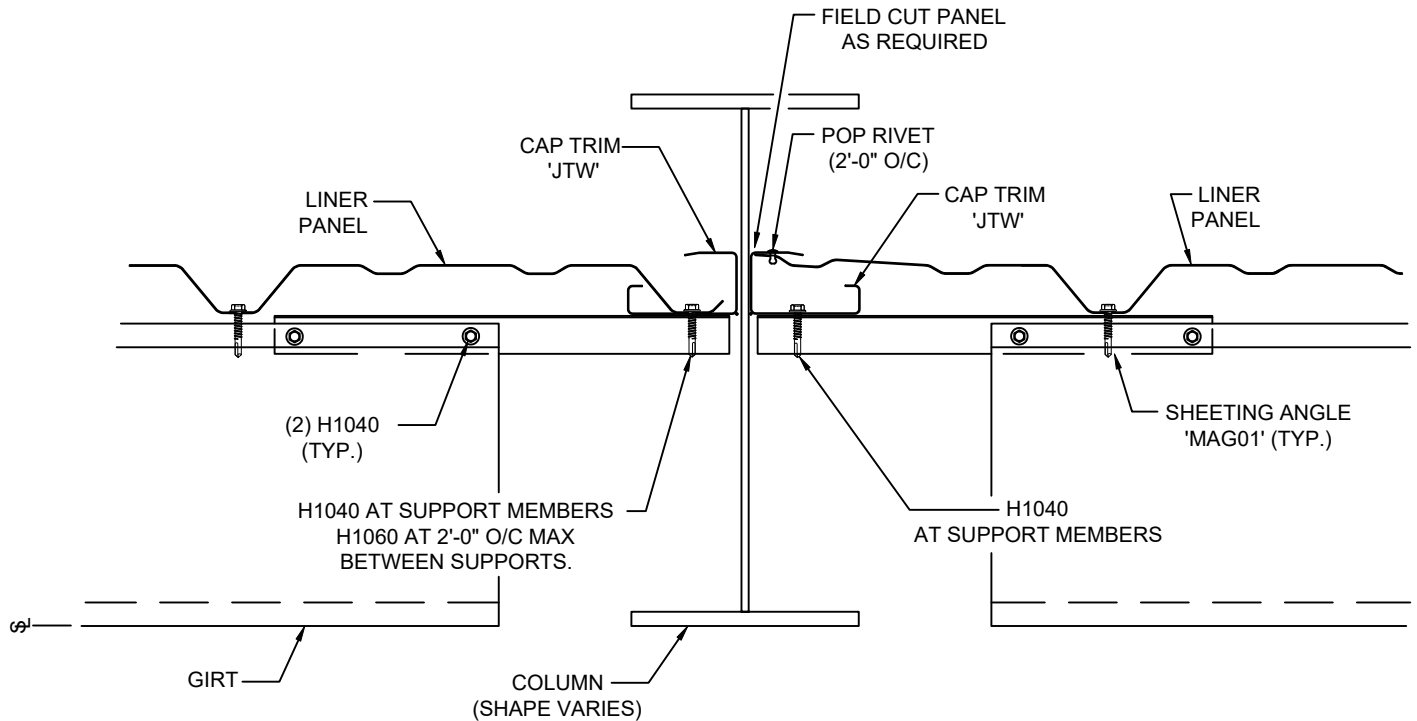

IA0312K

KRP LINER PANEL AT SIDEWALL FLUSH/INSET COLUMN,
COLUMN OUTSIDE GIRT LINE

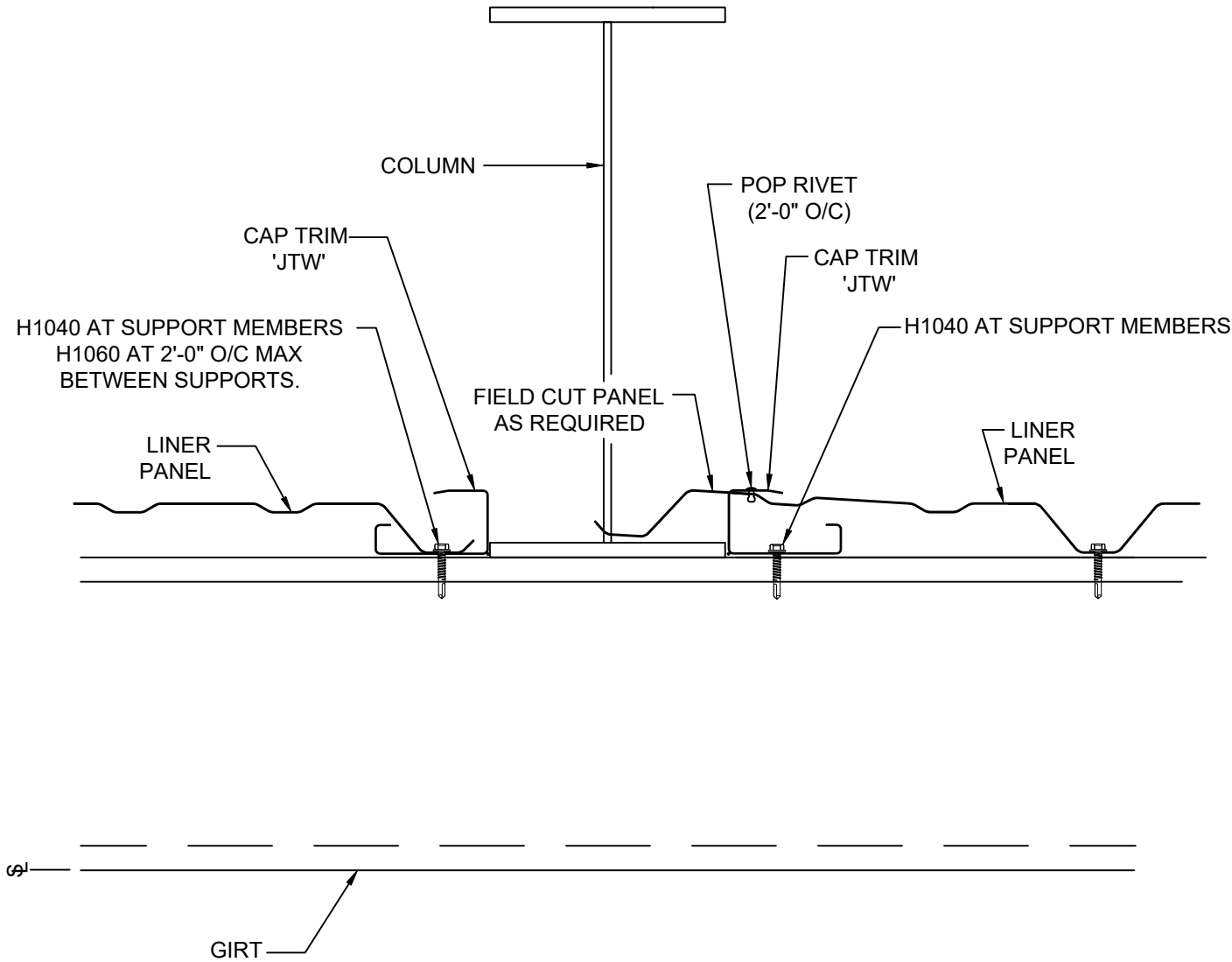

IA0320K

KRP LINER AT COLUMN w/ BY-FRAME GIRT

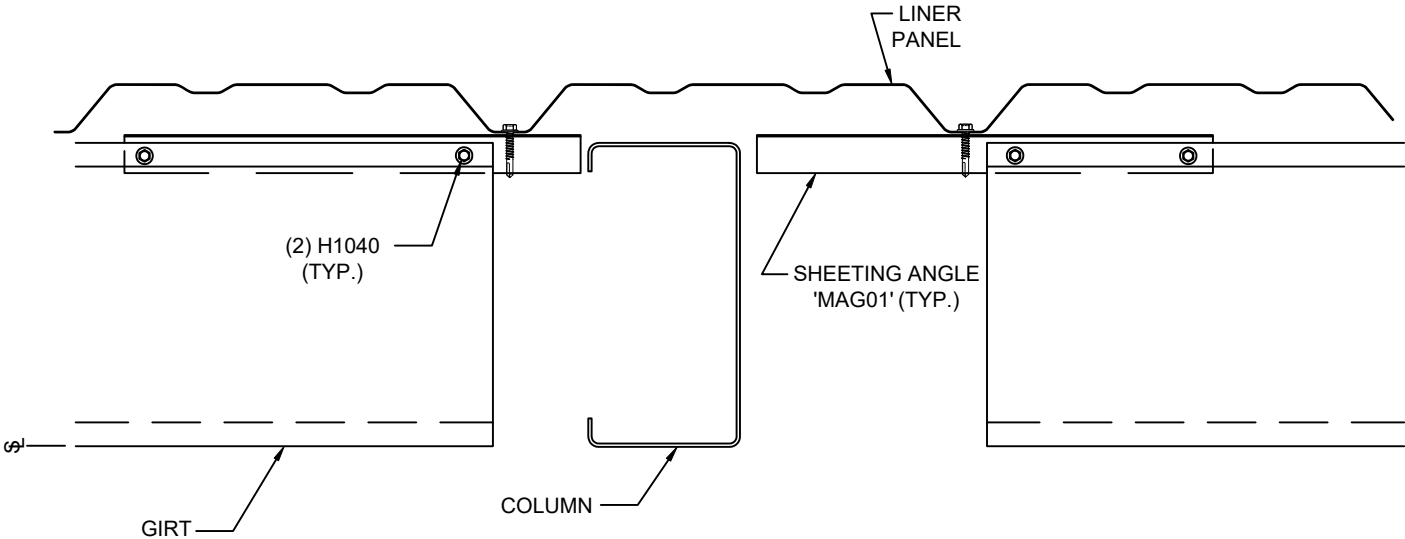

IA0330K

KRP LINER AT FLUSH "CEE" COLUMN

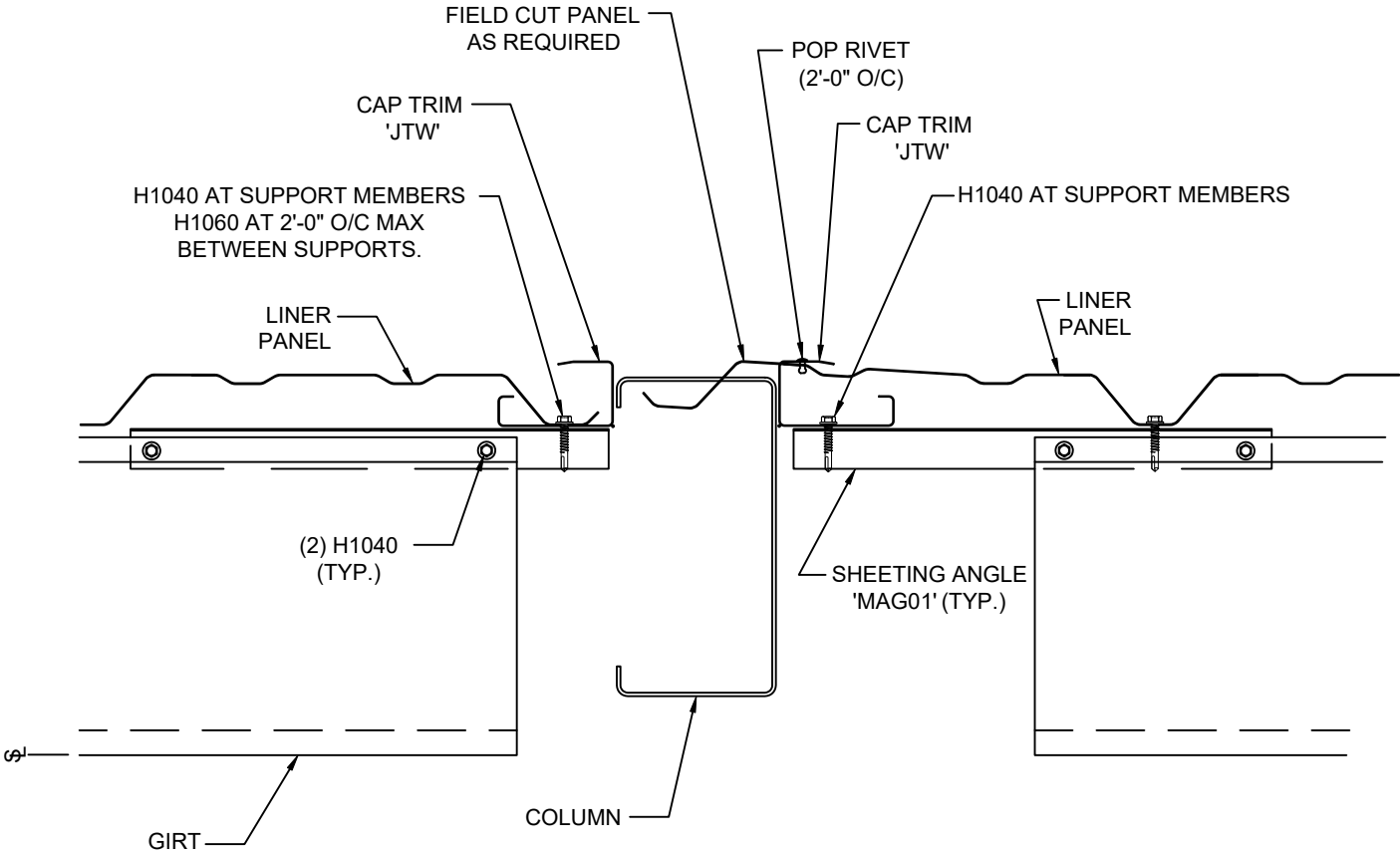

IA0331K

KRP LINER PANEL AT FLUSH/INSET "CEE" COLUMN
w/COL. FLANGE IN PANEL LINE

CED MANUAL

SECTION:

IA

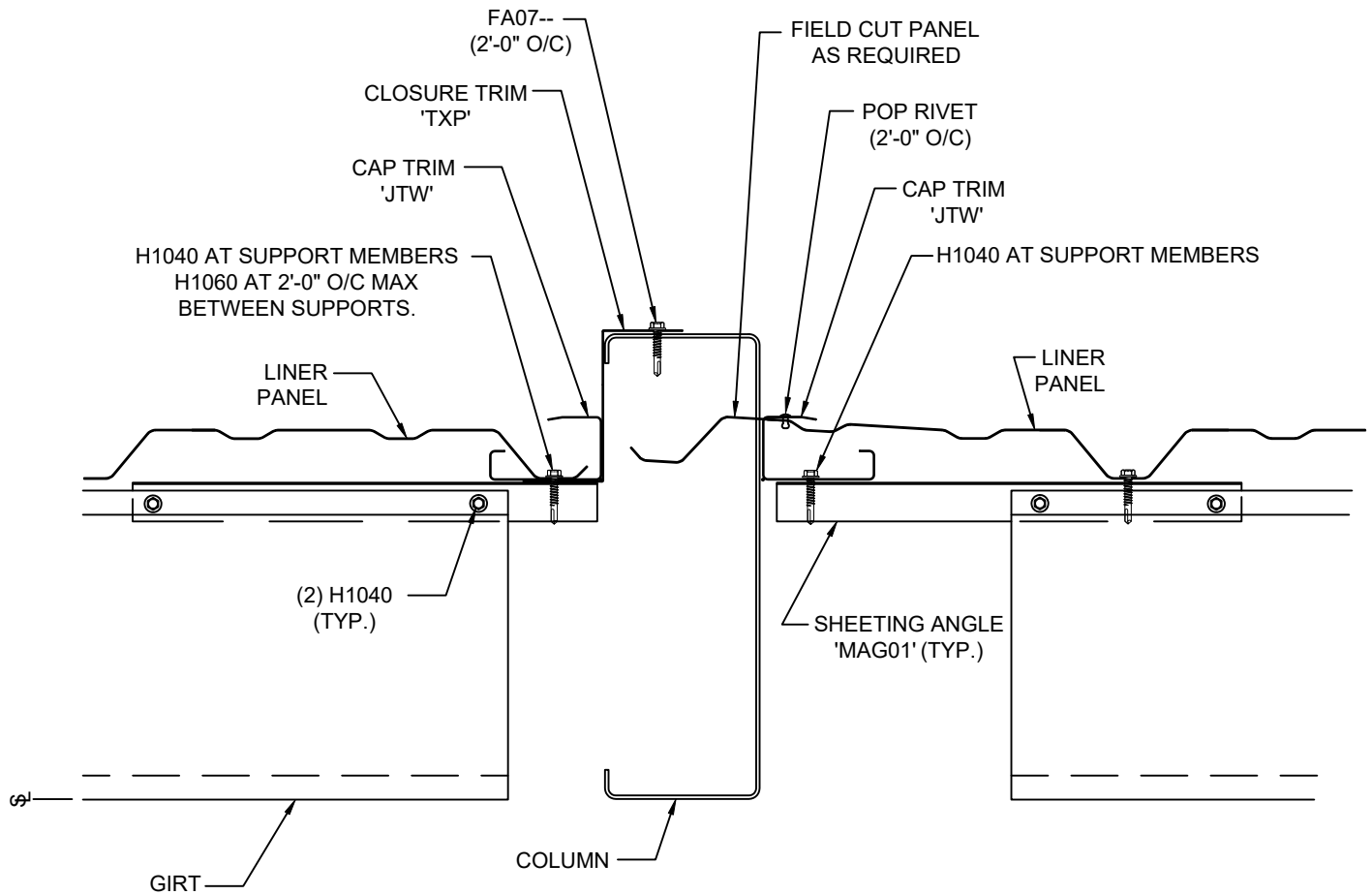

IA0332K

**KRP LINER PANEL AT FLUSH/INSET "CEE" COLUMN
w/COL. OUTSIDE GIRT LINE**



PREPARED BY: BKC

DATE:4-22-20

IA0332

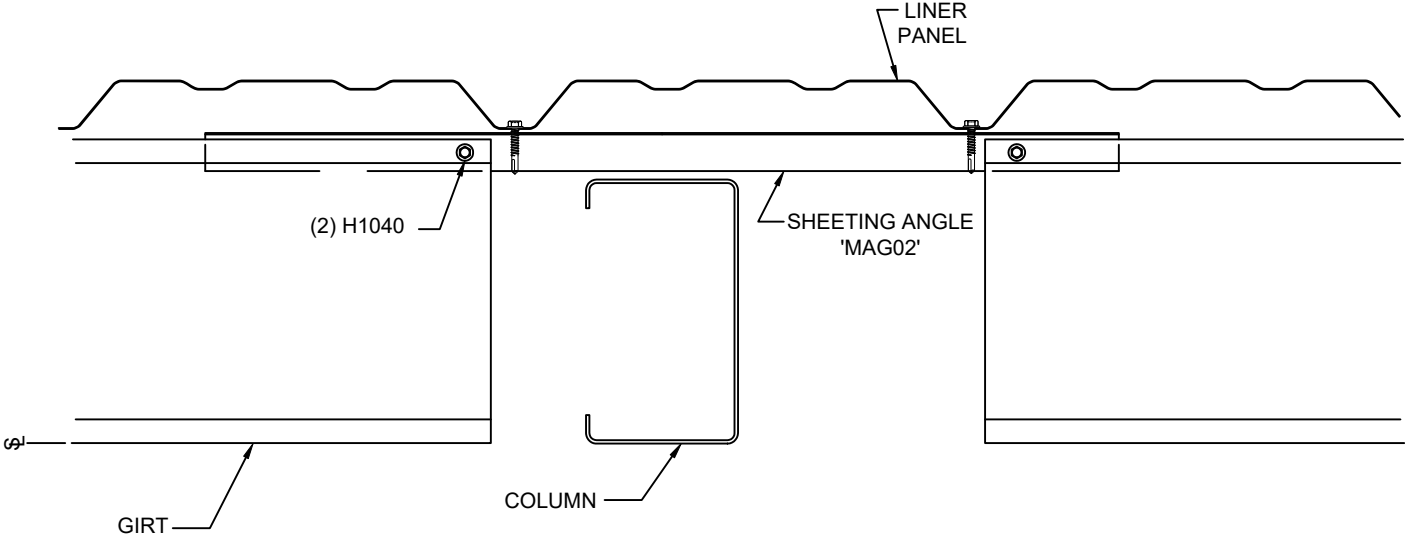

IA0334K

KRP LINER AT FLUSH "CEE" COLUMN
GIRT DEPTH > COL DEPTH

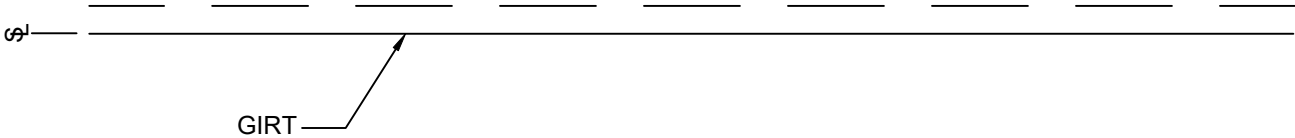
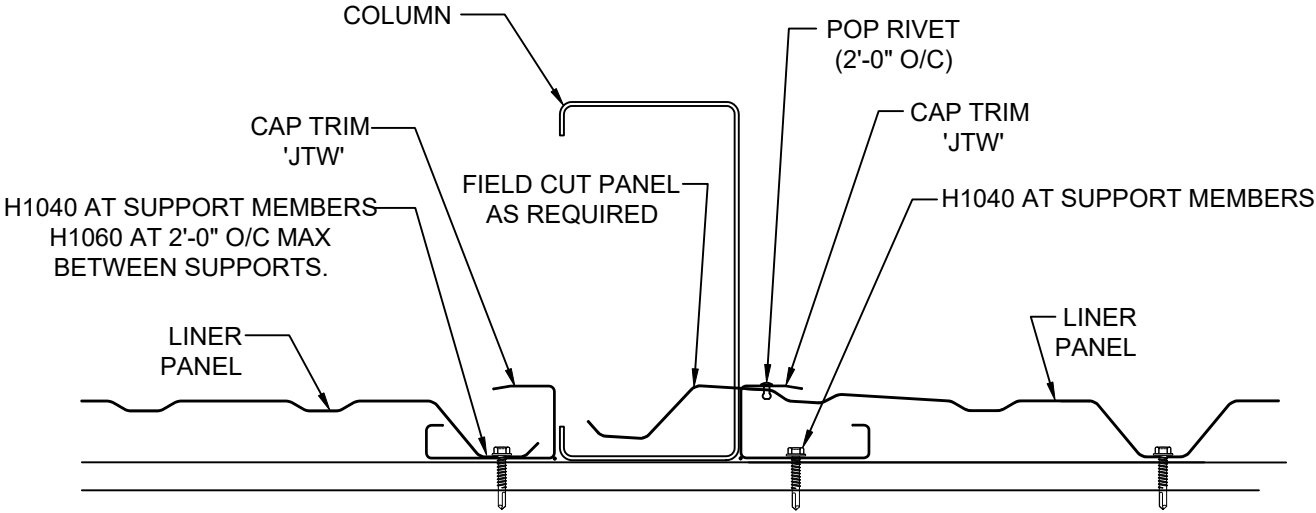

IA0340K

KRP LINER AT BY-FRAME
CEE COLUMN GIRT TERMINATION

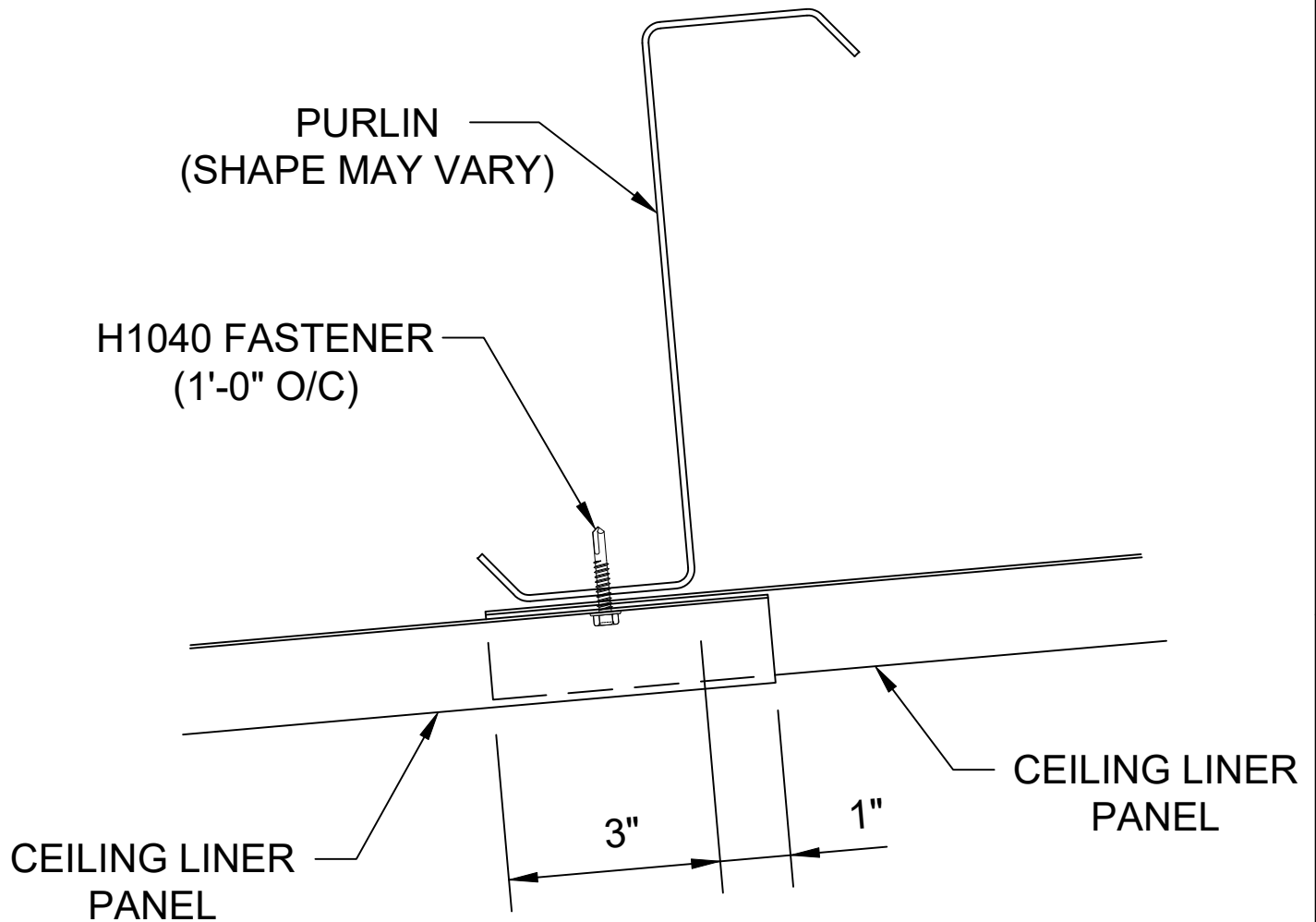

STANDARD MAX. CEILING LINER LENGTH = 20'-4"

IA0080 K

CEILING LINER LAP DETAIL FOR KR2, KW or KRP

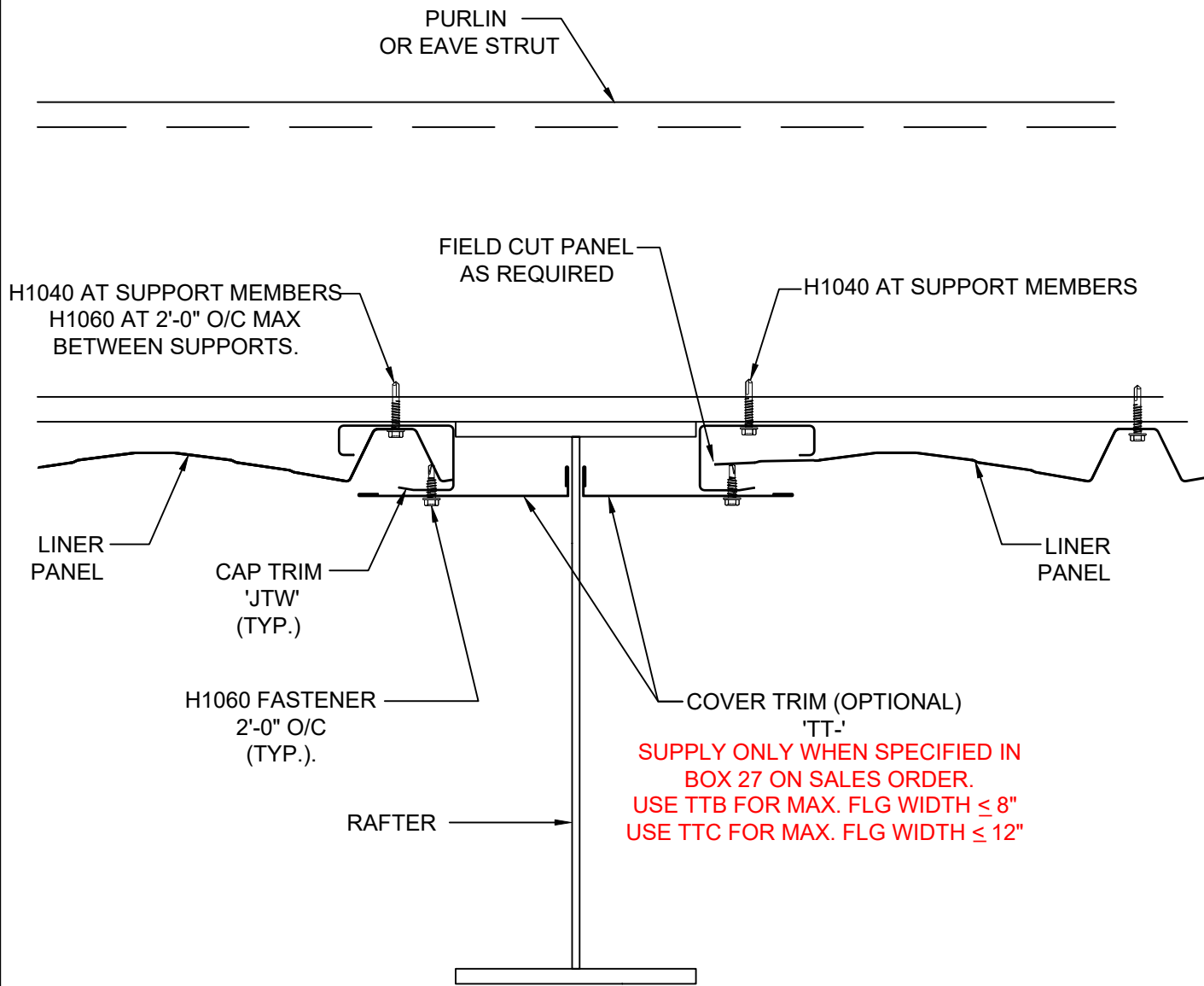

SUPPLY ONLY WHEN SPECIFIED IN
BOX 27 ON SALES ORDER.
USE TTB FOR MAX. FLG WIDTH ≤ 8"
USE TTC FOR MAX. FLG WIDTH ≤ 12"

IA0100K

KW CEILING LINER AT INTERIOR RAFTERS

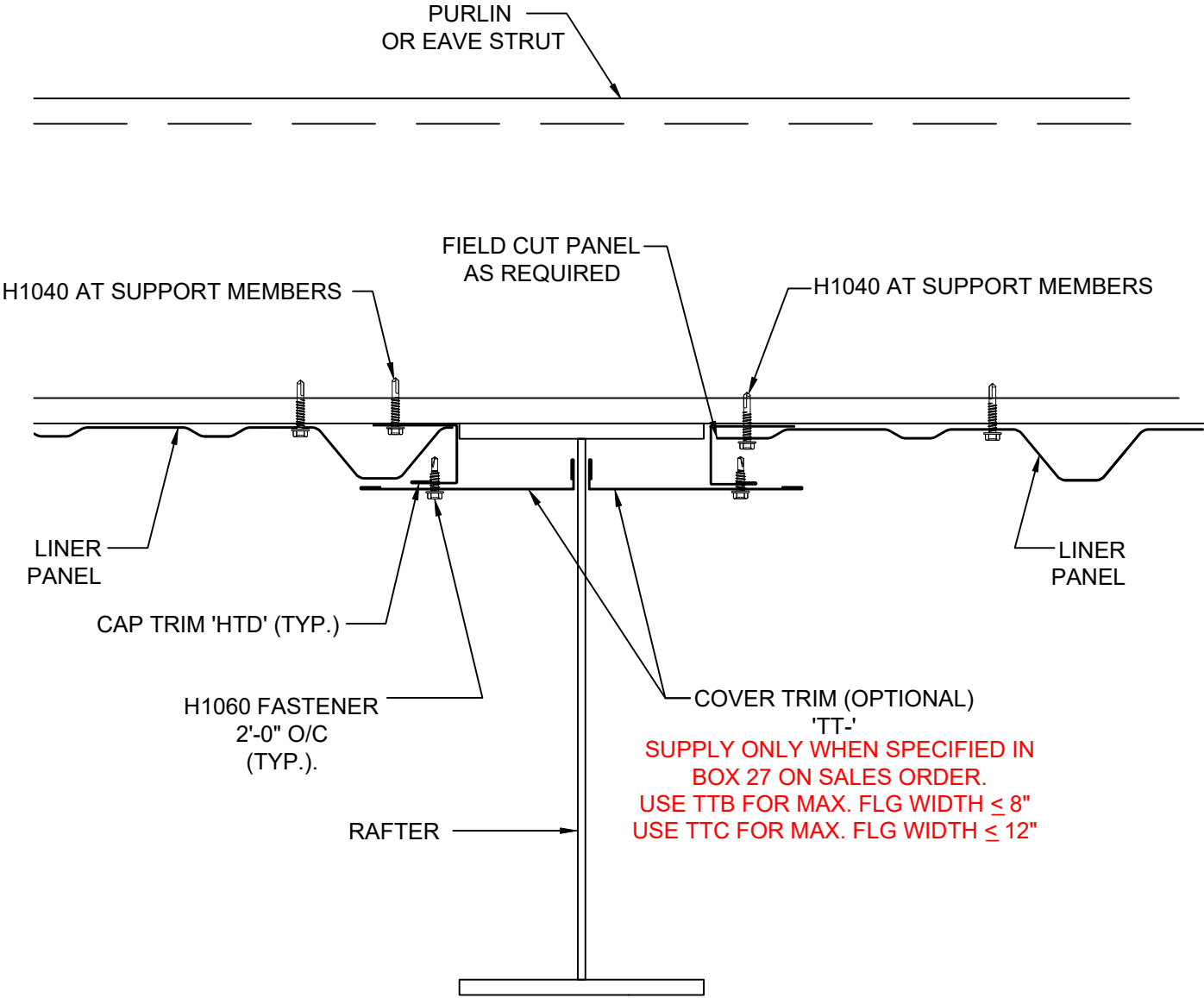

IA0200K

KR2 CEILING LINER AT INTERIOR RAFTERS

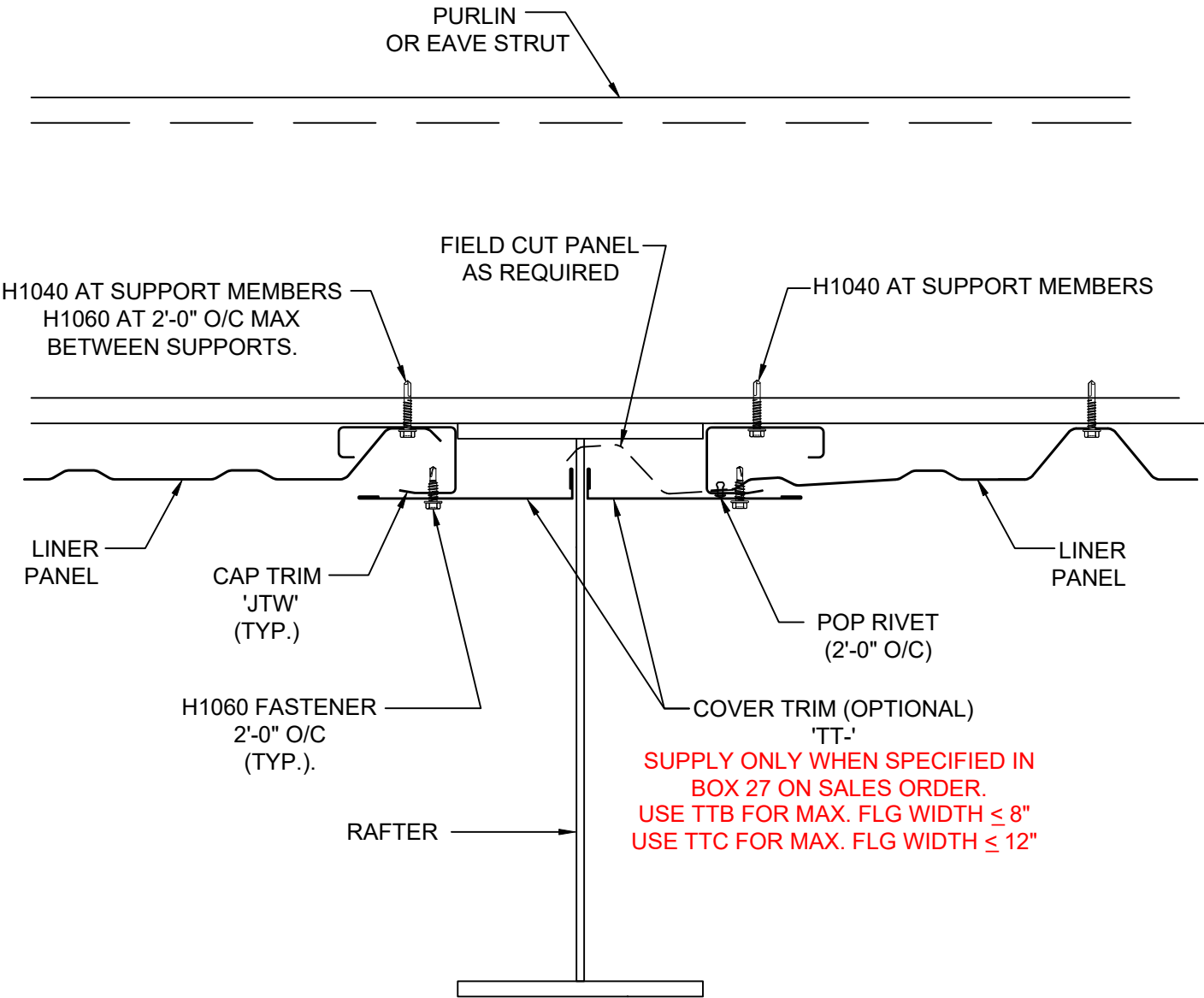

IA0300K

KRP CEILING LINER AT INTERIOR RAFTERS



KIRBY
BUILDING
SYSTEMS
A NUCCA COMPANY
BETTER SOLUTIONS. BETTER BUILDINGS.

PREPARED BY: BKC

DATE: 4-22-20

IA0300