

GA0030 - Typ. Trim Lap
GA0072 - Wall Panel Lap
GA0074 - Wall Pnl to Masonry Wainscot
GA0076 - Wall Pnl. to Wall Pnl. Wainscot
GA0081 - Downspout to Gutter
GA0082 - Downspout Strap Installation
GA1082 - DS Strap Installation - Const. B.O.
GA0085 - Downspout Layout w/ Full Height Pnl.
GA0185 - Downspout Return to Sht'd Wall
GA0086 - D'Spout Layout w/ Full Height Const. B.O.
GA0087 - D'Spout Layout w/ Partial Sheeted Wall, Open Below for Const.
GA0187 - D'Spout Layout w/ Partial Sheeted Wall & Open Below
GA0089 - D'Spout Layout w/Open Wall, By-Frame
GA0189 - D'Spout Layout w/Open Wall, Flush
GA0101 - KirbyWall Installation
GA0201 - KirbyRib Installation
GA0301 - KRP Installation
GA0601 - Pipe Flash Installation

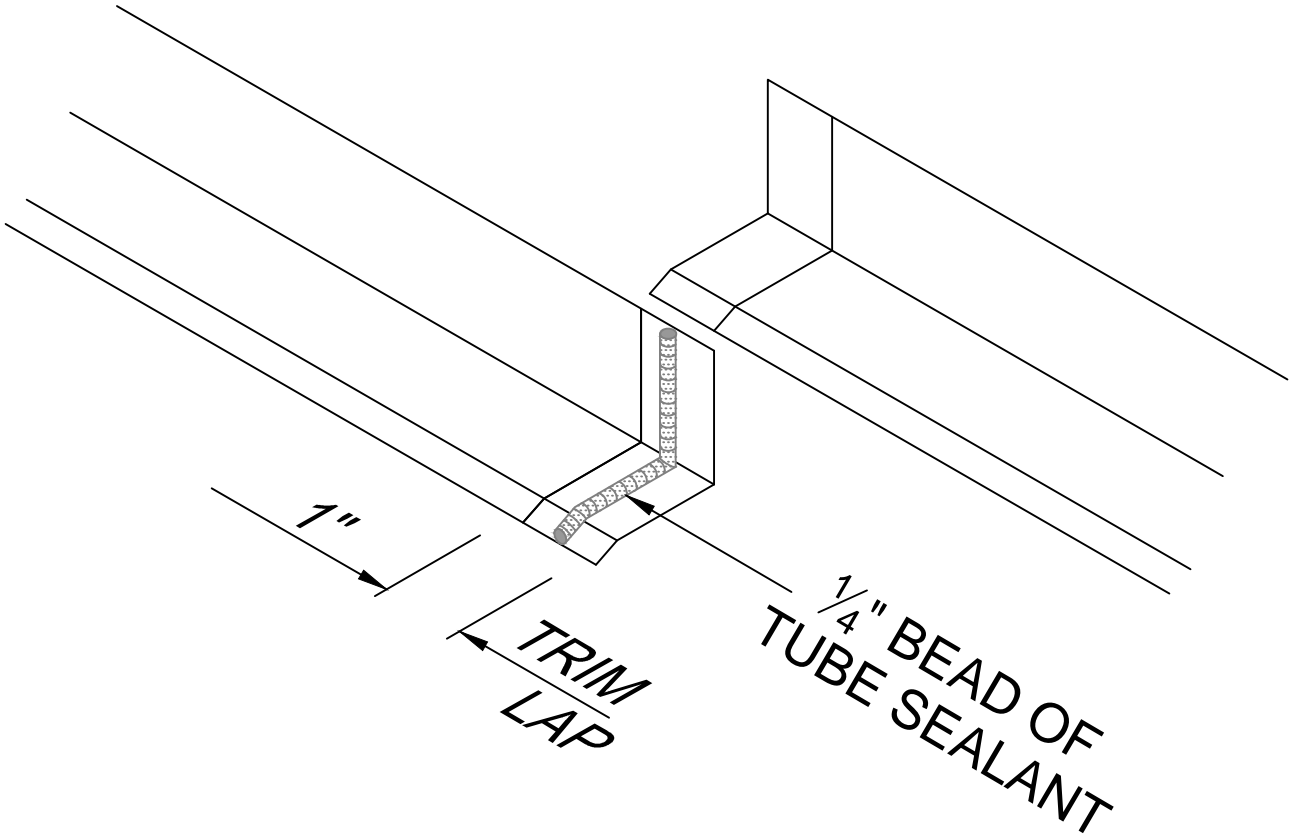
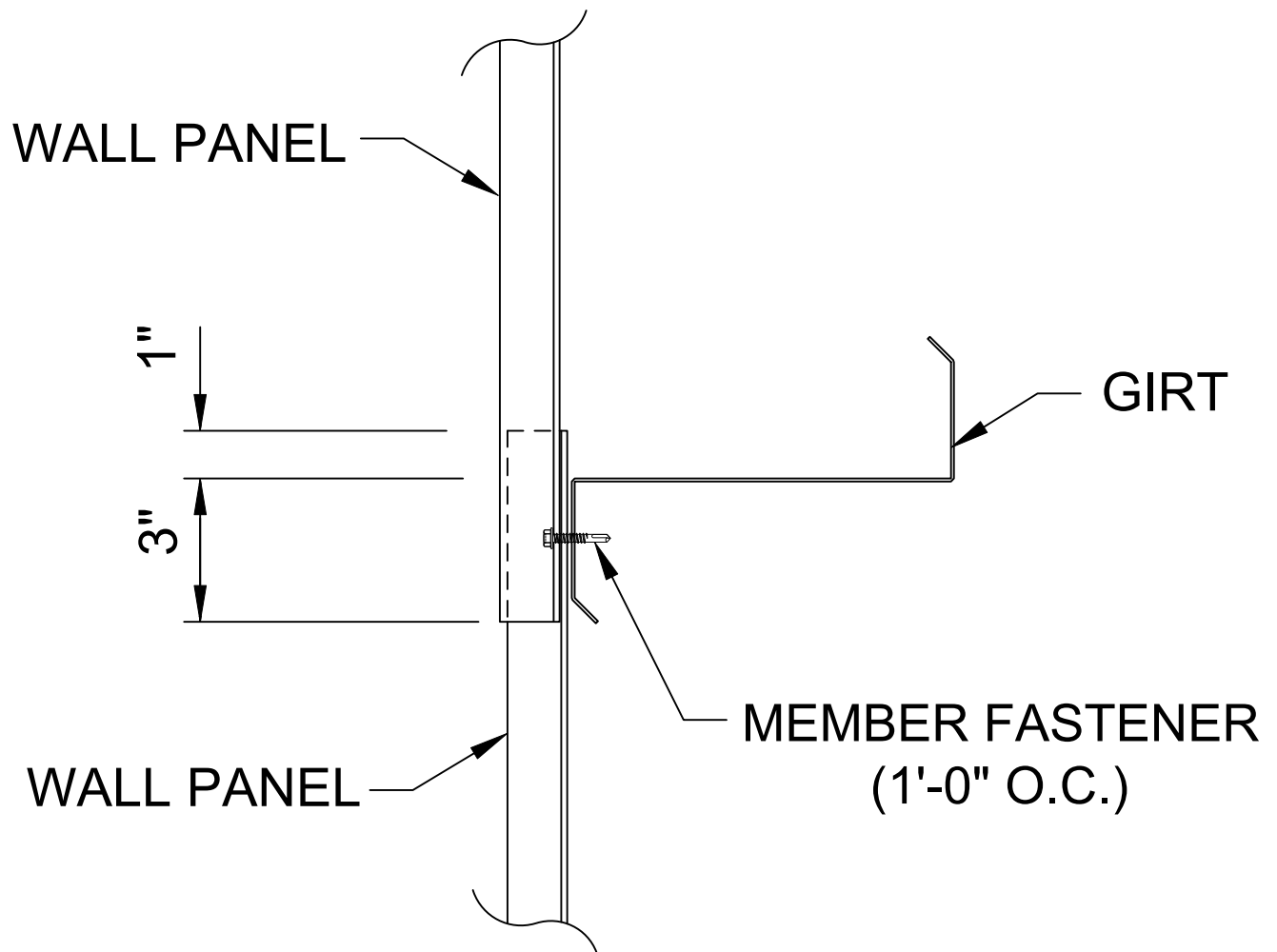

GA0030K
TYPICAL TRIM LAP

**GA0072 K****WALL PANEL LAP DETAIL**

****= MBS WILL CALCULATE THE SHEET 1/4" ABOVE THE GIRT
DO NOT ADJUST PANEL LENGTH FOR 1/8" DIFFERENCE.**

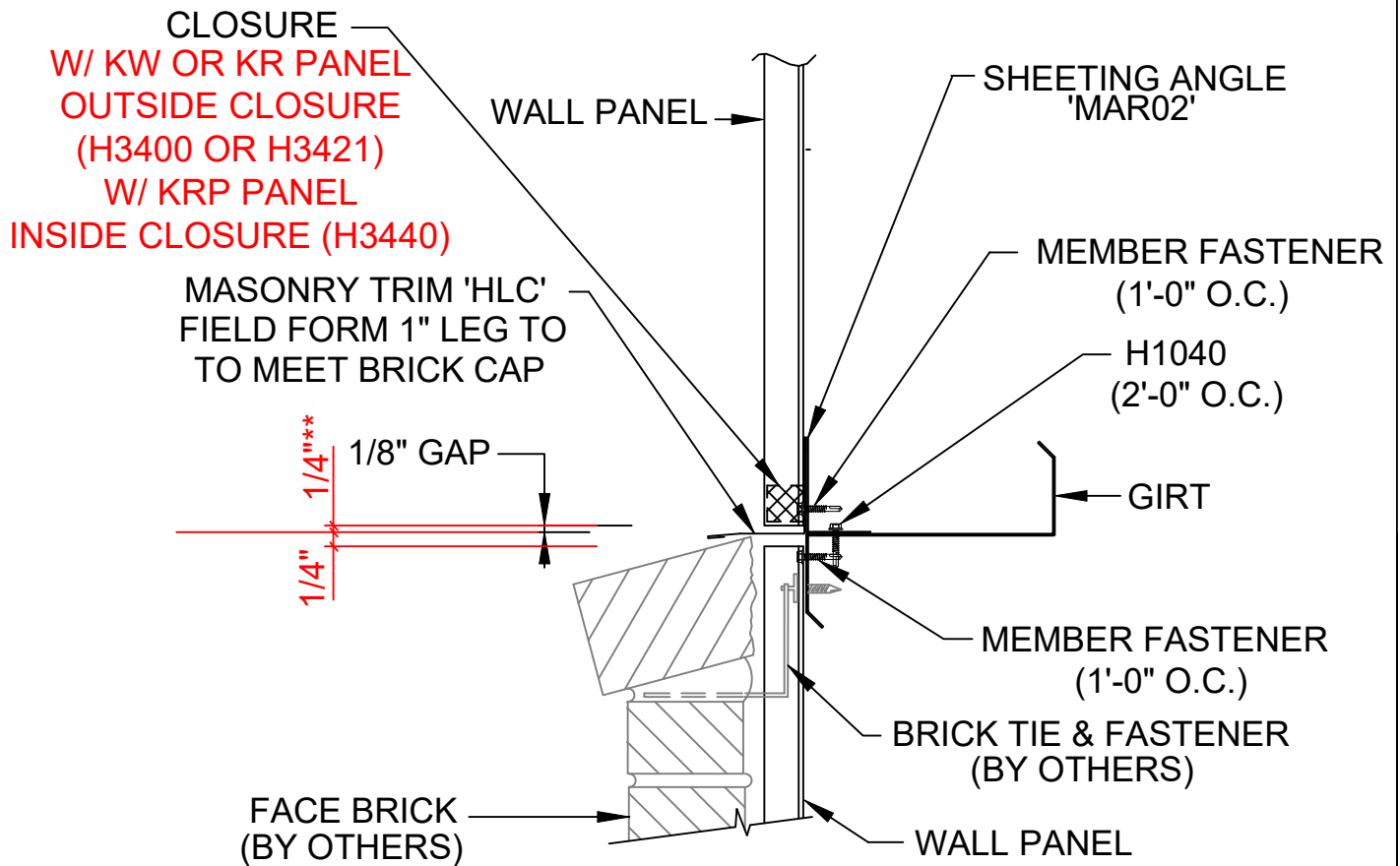

GA0074K

WALL PANEL TO MASONRY WAINSCOT

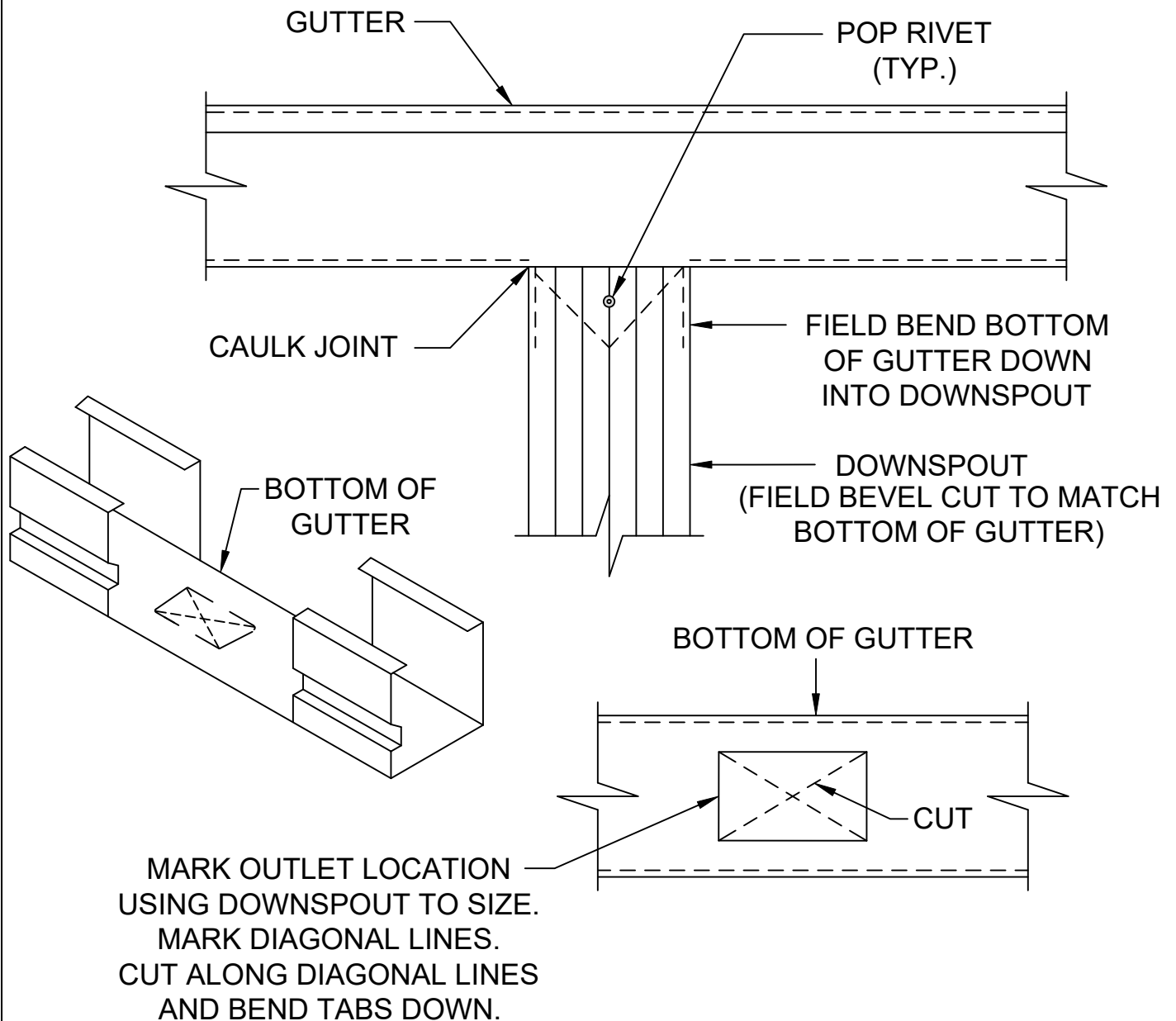

GA0081 K

DOWNSPOUT CONNECTION TO GUTTER

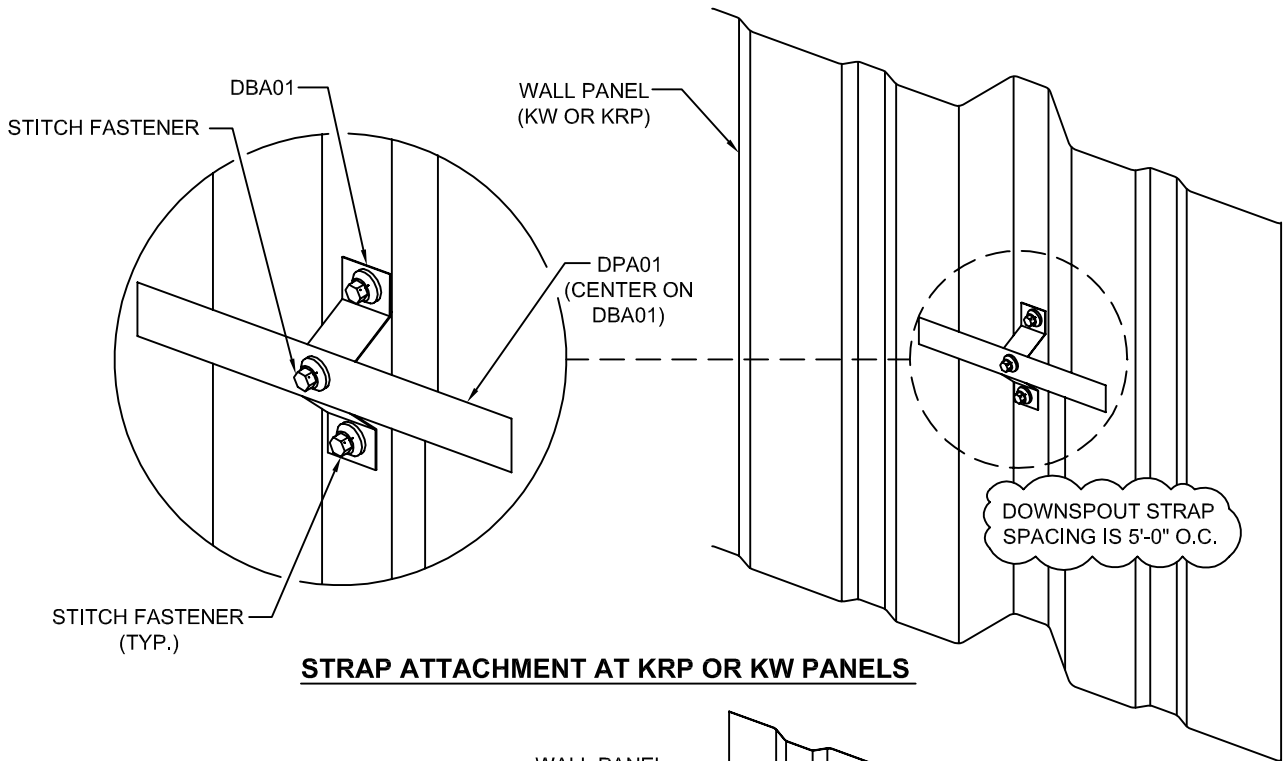
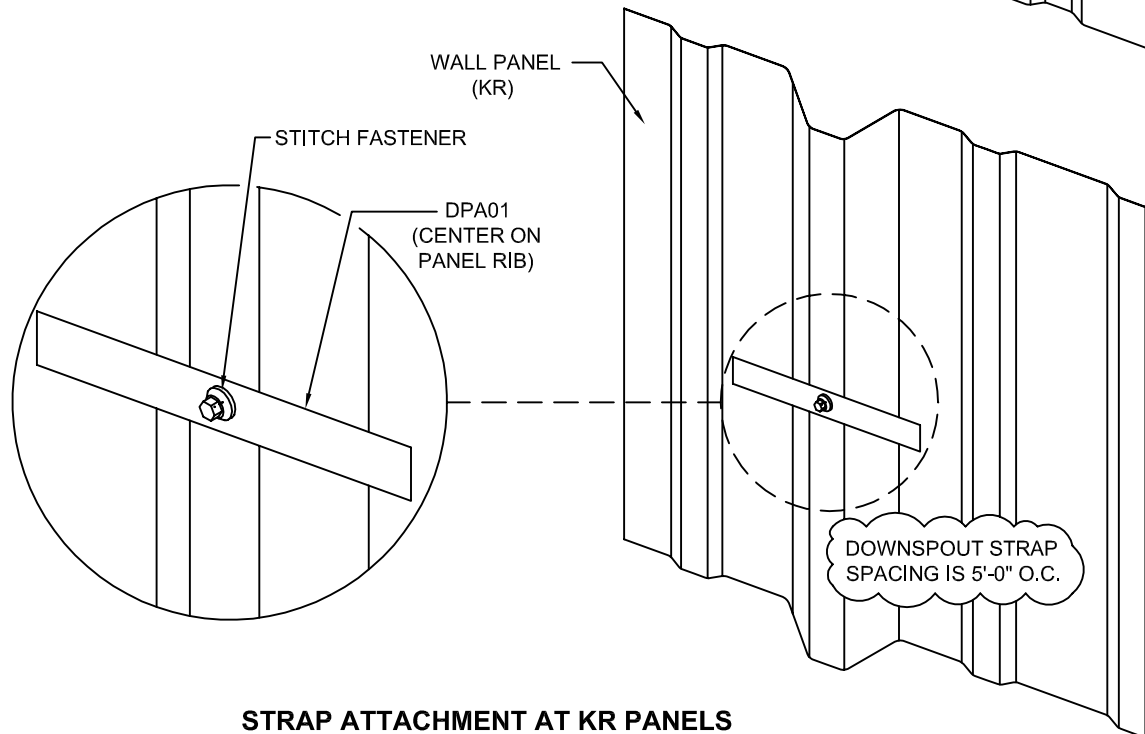
**STRAP ATTACHMENT AT KRP OR KW PANELS****STRAP ATTACHMENT AT KR PANELS**GA0082 **K**

STANDARD DOWNSPOUT STRAP INSTALLATION

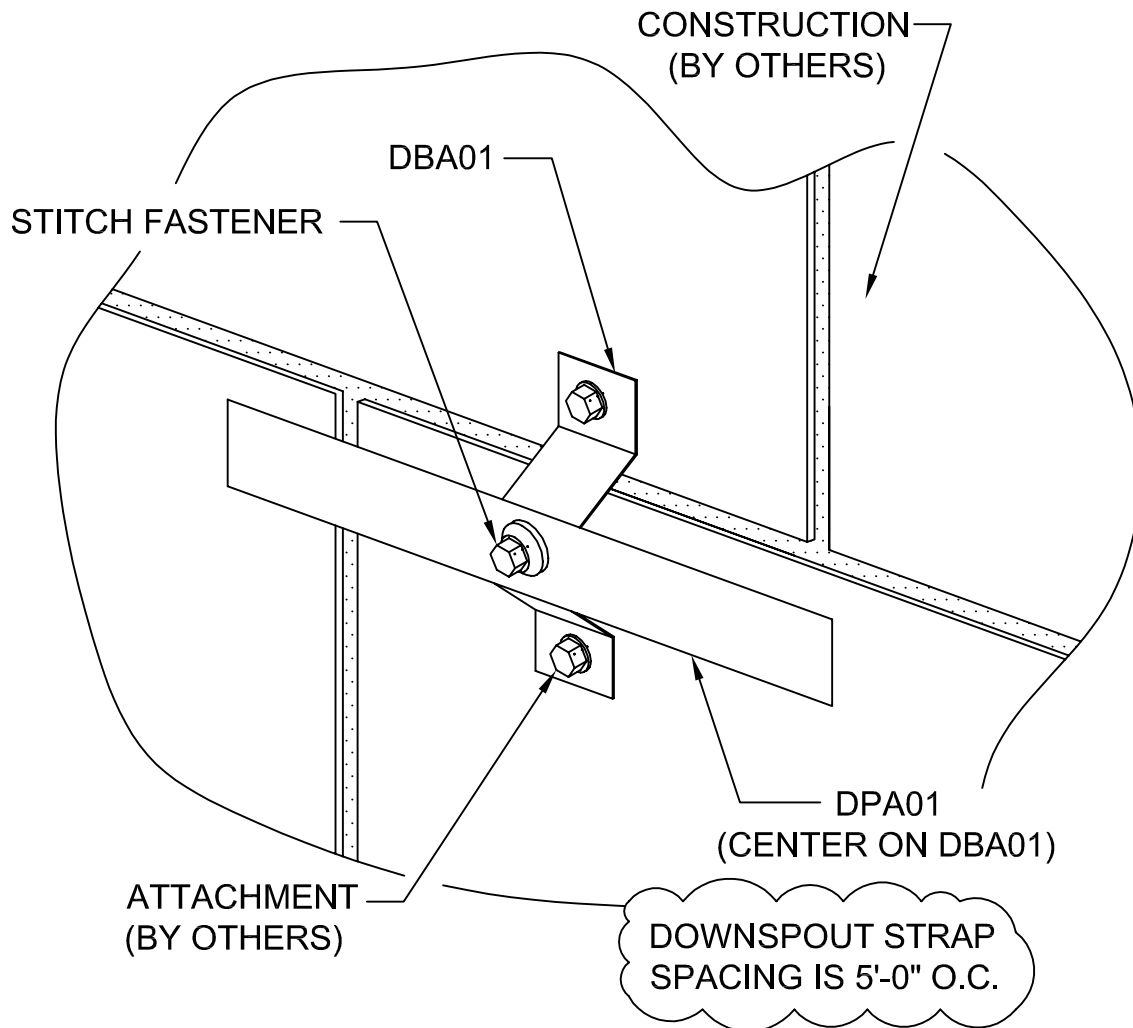
**GA1082 K****DOWNSPOUT STRAP ATTACHMENT AT CONSTRUCTION
(BY OTHERS)**

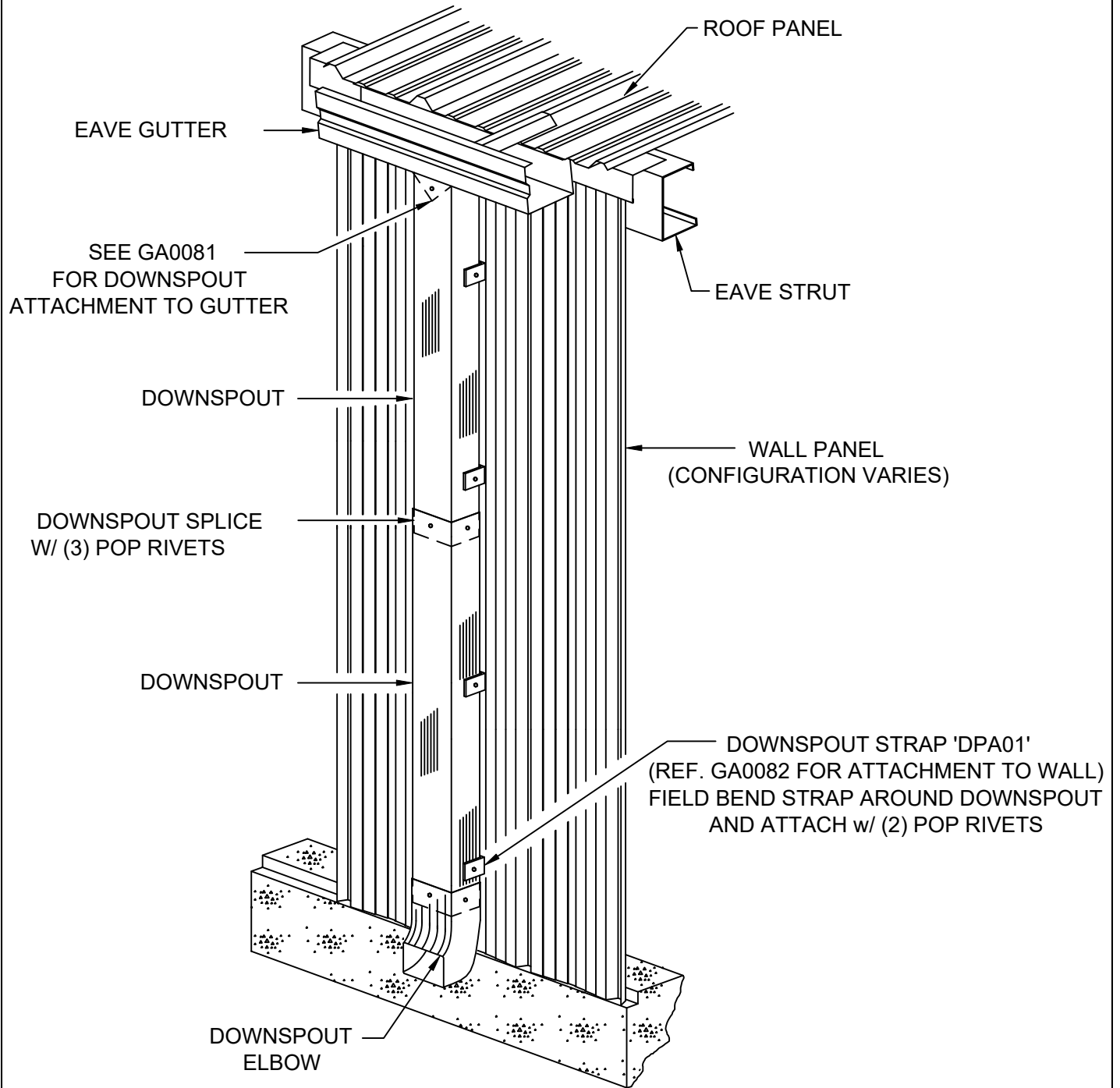
**GA0085 K**

STANDARD DOWNSPOUT LAYOUT
WITH FULL HEIGHT WALL PANEL

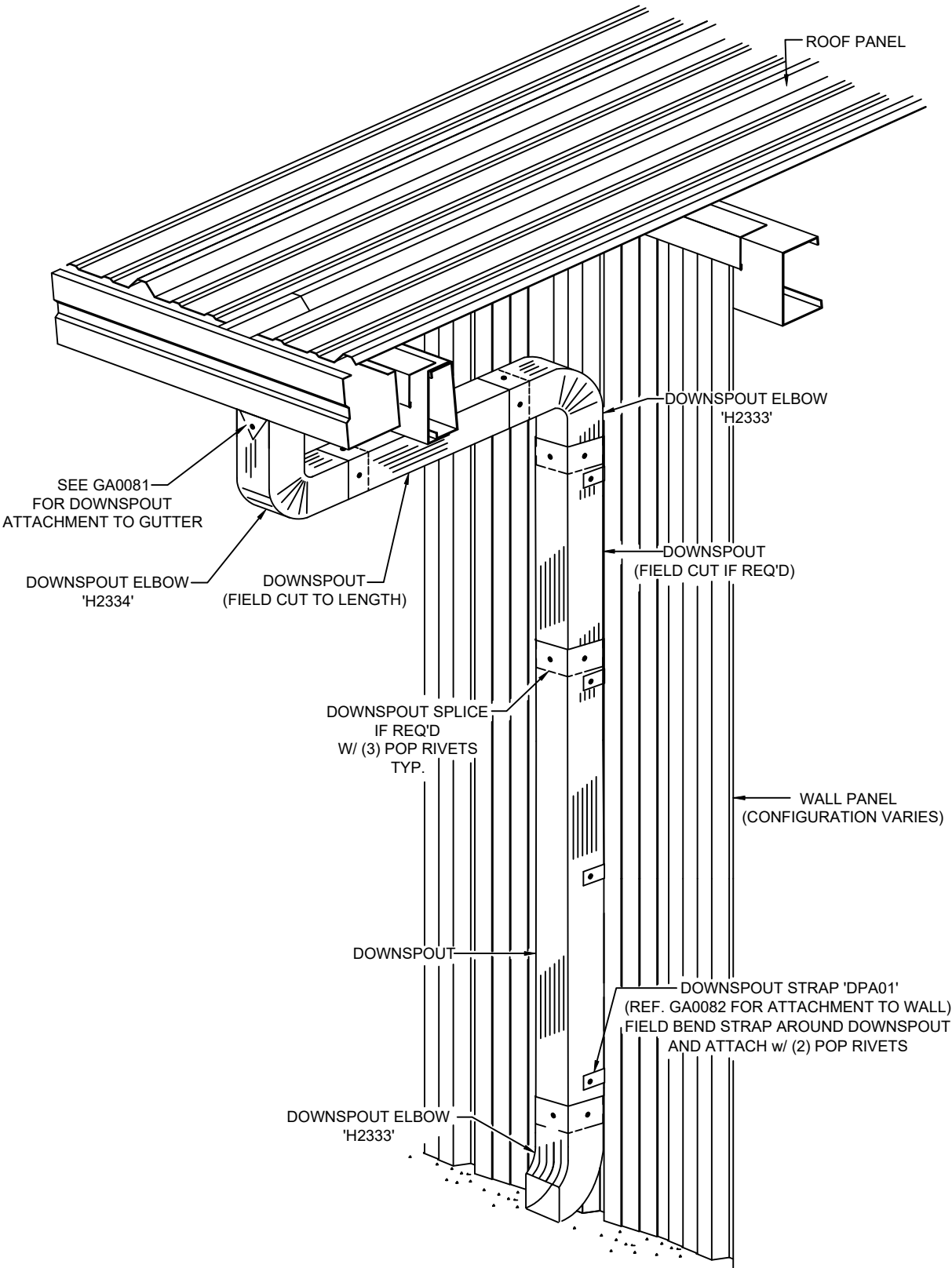

GA0185 **K**

STANDARD DOWNSPOUT RETURN



KIRBY
BUILDING
SYSTEMS

A NUCOR COMPANY

BETTER SOLUTIONS. BETTER BUILDINGS.

PREPARED BY: BKC

DATE: 4-21-20

GA0185

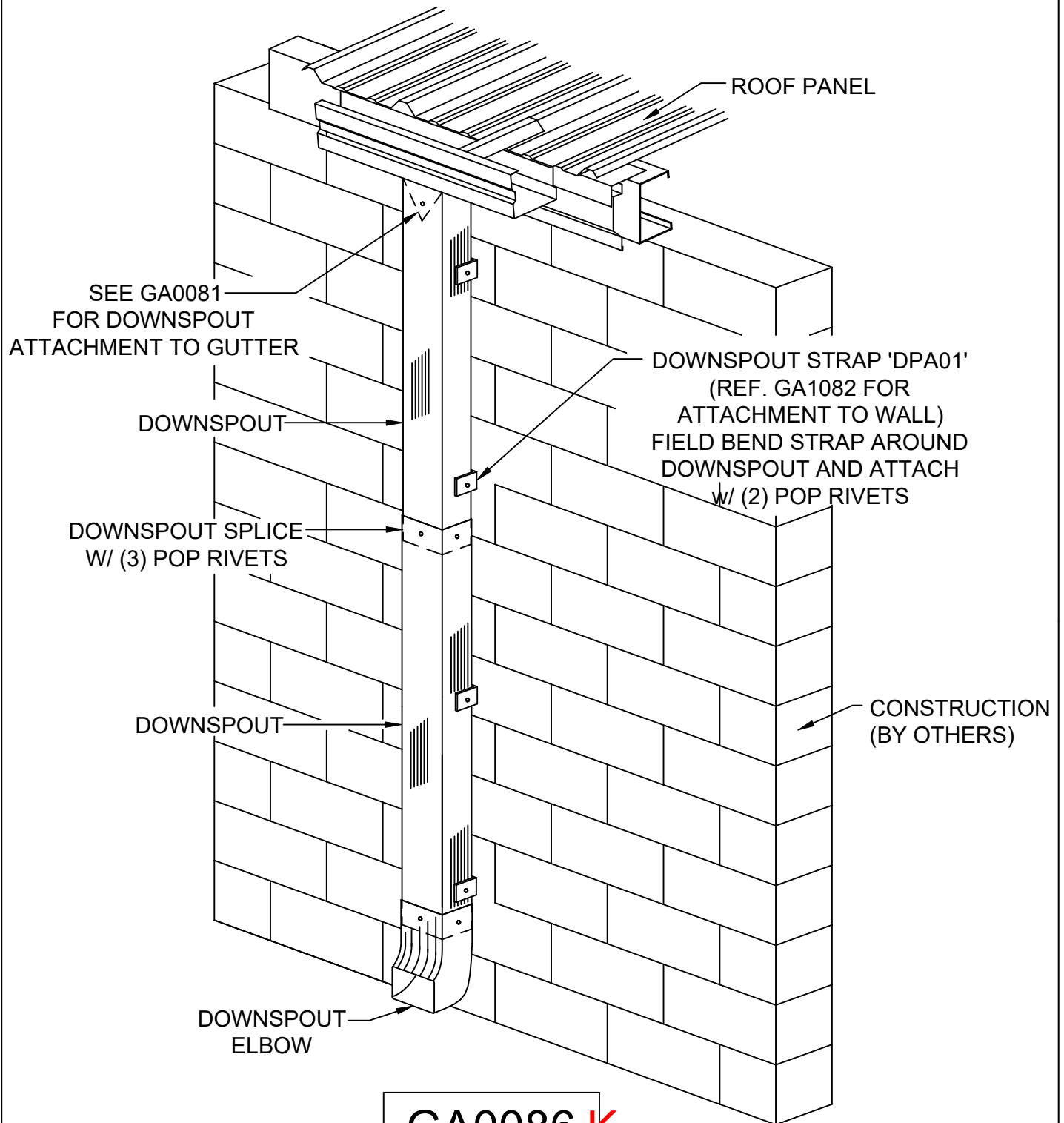
GA0086 **K**

**STANDARD DOWNSPOUT LAYOUT
WITH FULL HEIGHT CONSTRUCTION (BY OTHERS)**



**KIRBY
BUILDING
SYSTEMS**

A NUDOR COMPANY

BETTER SOLUTIONS. BETTER BUILDINGS.

PREPARED BY: BKC

DATE: 4-21-20

GA0086

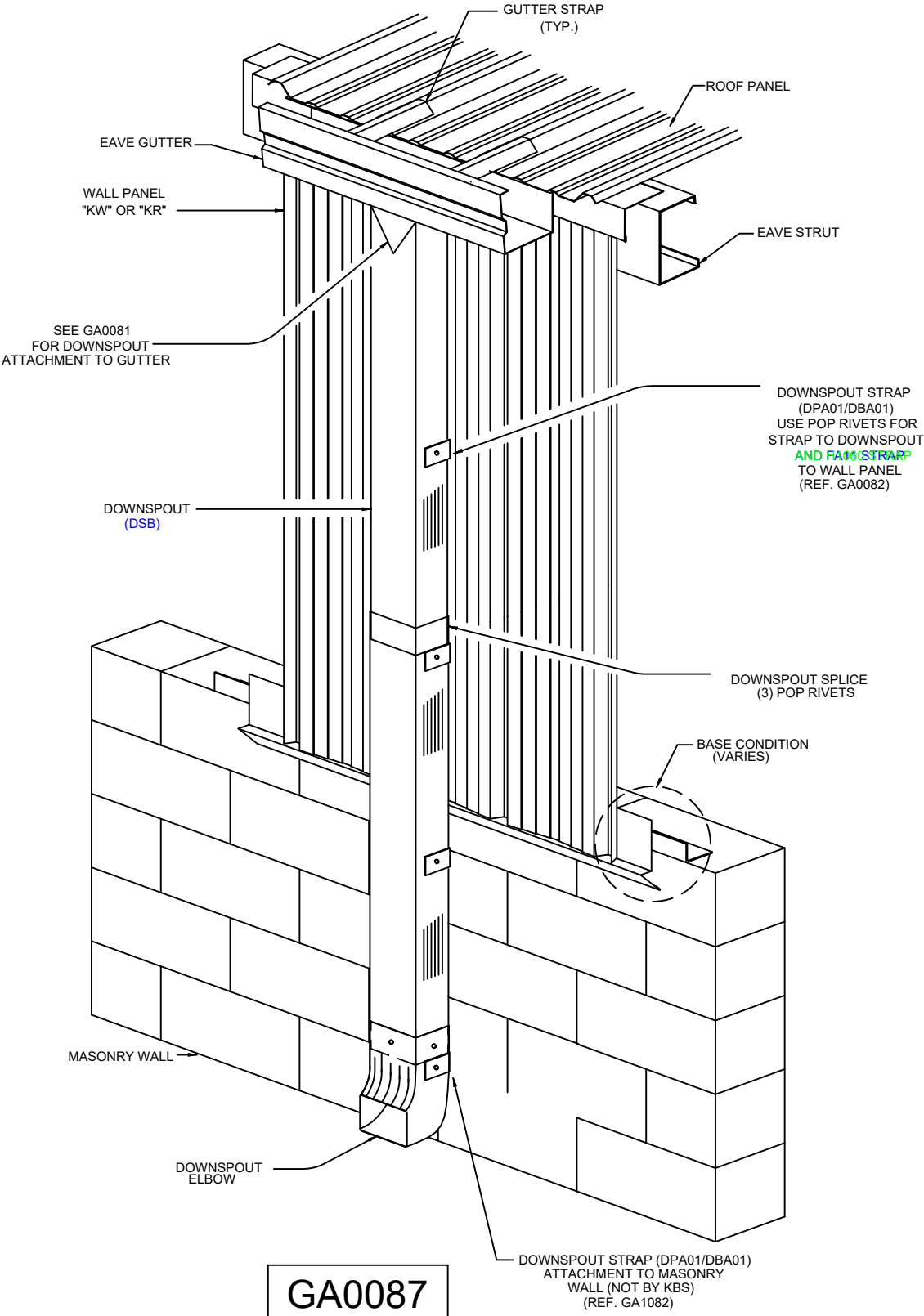

GA0087

STANDARD DOWNSPOUT LAYOUT
PARTIAL SHEETED WALL AND OPEN BELOW FOR MASONRY WALL

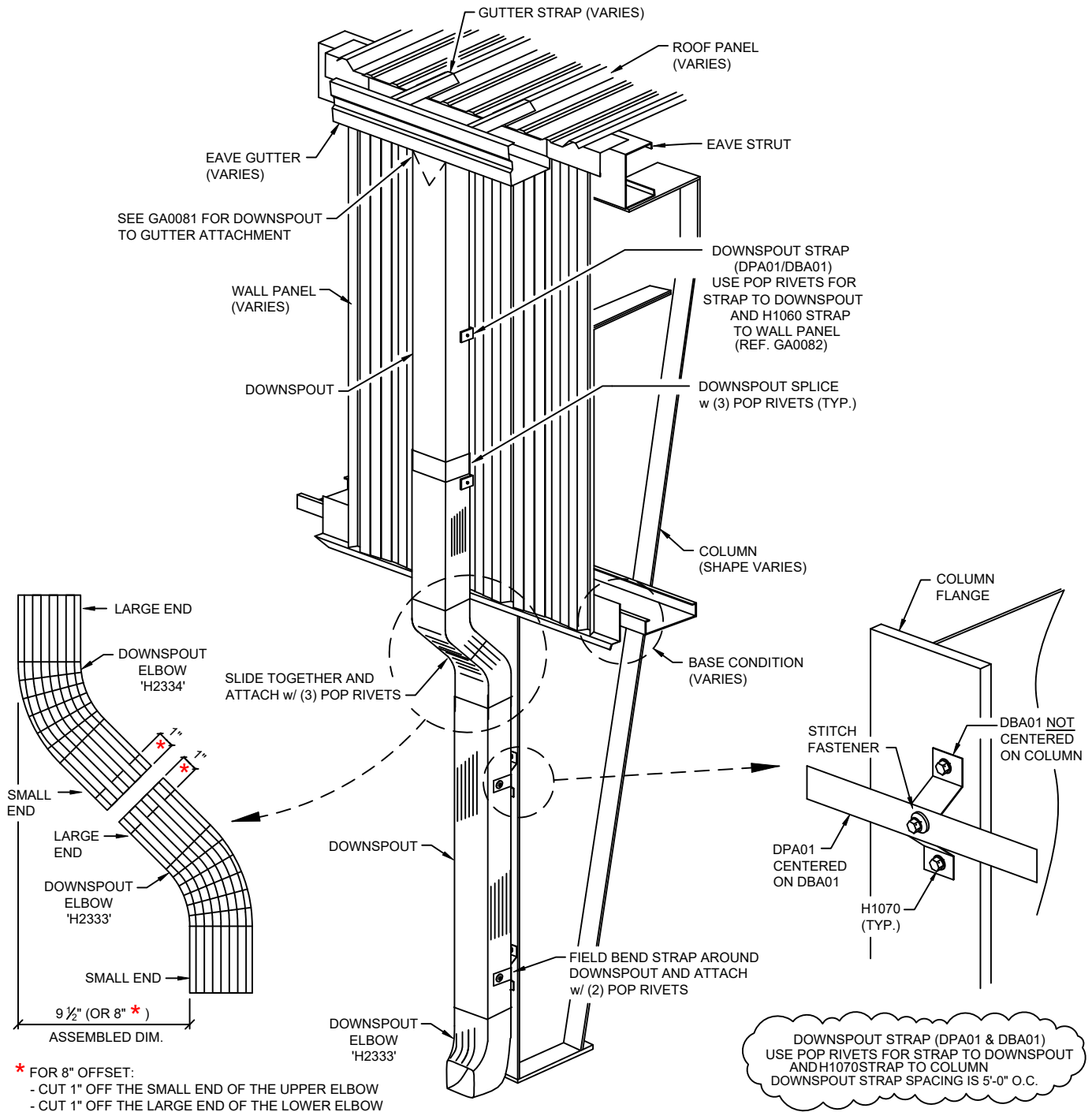

GA0187

STANDARD DOWNSPOUT LAYOUT
W/ PARTIAL SHEETED WALL, OPEN BELOW (BY-FRAME)

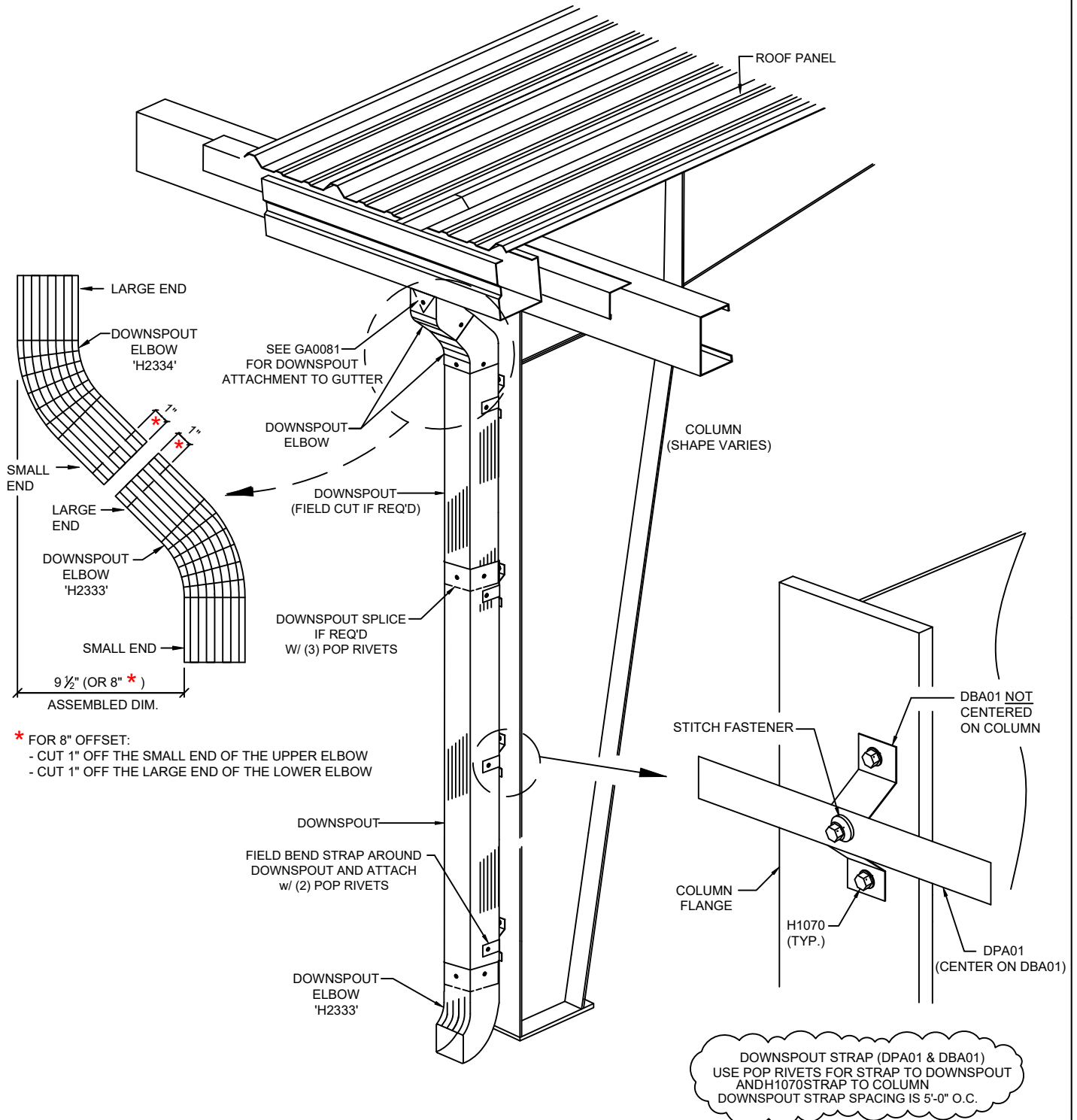

GA0089

STANDARD DOWNSPOUT LAYOUT WITH OPEN SIDEWALL (BY-FRAME)

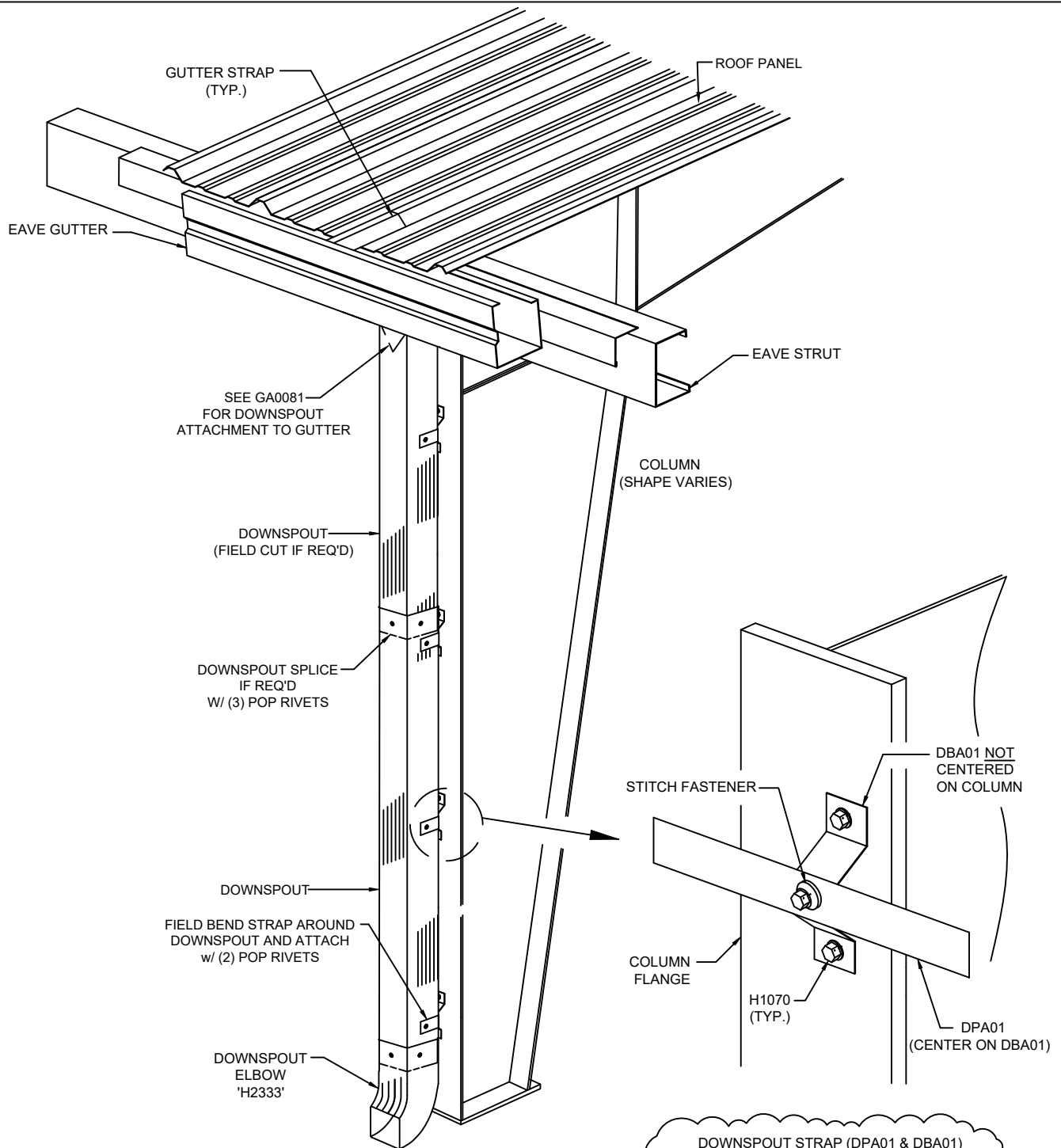

DOWNSPOUT STRAP (DPA01 & DBA01)
USE POP RIVETS FOR STRAP TO DOWNSPOUT
AND H1070 STRAP TO COLUMN
DOWNSPOUT STRAP SPACING IS 5'-0" O.C.

GA0189

STANDARD DOWNSPOUT LAYOUT WITH OPEN SIDEWALL (FLUSH)

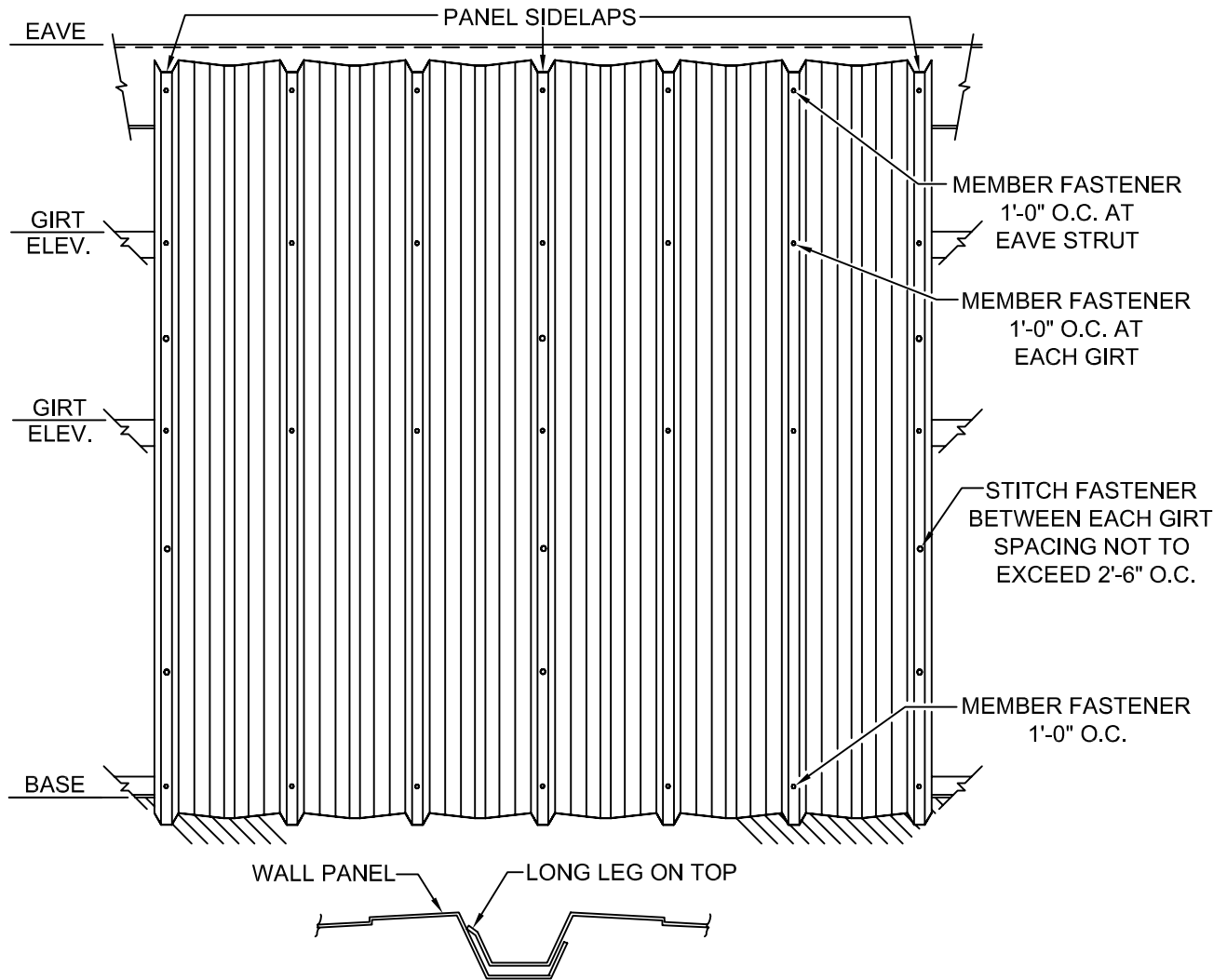

SIDELAP DETAIL

GENERAL NOTES:

1. BLOCK GIRTS TO "LEVEL" POSITION BEFORE STARTING PANEL ERECTION. MAINTAIN BLOCKING UNTIL MEMBER FASTENERS ARE INSTALLED.
2. MEASURE AND MARK 36" O.C. BEGINNING AT PANEL START DIMENSION (REFERENCE SHEETING ELEVATION ON ERECTION DRAWINGS). USE THESE MARKS TO INSURE PANEL COVERAGE IS MAINTAINED DURING INSTALLATION.
3. ALIGN AND PLUMB FIRST WALL PANEL.
4. REFER TO DRAWING 'C1' FOR MEMBER AND STITCH FASTENER REQUIREMENTS.
5. TO PREVENT "OIL-CANNING", ALL PANEL FASTENING SHOULD START FROM BASE AND SECURED TO EACH GIRT TOWARD EAVE.
6. WALL PANELS MUST BE CLEANED AT THE END OF WORK DAY. ANY METAL SHAVINGS SHOULD BE REMOVED IN SUCH A MANNER AS TO PREVENT DAMAGE TO THE PANELS.

GA0101 **K**

TYPICAL KIRBYWALL INSTALLATION

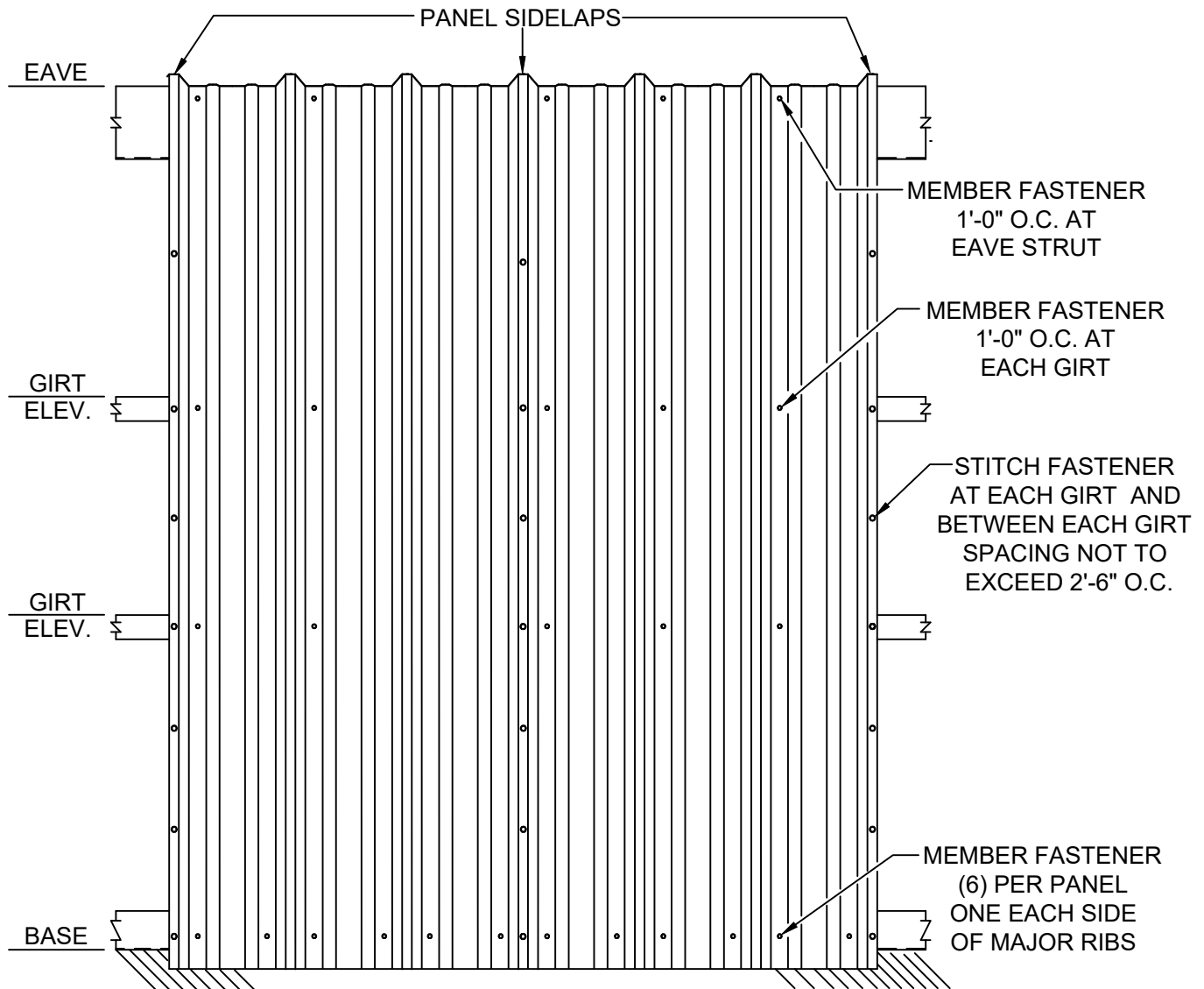

GENERAL NOTES:

1. BLOCK GIRTS TO "LEVEL" POSITION BEFORE STARTING PANEL ERECTION. MAINTAIN BLOCKING UNTIL MEMBER FASTENERS ARE INSTALLED.
2. MEASURE AND MARK 36" O.C. BEGINNING AT THE STEEL LINE(UNLESS NOTED ON THE ERECTION DRAWINGS). USE THESE MARKS TO INSURE PANEL COVERAGE IS MAINTAINED DURING INSTALLATION.
3. ALIGN AND PLUMB FIRST WALL PANEL.
4. REFER TO DRAWING 'C1' FOR MEMBER AND STITCH FASTENER REQUIREMENTS.
5. TO PREVENT "OIL-CANNING", ALL PANEL FASTENING SHOULD START FROM BASE AND SECURED TO EACH GIRT TOWARD EAVE.

GA0201 K

TYPICAL KIRBYRIB WALL INSTALLATION

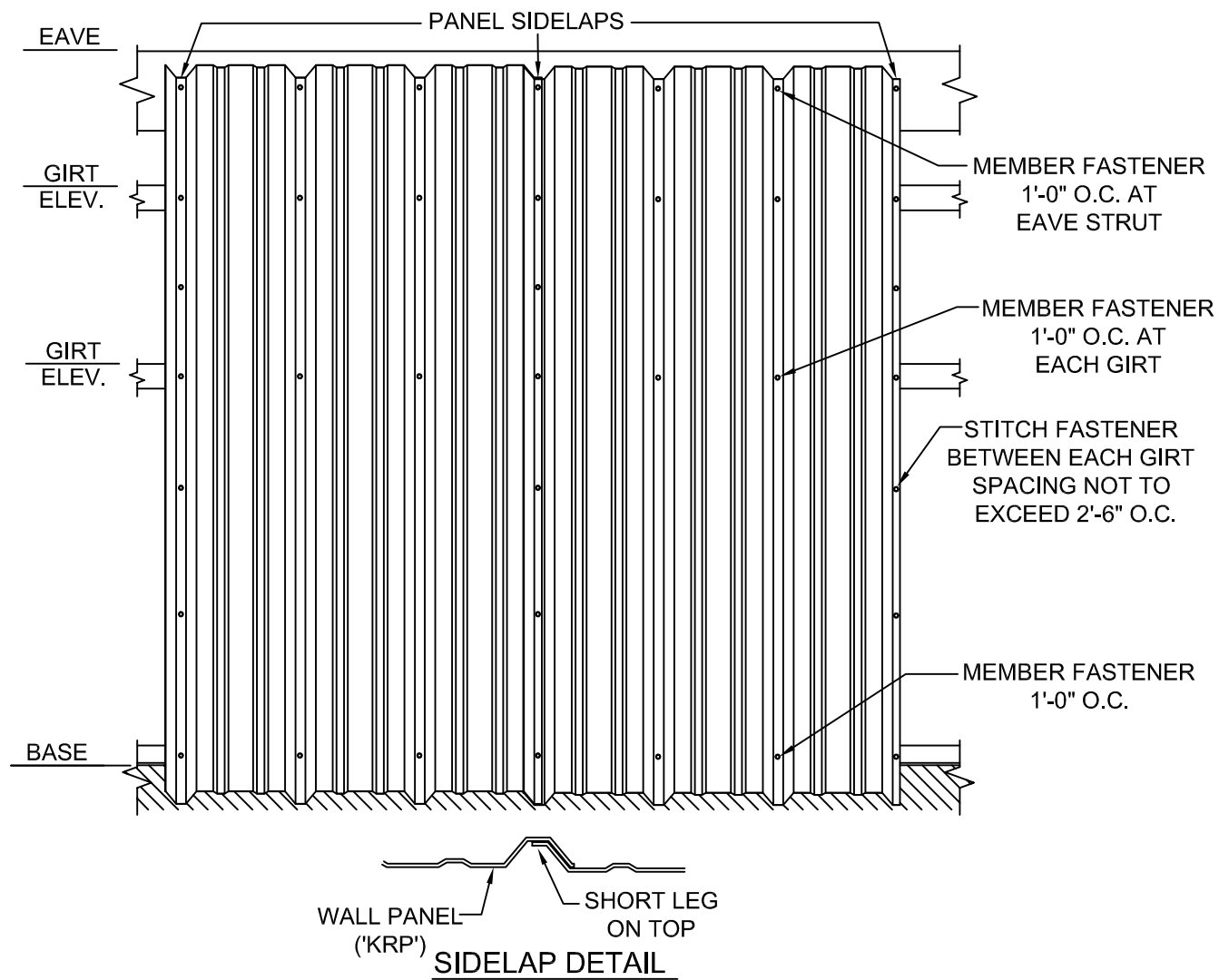

GENERAL NOTES:

1. BLOCK GIRTS TO "LEVEL" POSITION BEFORE STARTING PANEL ERECTION. MAINTAIN BLOCKING UNTIL MEMBER FASTENERS ARE INSTALLED.
2. MEASURE AND MARK 36" O.C. BEGINNING AT PANEL START DIMENSION (REFERENCE SHEETING ELEVATION ON ERECTION DRAWINGS). USE THESE MARKS TO INSURE PANEL COVERAGE IS MAINTAINED DURING INSTALLATION.
3. ALIGN AND PLUMB FIRST WALL PANEL.
4. REFER TO DRAWING 'C1' FOR MEMBER AND STITCH FASTENER REQUIREMENTS.
5. TO PREVENT "OIL-CANNING", ALL PANEL FASTENING SHOULD START FROM BASE AND SECURED TO EACH GIRT TOWARD EAVE.
6. WALL PANELS MUST BE CLEANED AT THE END OF WORK DAY. ANY METAL SHAVINGS SHOULD BE REMOVED IN SUCH A MANNER AS TO PREVENT DAMAGE TO THE PANELS.

GA0301 K

TYPICAL 'KRP' INSTALLATION

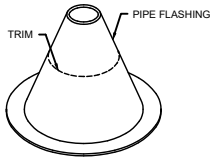

1. TRIM
CUT OPENING 20% SMALLER THAN THE PIPE DIAMETER
OR ALONG THE PIPE DIAMETER MARKINGS ON THE CONE.
LEAVE 1/2" STRAIGHT COLLAR AGAINST PIPE FOR MAXIMUM SEALING.

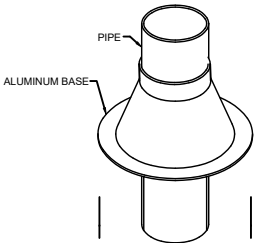

2. SLIDE
SLIDE PIPE FLASHING OVER PIPE TO BE FLASHED.
MAKE SURE AREA IS CLEANED FIRST AND THE PIPE HAS
NO SHARP EDGES THAT WOULD DAMAGE THE FLEXIBLE MEMBRANE.
WATER MAY BE USED AS LUBRICANT IF NECESSARY.

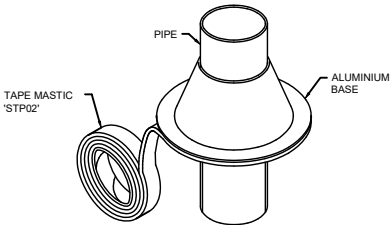

3. SEAL
APPLY TAPE MASTIC TO THE UNDERSIDE OF
THE ALUMINIUM BASE.

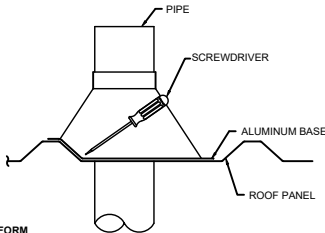

4. FORM
BEND ALUMINIUM BASE TO CONTOURS OF THE ROOF PANEL.
A LARGE SLOT SCREWDRIVER OR SIMILAR BLUNT TOOL MAY
BE USED TO PRESS THE BASE INTO TIGHT AREAS.

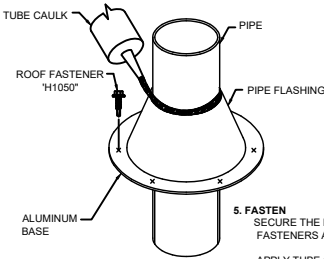

5. FASTEN
SECURE THE PIPE FLASHING TO THE ROOF PANEL WITH H1050
FASTENERS APPROXIMATELY 2" O.C. AROUND BASE PERIMETER
APPLY TUBE CAULK FOR WATER TIGHT SEAL .

GA0601

DEKITE INSTALLATION