

EG8001 - Outside Closure Installation

EG8011 - Ridge Detail

EG8111 - Ridge Detail w/ Insulation Pan

EG8031 - Insulation Pan with Joist

EG8041 - Expansion Peak Box Installation

EG8051 - Ridge Cap Closure Installation

**Universal Peak Box Installation**

EG8950 - Standard Peak Box Installation

EG8990 - Floating Peak Box Installation

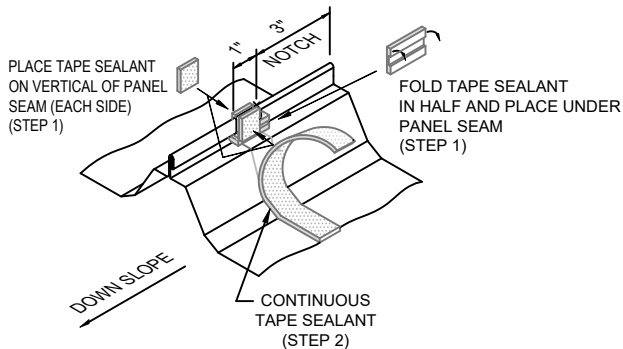

- STEP 1.** FOLD 1 1/2" LONG PIECE OF 3/16" x 7/8" TAPE SEALANT IN HALF AND PLACE ALONG RIB UNDER PANEL SEAM (AS SHOWN). PLACE TWO MORE PIECES OF SEALANT ALONG VERTICAL OF PANEL SEAM (STEP 1)
- STEP 2.** INSTALL 3/16" x 7/8" TAPE SEALANT ACROSS PANEL FLAT AND **OVER** PANEL RIB AND PREVIOUS SEALANT, LOCATED 1" DOWNHILL OF THE NOTCH.

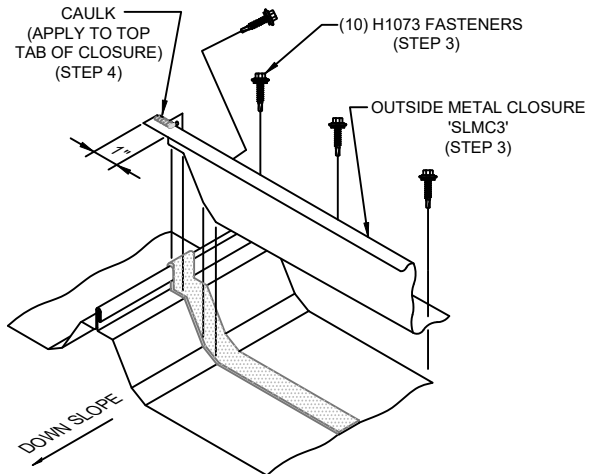

- STEP 3.** INSTALL METAL CLOSURE FLUSH WITH EDGE OF SEALANT SECURE IN PLACE WITH (10) H1073 FASTENERS.  
(1) FASTENER AT BASE OF TRAPEZOID. (1) FASTENER EACH SIDE OF THE MINOR RIBS. (OMIT FASTENERS IN THE 2 CENTER PRE-PUNCHED HOLES.)  
(1) FASTENER THRU THE PRE-PUNCHED HOLES INTO EACH TRAPEZOID.
- STEP 4.** APPLY 1" LONG URETHANE CAULK ALONG TOP TAB OF METAL CLOSURE. THIS IS TO ENSURE SEAL OF NEXT LAPPING METAL CLOSURE.

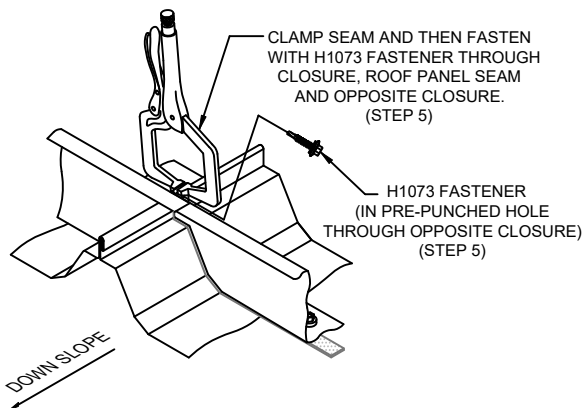

- STEP 5.** INSTALL NEXT CLOSURE SAME AS THE FIRST. CLAMP THE TWO METAL CLOSURES TOGETHER AT SEAM AND INSTALL (1) H1073 FASTENER THROUGH HOLE AT TOP OF CLOSURE, ROOF PANEL SEAM AND OPPOSITE CLOSURE.

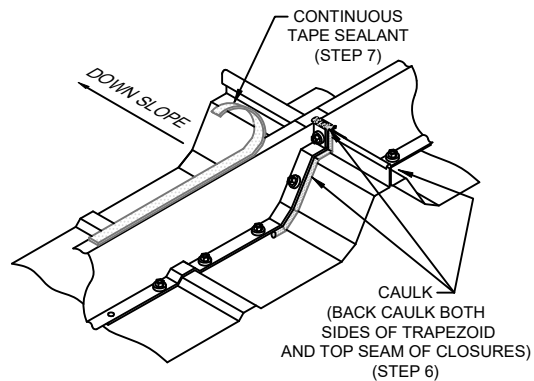

- STEP 6.** APPLY CAULK ALONG BACKSIDE OF METAL CLOSURES AT TRAPEZOIDAL LOCATION. APPLY CAULK ALONG TOP SEAM OF METAL CLOSURES AND PANEL SEAM.
- STEP 7.** AFTER CLOSURE INSTALLATION, APPLY 3/16" x 7/8" TAPE SEALANT ON TOP LEG OF METAL CLOSURE.

EG8001K

SS360 METAL OUTSIDE CLOSURE INSTALLATION

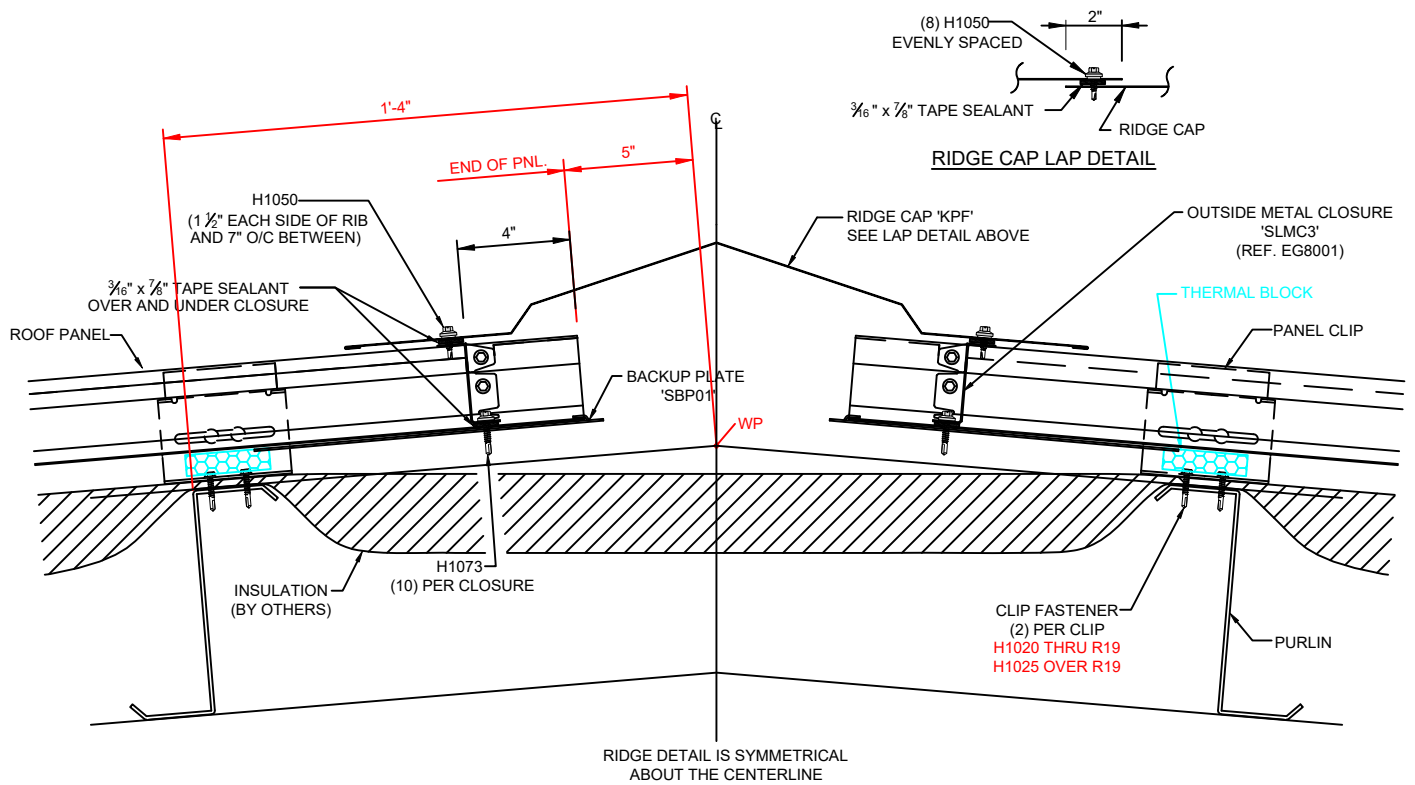

EG8011K

SS360 RIDGE DETAIL

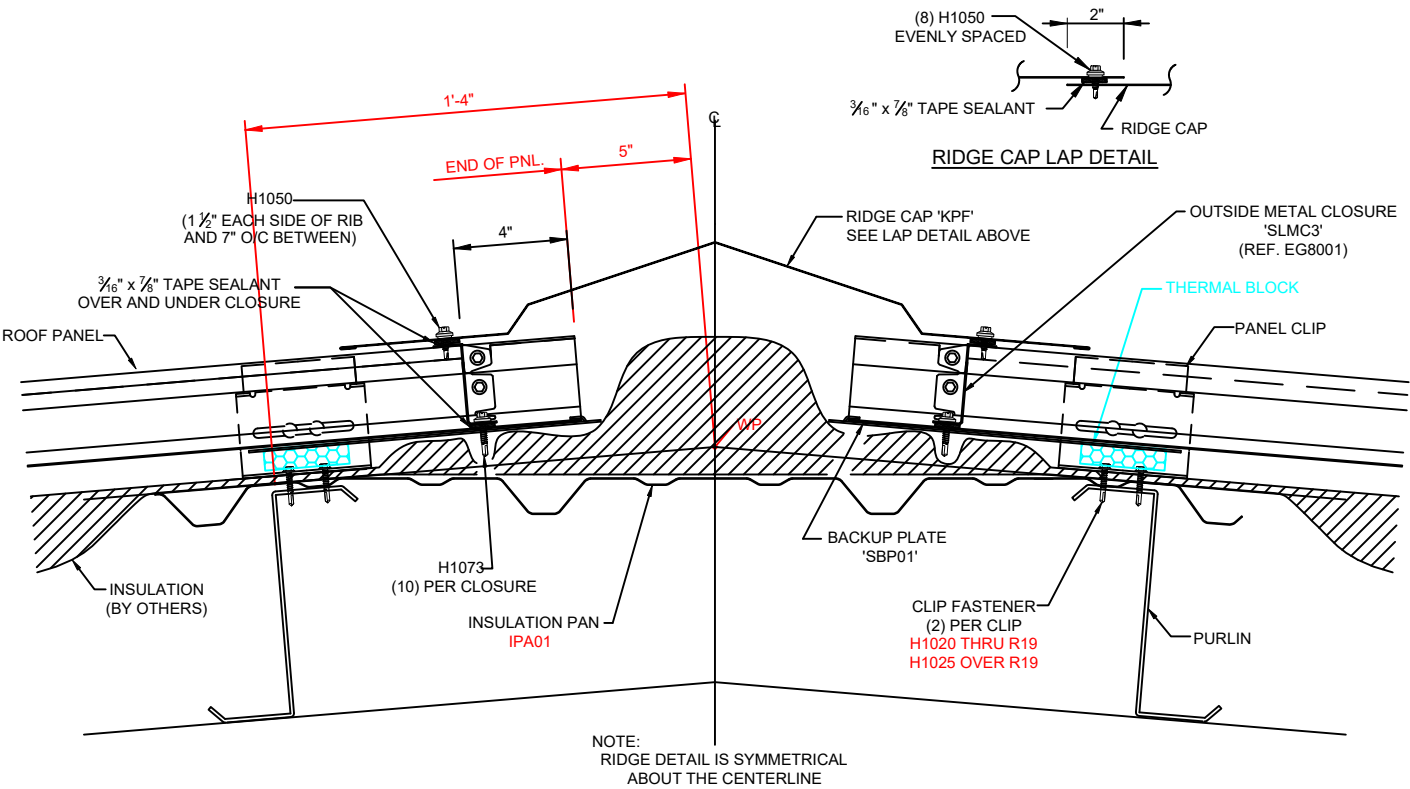

EG8111K

SS360 RIDGE DETAILw/ INSULATION PAN

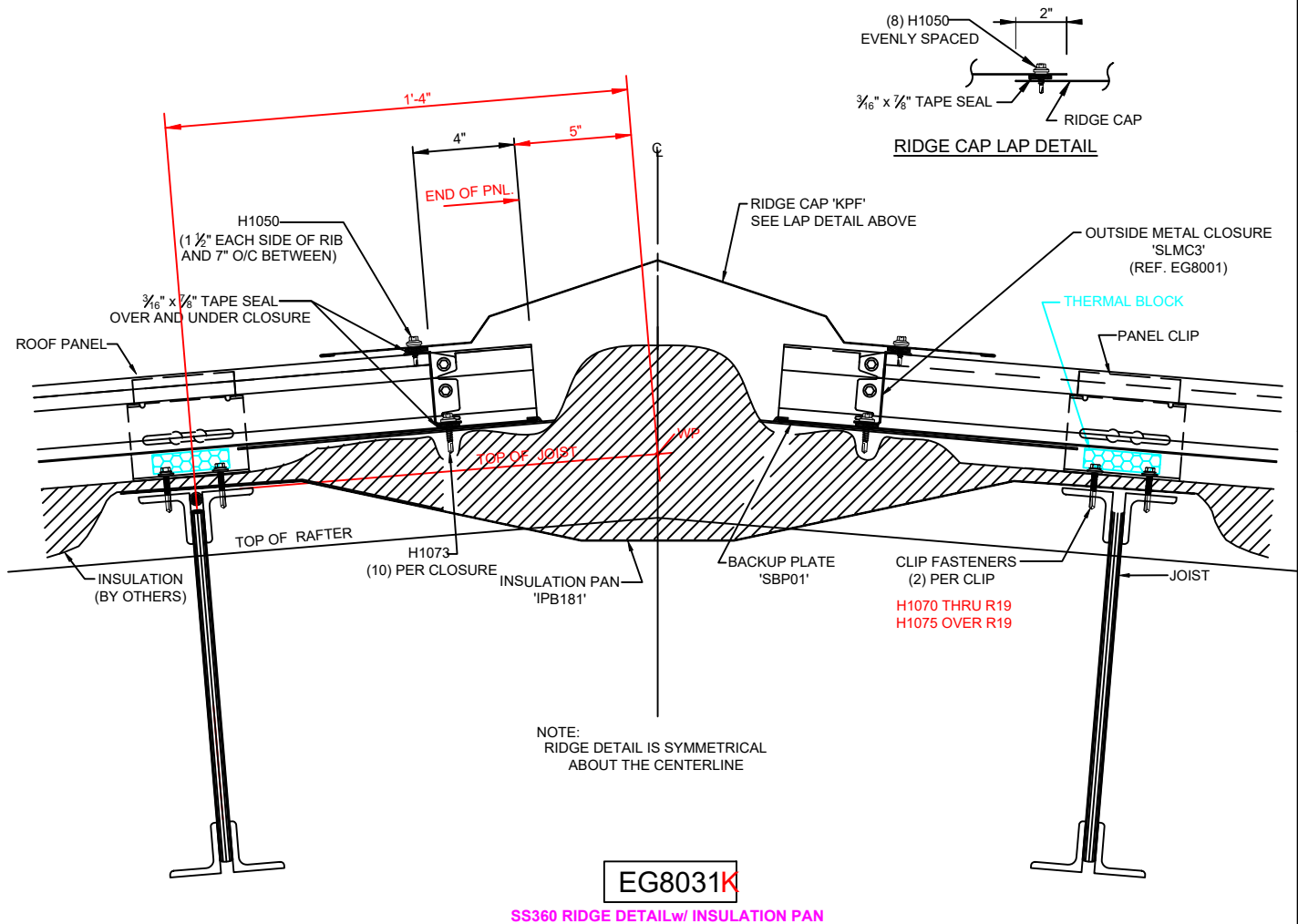

SS360 RIDGE DETAILw/ INSULATION PAN

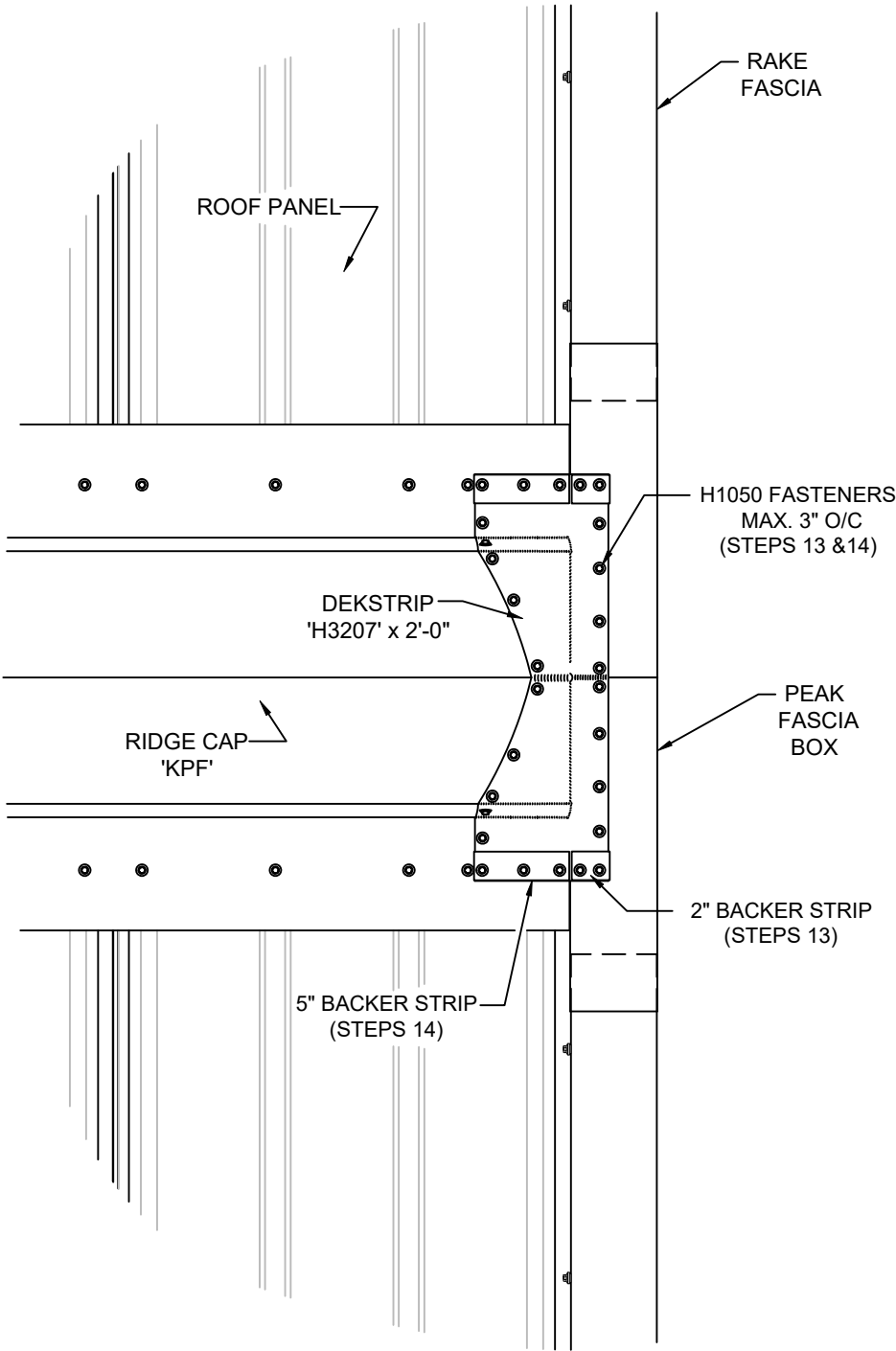

EG8041K

EXPANSION PEAK FASCIA BOX INSTALLATION

USE ON GABLE ROOFS WHERE THE DISTANCE ON EITHER ROOF PLANE FROM THE PINNED POINT TO THE RIDGE  $\geq 100'$

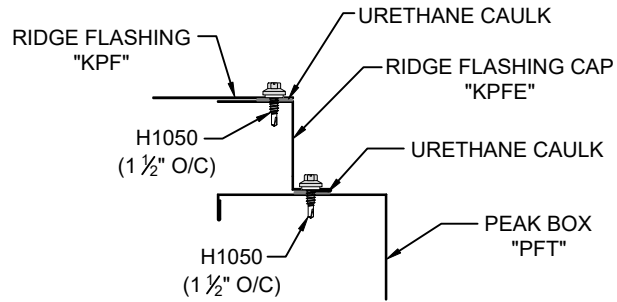

SECTION "A"

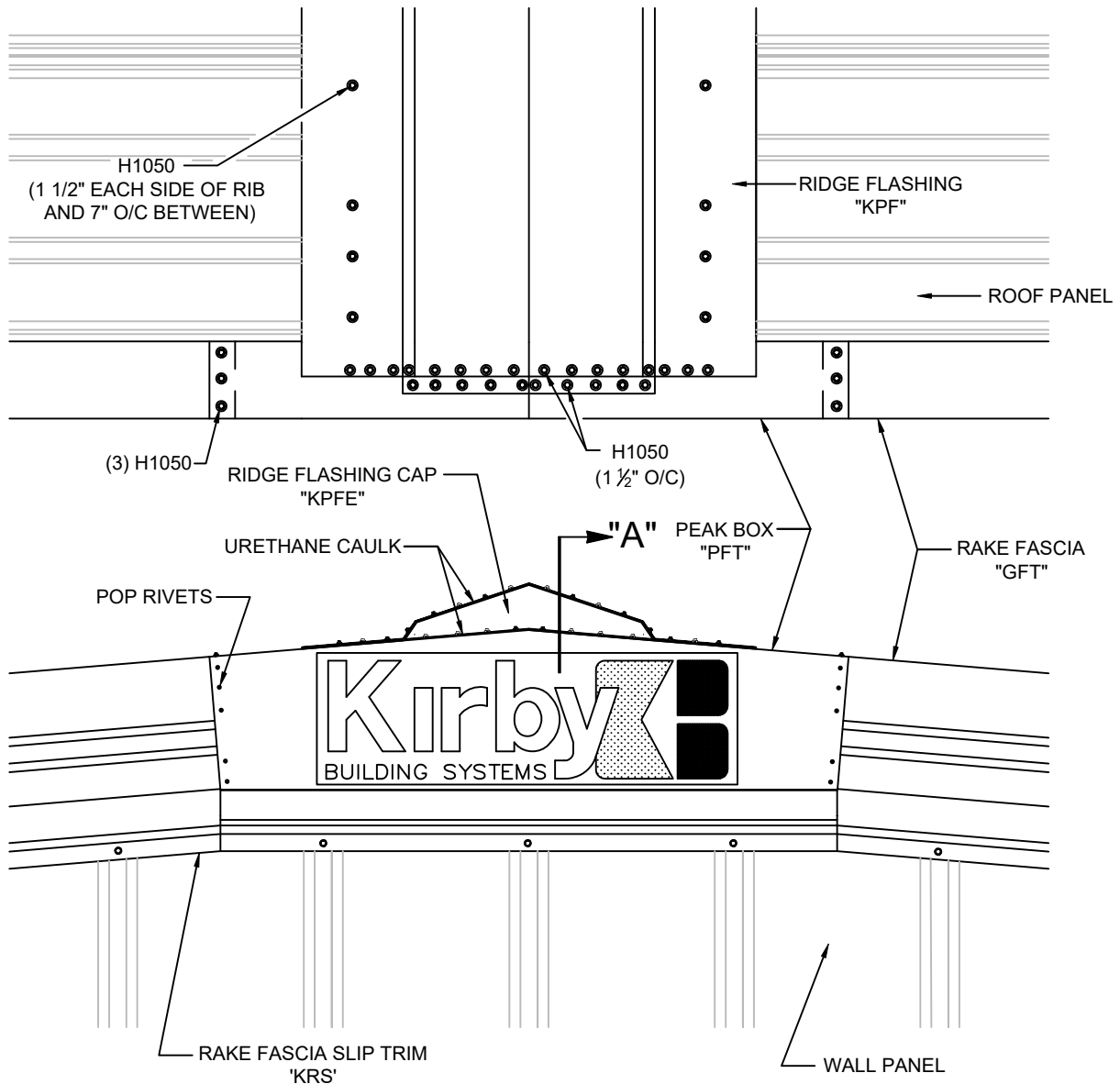

EG8051K

RIDGE CAP CLOSURE INSTALLATION

**EG8950 - STANDARD PEAK BOX INSTALLATION**

[Download the DWG file by clicking here.](#)

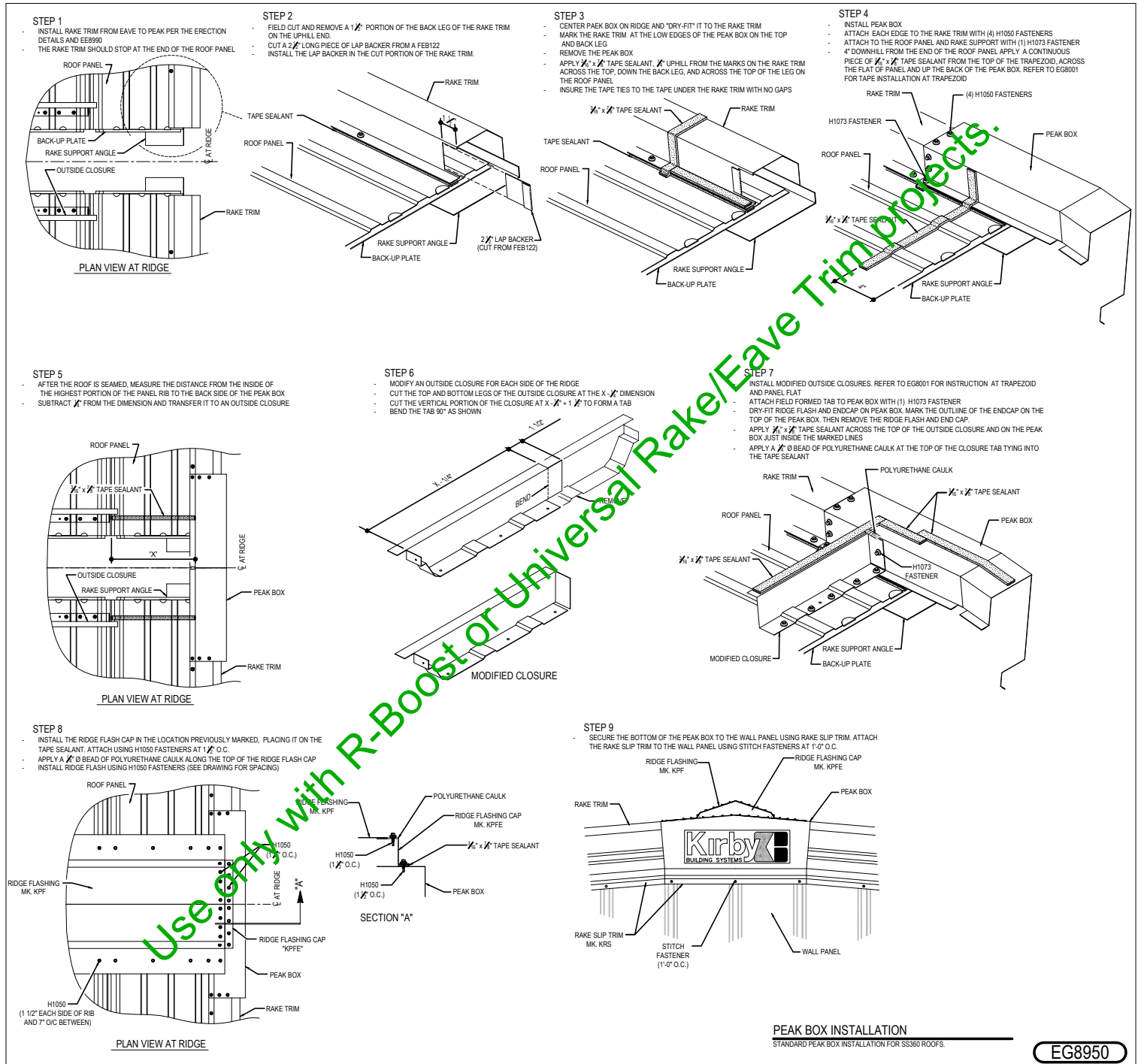

**Detailer Notes:**

- 1) Standard Peak Box installation to be used when the distance on either roof plane does not exceed 100'-0" from the pinned point.



**EG8990 - FLOATING PEAK BOX INSTALLATION**

Download the DWG file by clicking [here](#).

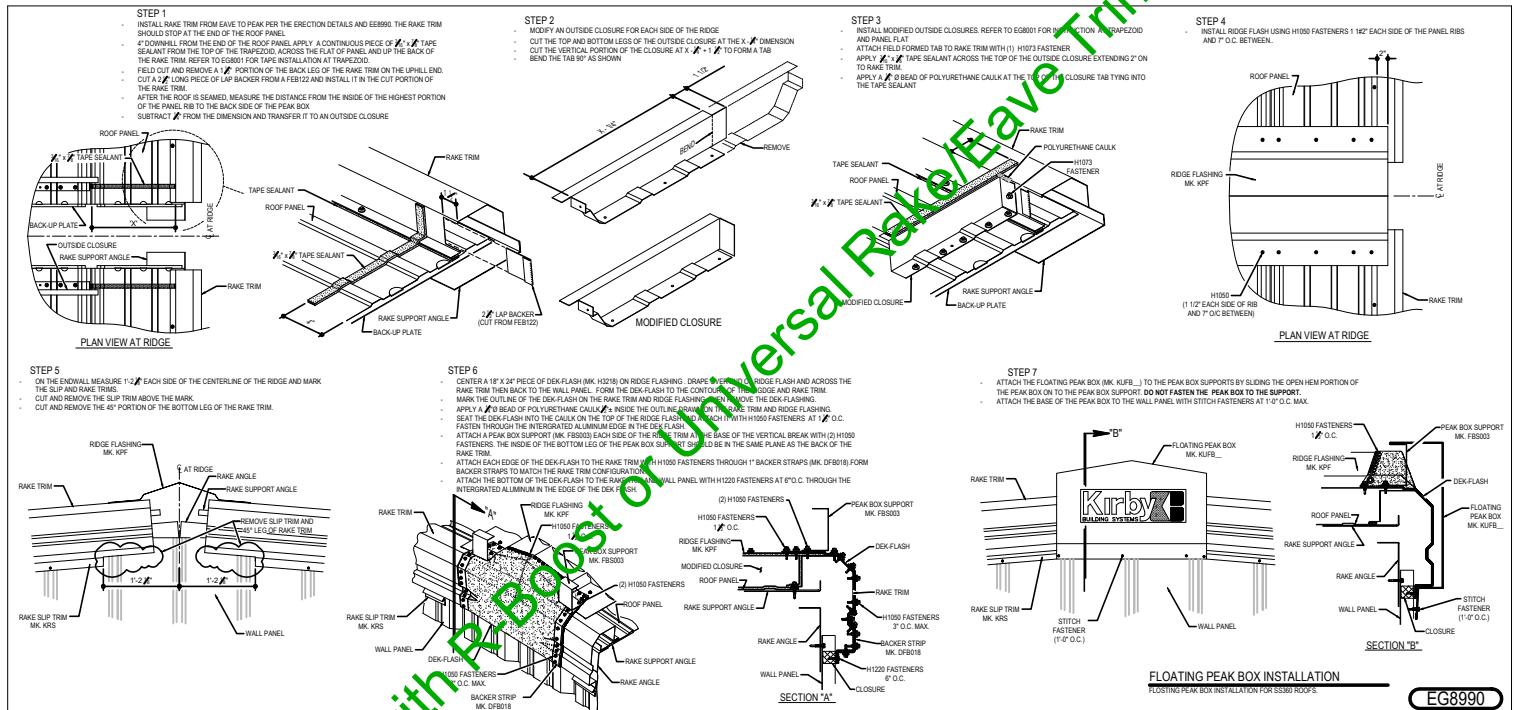

**Detailer Notes:**

- 1) Floating Peak Box installation to be used when the distance on either roof plane exceeds 100'-0" from the pinned point.