

- EF8011 - Panel Above / Open Below
 - EF8111 - Panel Above / Panel Below
 - EF8012 - Panel Above / Open Below / Bend Roof Panel
 - EF8112 - Panel Above / Panel. Below / Bend Roof Panel
 - EF8013 - Panel Above / Open Below / w/ RZ
 - EF8113 - Panel Above / Panel Below / w/ RZ
 - EF8031 - Parapet Const. By Others
 - EF8032 - Parapet Const. By Others / Bend Roof Panel
 - EF8033 - Parapet Const. By Others / w/ RZ
-

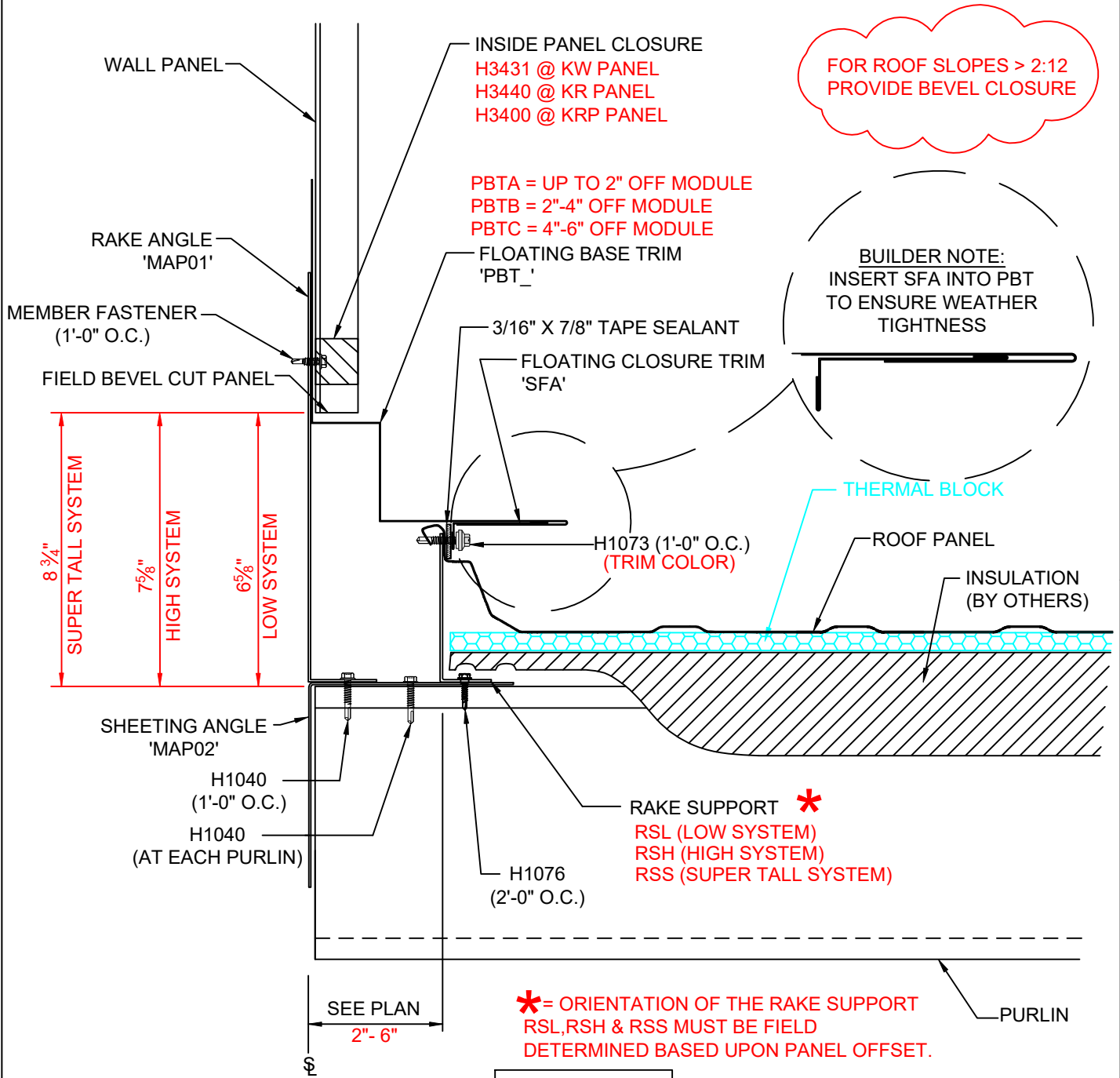

EF8011K

**TRAPEZOIDAL ROOF HIGH/LOW DETAIL
OPEN BELOW**

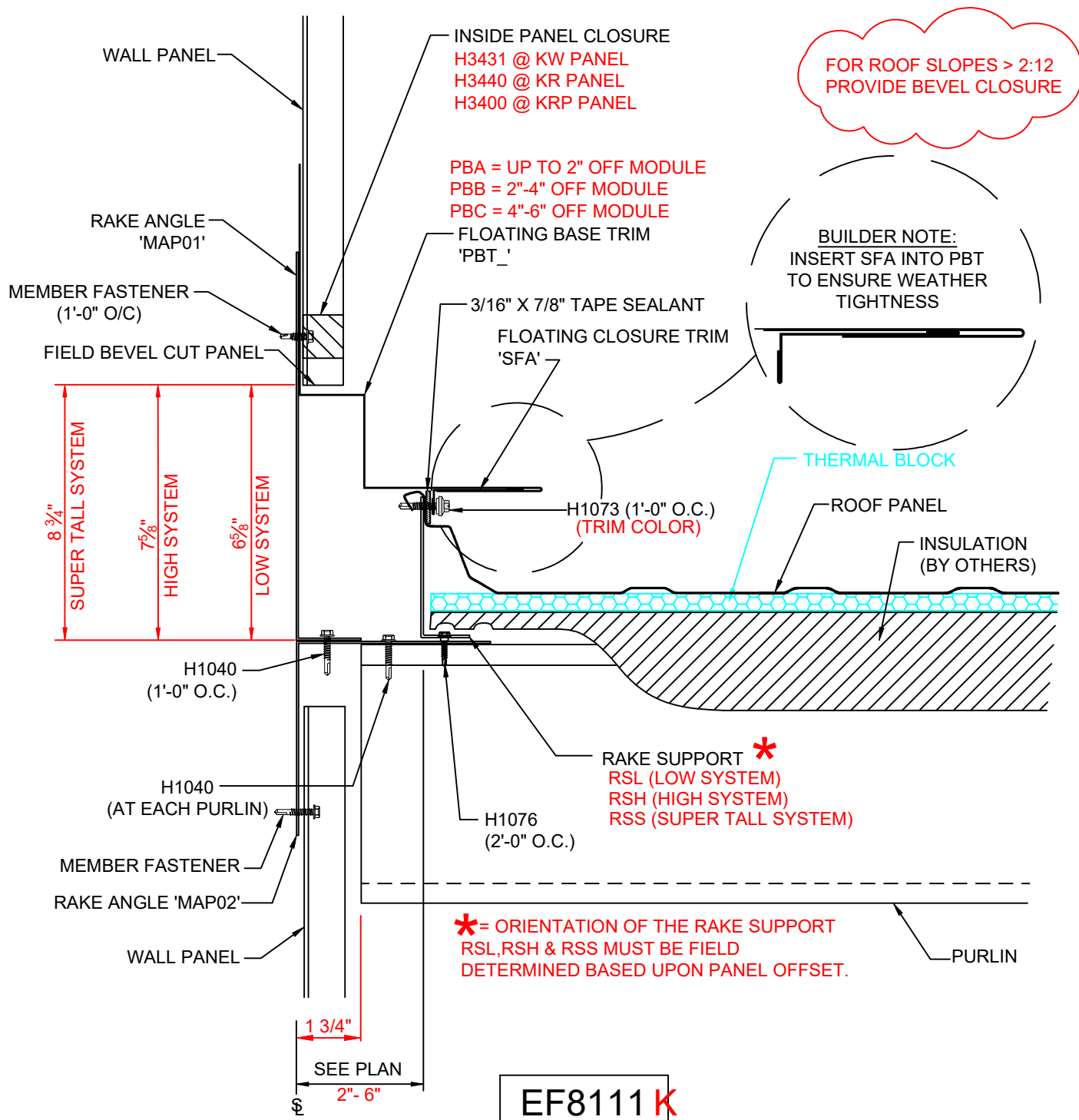

EF8111 K

TRAPEZOIDAL ROOF HIGH/LOW DETAIL
SHEETED BELOW

FOR ROOF SLOPES > 2:12
PROVIDE BEVEL CLOSURE

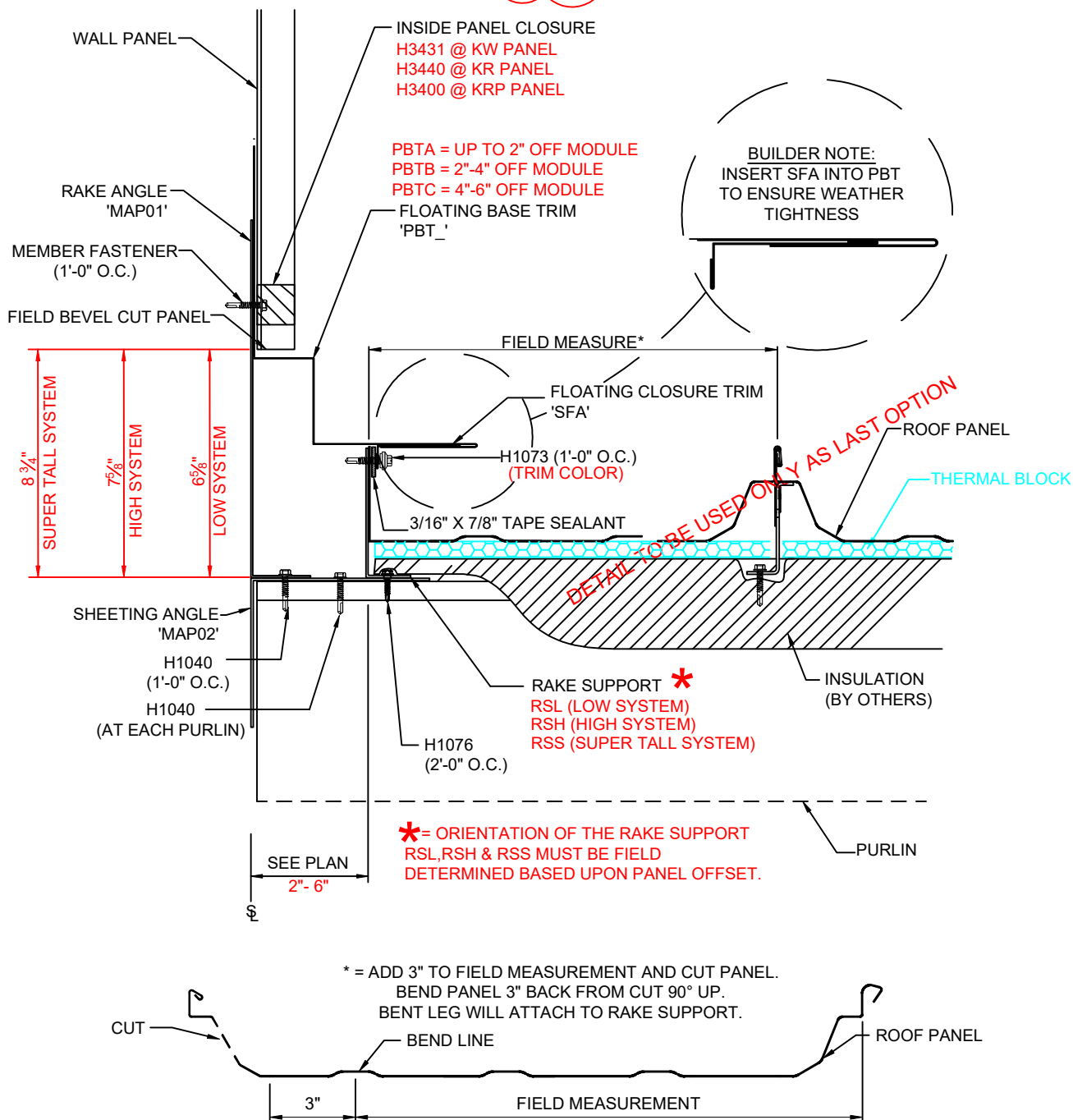

EF8012K

TRAPEZOIDAL ROOF HIGH/LOW DETAIL
OPEN BELOW
FIELD BEND ROOF PANEL

FOR ROOF SLOPES > 2:12
PROVIDE BEVEL CLOSURE

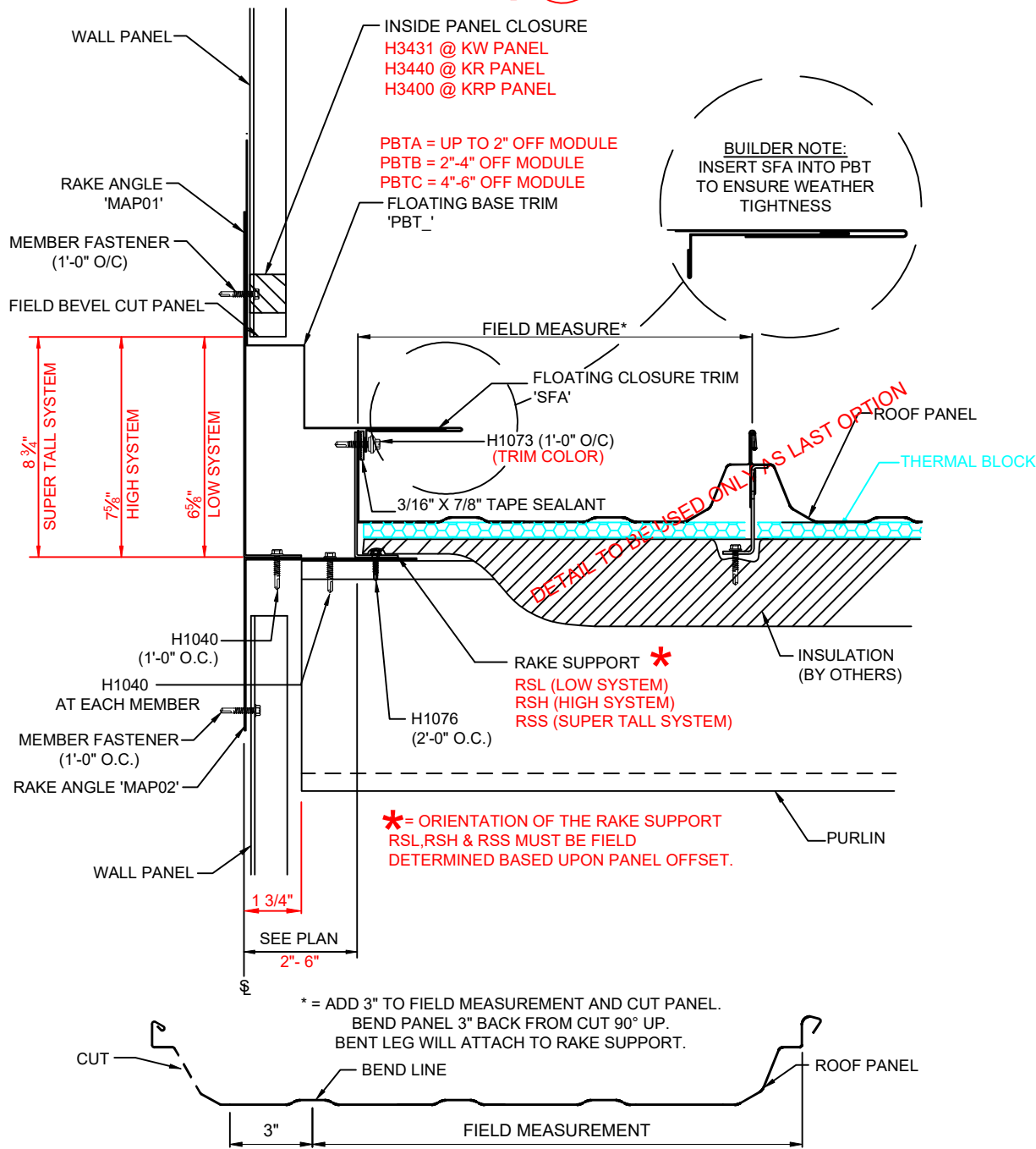

EF8112K

TRAPEZOIDAL ROOF HIGH/LOW DETAIL
SHEETED BELOW
FIELD BEND ROOF PANEL



PREPARED BY: SDF

DATE: 5-20-21

EF8112

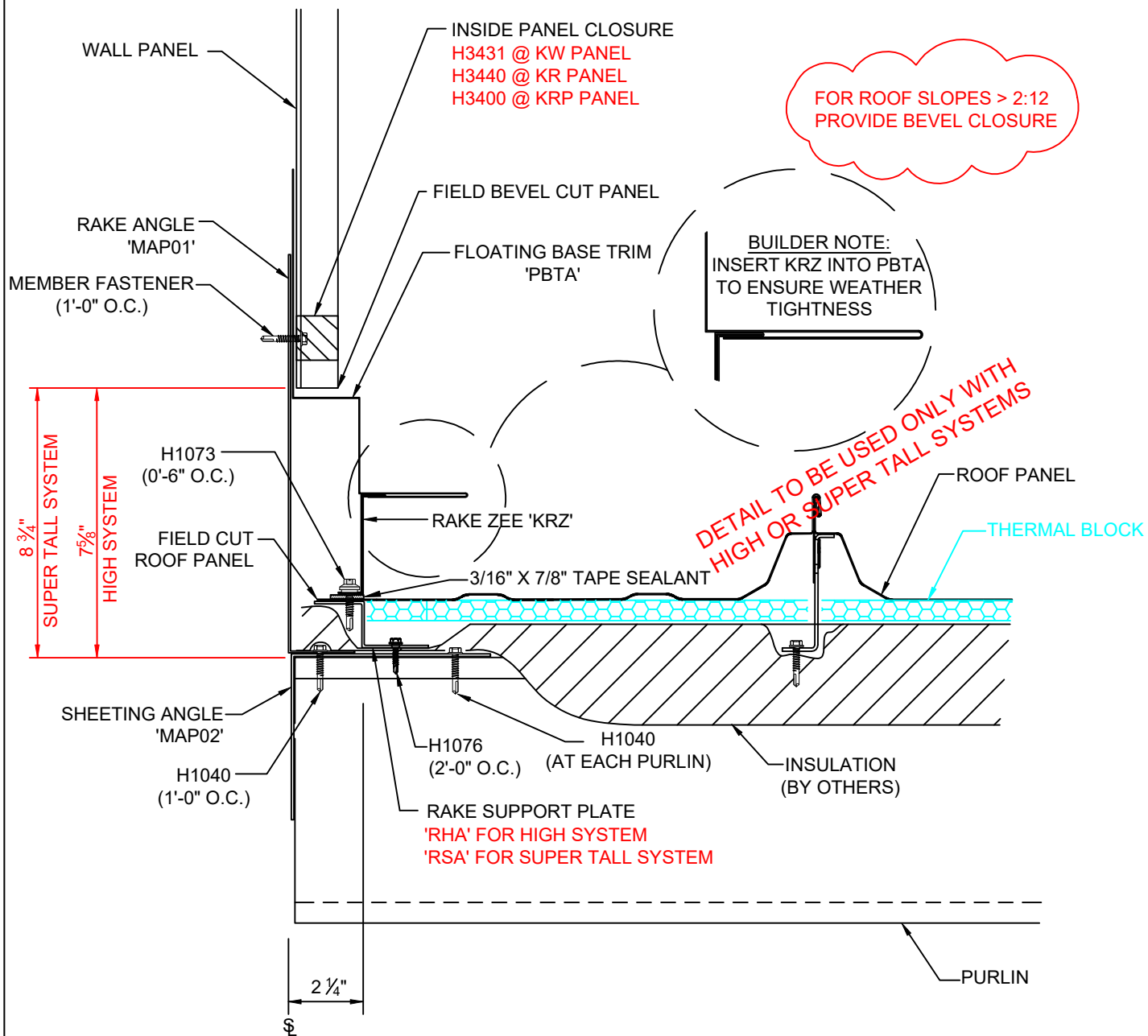

EF8013 **K**

TRAPEZOIDAL ROOF HIGH/LOW DETAIL OFF MODULE
OPEN BELOW
(FIELD CUT ROOF PANEL)

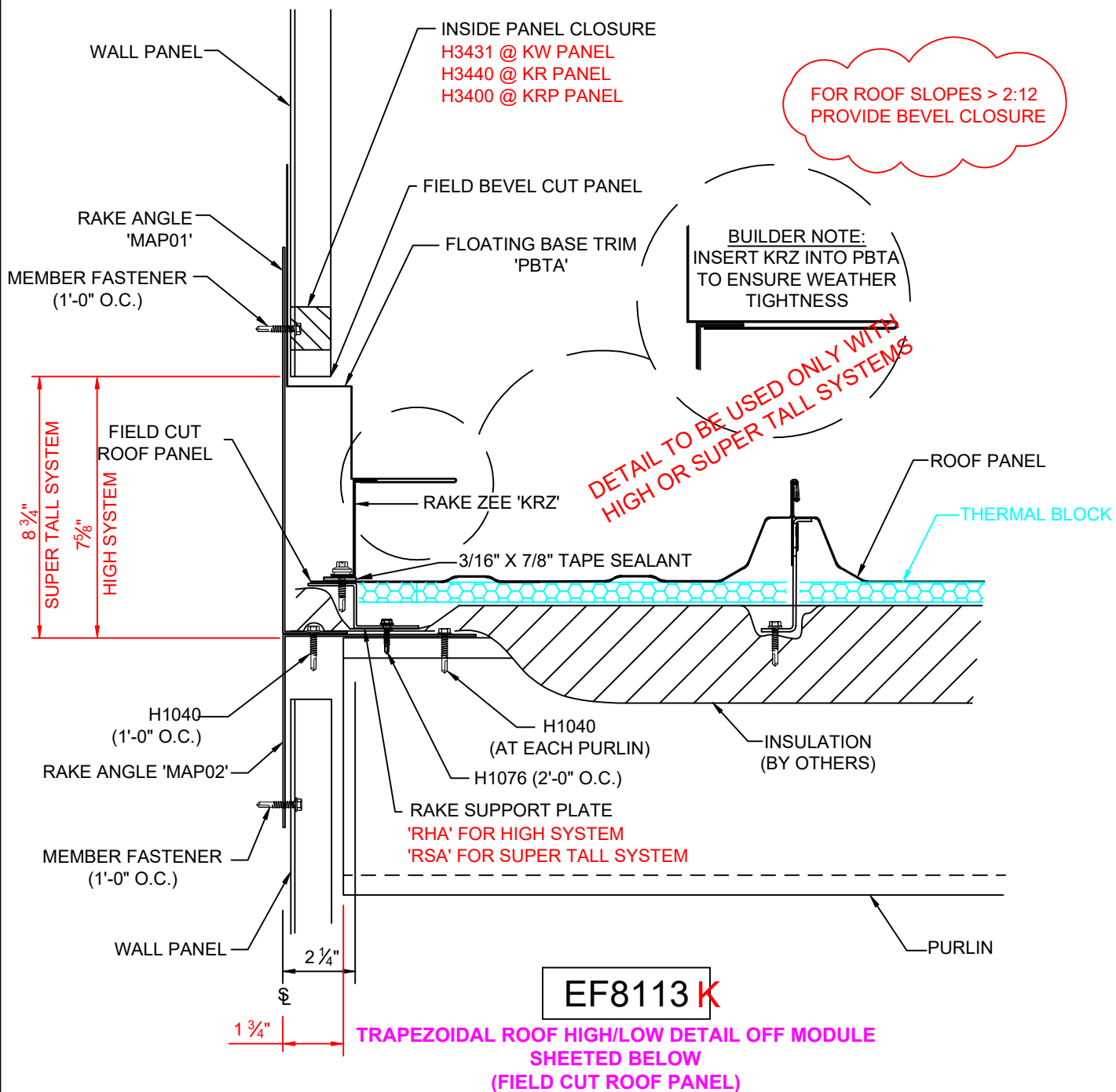

*= ORIENTATION OF THE RAKE SUPPORT
RSL,RSH & RSS MUST BE FIELD
DETERMINED BASED UPON PANEL OFFSET.

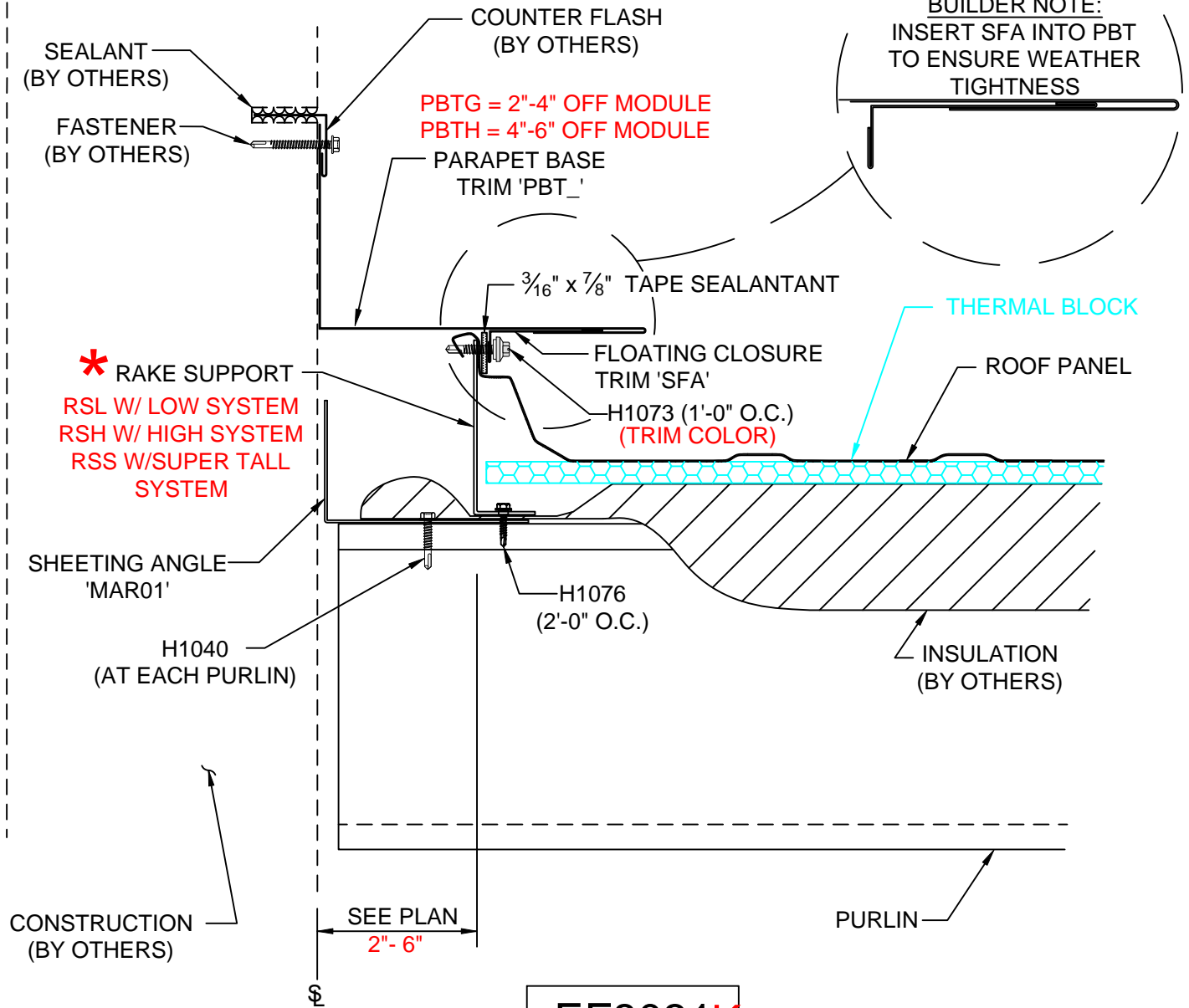

EF8031K

SS360 STARTING/ENDING DETAIL
HIGH/LOW
PARAPET CONSTRUCTION BY OTHERS

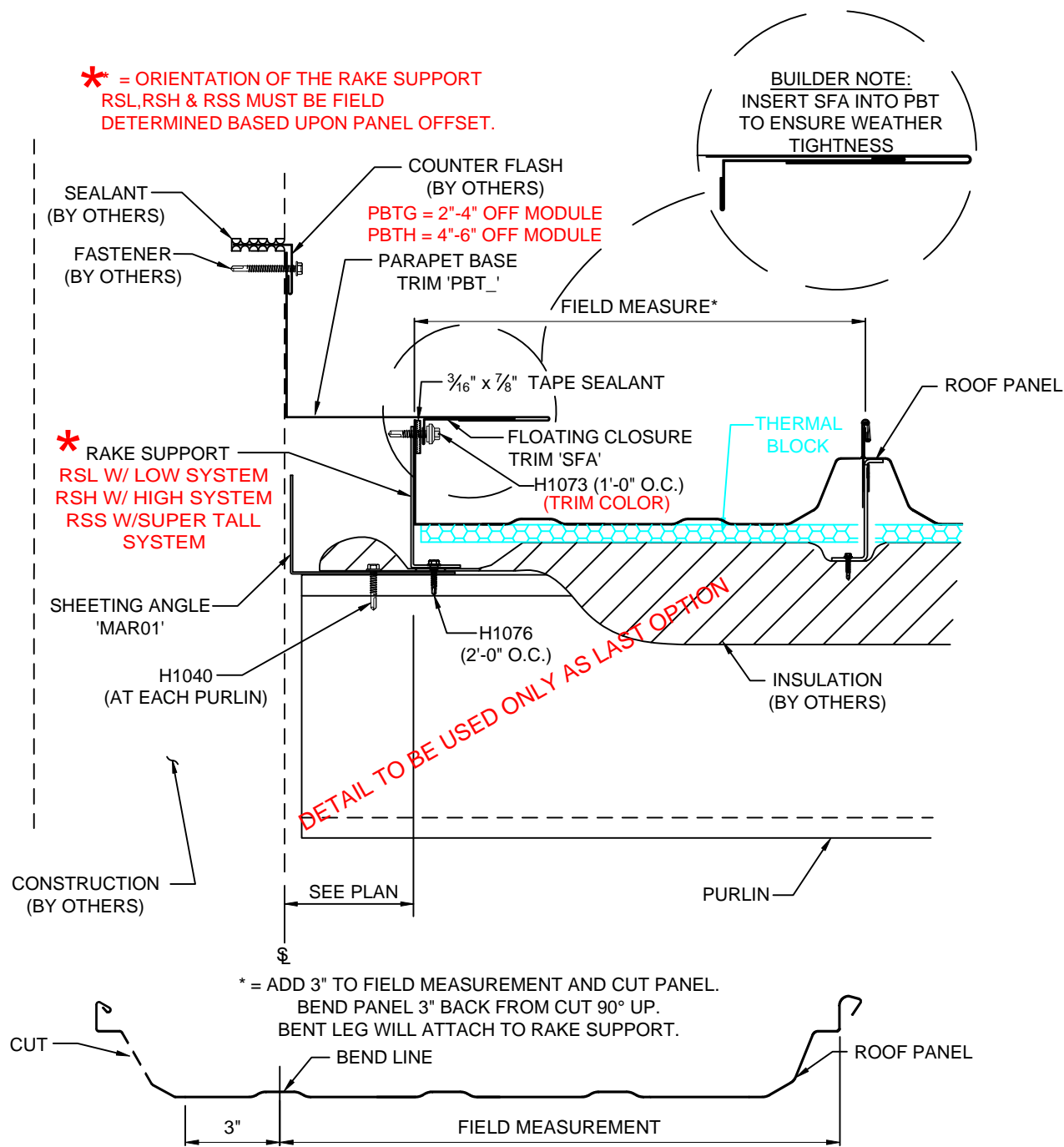

EF8032K

SS360 HIGH/ LOW (OFF MODULE)
PARAPET CONSTRUCTION BY OTHERS



PREPARED BY: BKC/JAC

DATE:4-16-20

EF8032

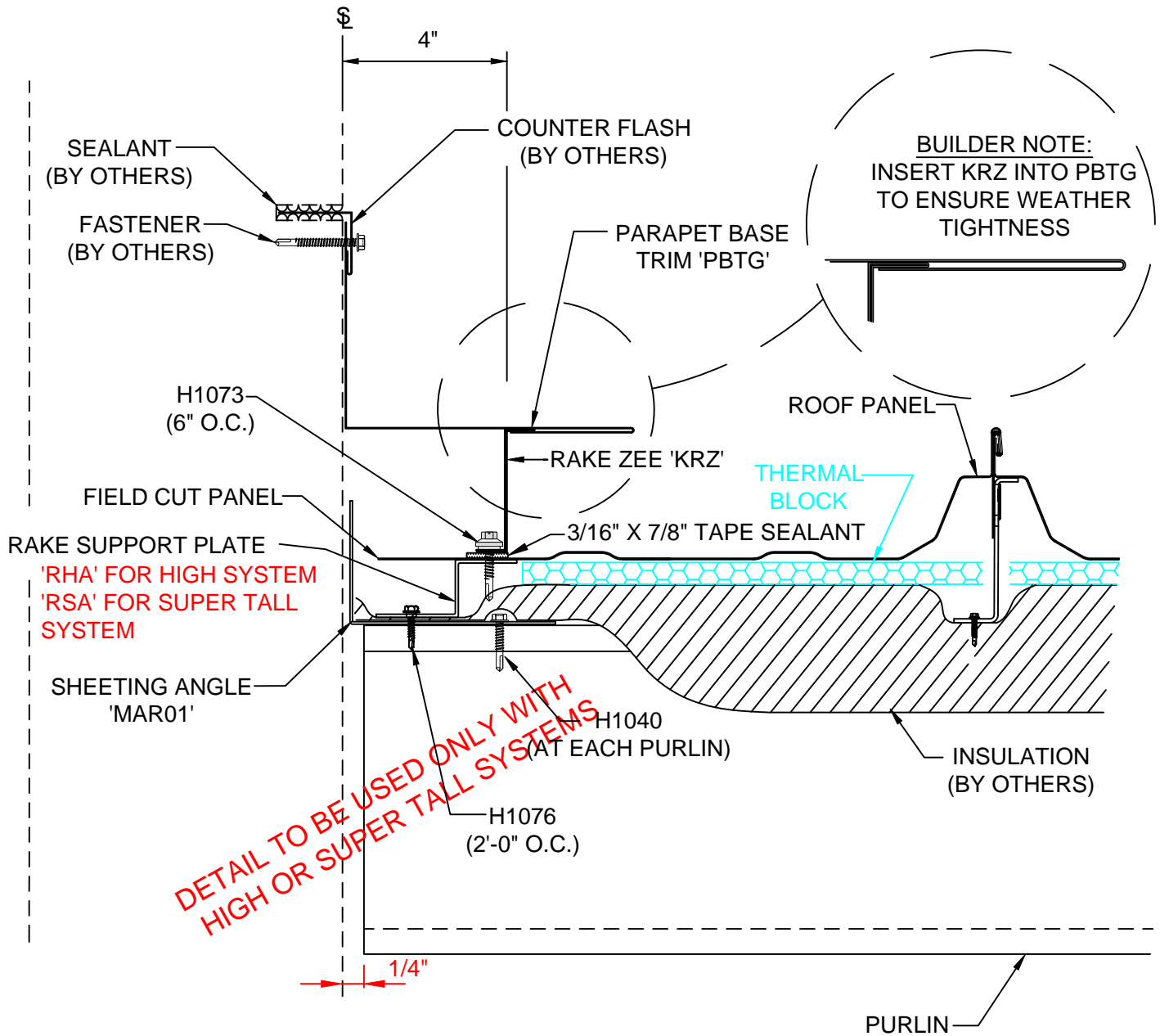

EF8033K

SS360 DETAIL HIGH/ LOW SYSTEM (OFF MODULE)
PARAPET CONSTRUCTION BY OTHERS