

EA8025 - Std. Endlap

EA8125 - Pinned Mid-Point Detail

EA8888 - Repair Cap Installation

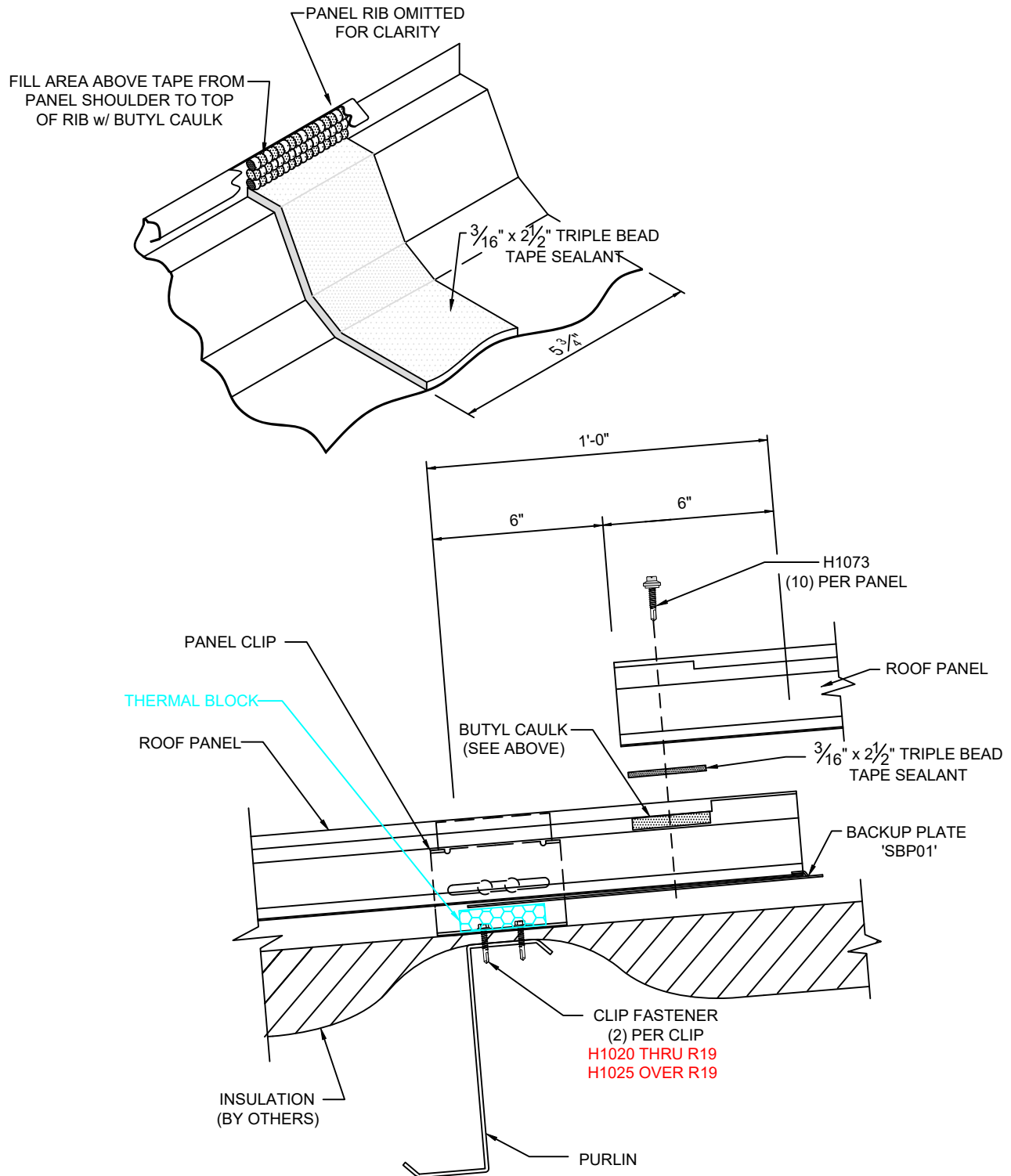

EA8025K

SS360 ENDLAP DETAIL

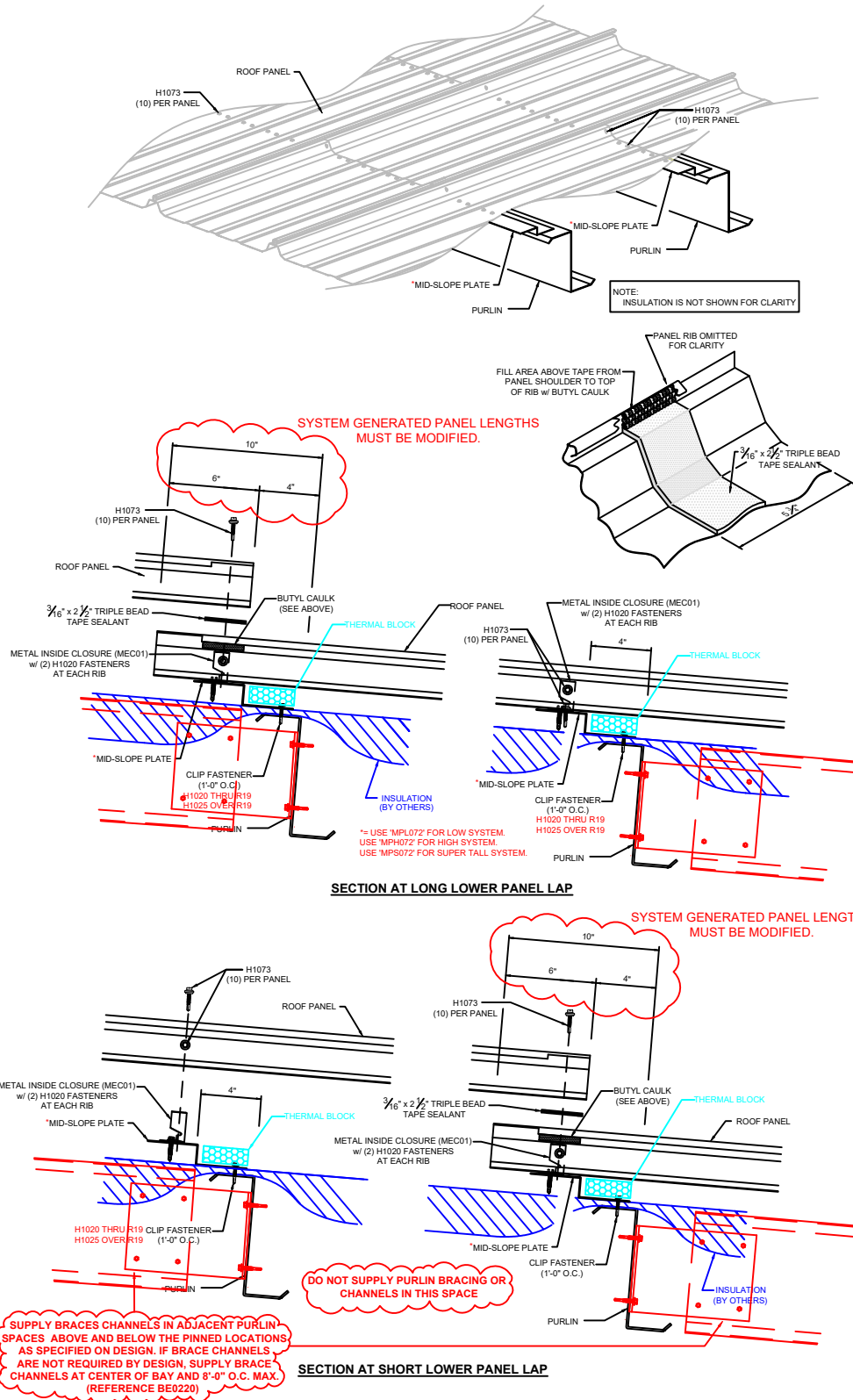

AT EACH CLIP IN DAMAGED AREA, DRILL  
(2) HOLES THROUGH CLIP AND BOTH  
SIDES OF PANEL SEAM.  
INSTALL (2)  $\frac{3}{16}$ " X  $\frac{9}{16}$ " CLOSED END RIVETS.

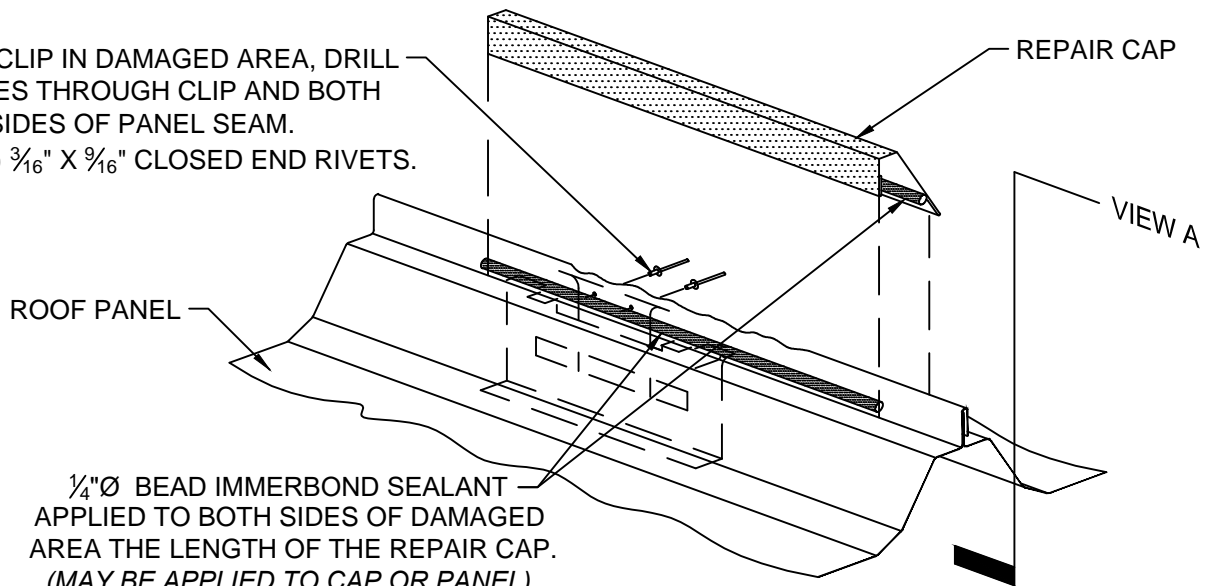

$\frac{1}{4}$ "Ø BEAD IMMERBOND SEALANT  
APPLIED TO BOTH SIDES OF DAMAGED  
AREA THE LENGTH OF THE REPAIR CAP.  
(MAY BE APPLIED TO CAP OR PANEL)

NOTE:  
EXTEND THE REPAIR CAP 6" (MIN.) UPHILL  
AND DOWNHILL OF DAMAGED AREA

USE 25 LINEAR FEET PER TUBE  
TO CALCULATE IMMERBOND QUANTITY

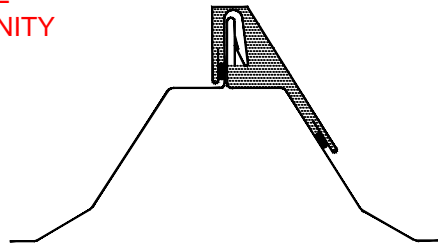

VIEW 'A'

FILL ENTIRE CAVITY AREA AT BOTH ENDS  
OF REPAIR CAP WITH IMMERBOND SEALANT  
TO CREATE A WEATHER TIGHT SEAL

EA8888K

SS360 REPAIR CAP INSTALLATION