

DM0041 - TRANSLUCENT PANEL
DM0141 - TRANSLUCENT PANEL UL RATED
DM0122 - Insulated Transulent Installation w/o 5' Spaces

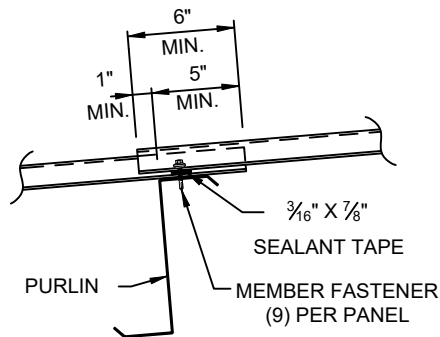

ENDLAP DETAIL

THE KR TRANSLUCENT PANEL (H9320) IS 10'-8" LONG.

THE BUILDER WILL ADJUST THE ENDLAP

UP OR DOWNHILL.

WHEN USING H9320's, IF THE TOTAL LAP EXCEEDS 1'-0" PLACE A NOTE ON THE ERECTION DRAWING TO FIELD CUT THE PANEL. ALSO BE SURE THE BUILDER HAS BEEN NOTIFIED OF THE REDUCED LIGHT AREA.

WHEN USING H9318's, IF THE PURLIN SPACING IS ANYTHING OTHER THAN 5'-0" O.C. GET ASSISTANCE FROM PRODUCT DEVELOPMENT.

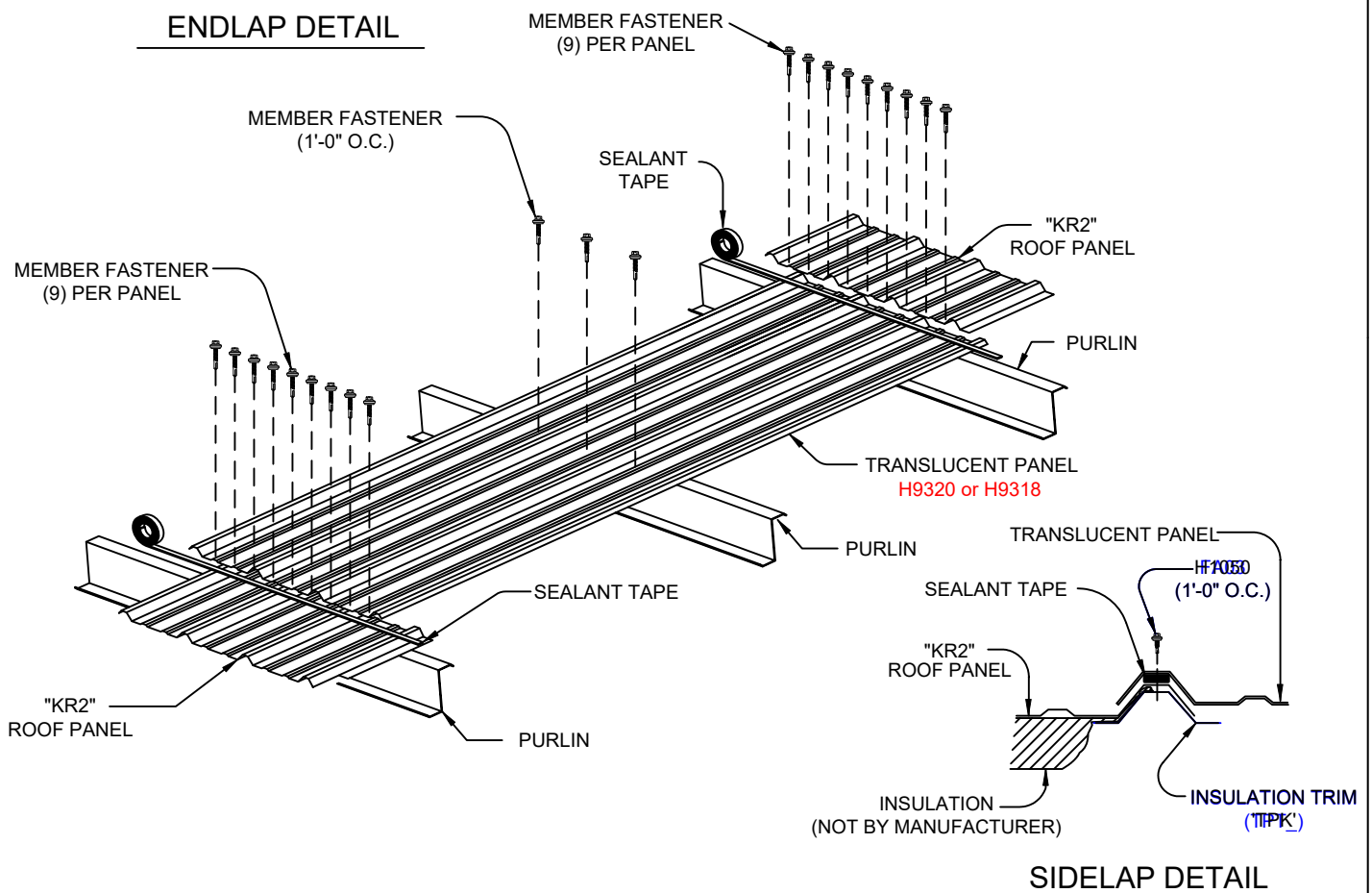

SIDELAP DETAIL

DM0041K

KR TRANSLUCENT PANEL INSTALLATION
NON-UL RATED

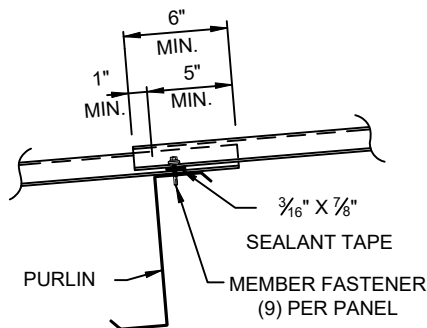

ENDLAP DETAIL

THE KR TRANSLUCENT PANEL (H9320) IS 10'-8" LONG.
THE BUILDER WILL ADJUST THE ENDLAP
UP OR DOWNHILL.

WHEN USING H9320's, IF THE TOTAL LAP EXCEEDS 1'-0" PLACE A NOTE ON
THE ERECTION DRAWING TO FIELD CUT THE PANEL. ALSO BE SURE THE
BUILDER HAS BEEN NOTIFIED OF THE REDUCED LIGHT AREA.

WHEN USING H9318's, IF THE PURLIN SPACING IS ANYTHING OTHER
THAN 5'-0" O.C. GET ASSISTANCE FROM PRODUCT DEVELOPMENT.

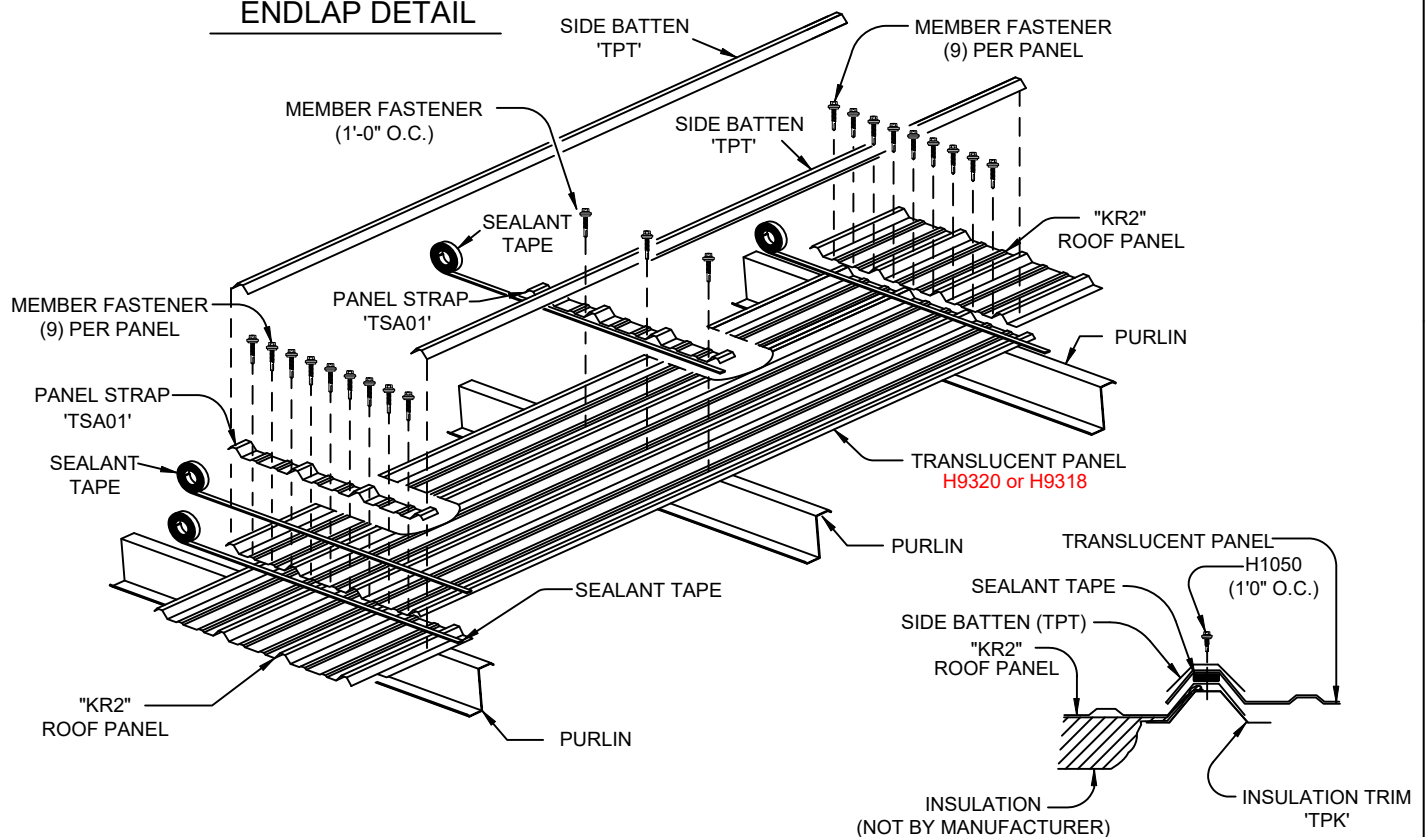

SIDELAP DETAIL

DM0141K

KR TRANSLUCENT PANEL INSTALLATION
UL RATED

ERECTOR NOTES

1. ERECT TRANSLUCENT PANEL IN THE SAME SEQUENCE AS A METAL PANEL (U.N.O.), INNER TRANSLUCENT PANEL UNDERNEATH THE PREVIOUS AND DOWN SLOPE PANELS.
2. BE SURE TRANSLUCENT PANEL & TAPE SEALANT ARE FREE OF DUST & DEBRIS BEFORE INSTALLATION. ALL PANELS & MASTIC MUST BE ASSEMBLED BEFORE FASTENERS ARE INSTALLED.
3. FASTENERS MUST PENETRATE THE TAPE SEALANT.
4. USE 3/16" x 7/8" TAPE SEALANT AT ALL LAPS AND PANEL STRAPS.
5. NEVER STEP, STAND OR APPLY WEIGHT TO TRANSLUCENT PANELS.

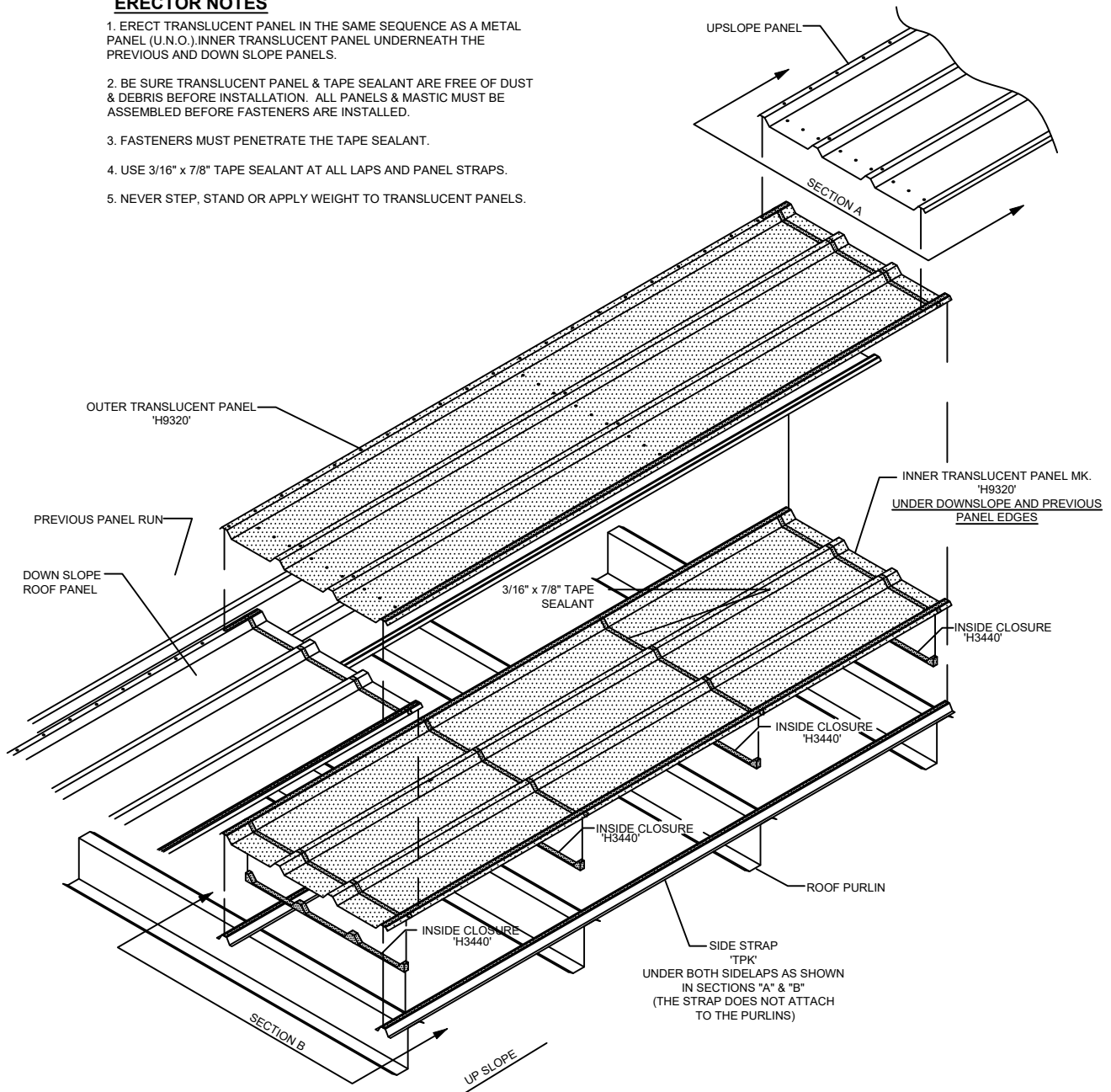

DM0122K

INSULATED TRANSLUCENT PANEL INSTALLATION INSTRUCTION FOR PURLIN SPACING OTHER THAN 5'-0"