

New Product Examples 1

New Product Examples 2

CP0050 - Tie Channel at Strut Girt

CP3110 - Std. Girt Brace Attachment

CP3132 - Brace Channel Header to Girt

MBS shows bracing rows from the base to the top member, but that's not how the bracing should be detailed. We must only ensure that every girt is braced to another girt with a pair of angles. Avoid bracing to the top member or to the base.

DESIGN LAYOUT

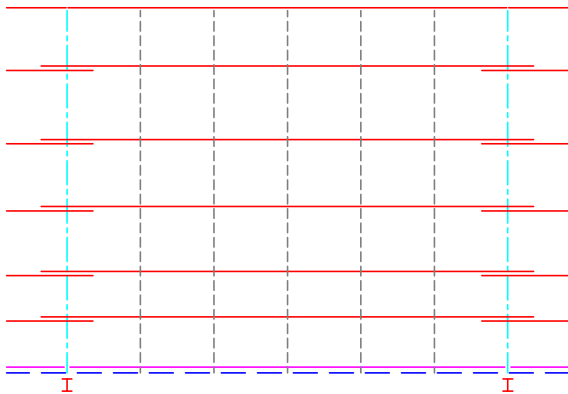

DETAILED LAYOUT

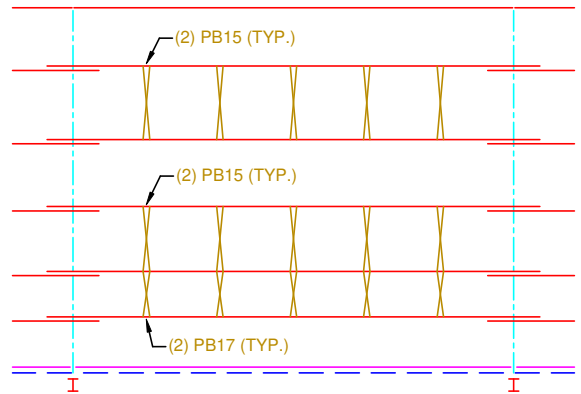

Note: When girts are punched for subjamb or brace angle attachment, then locating dimensions are not required.

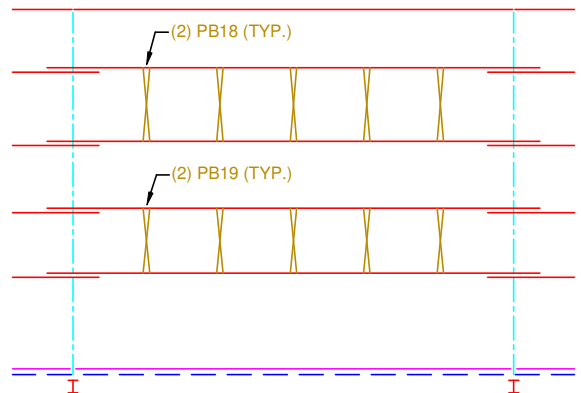
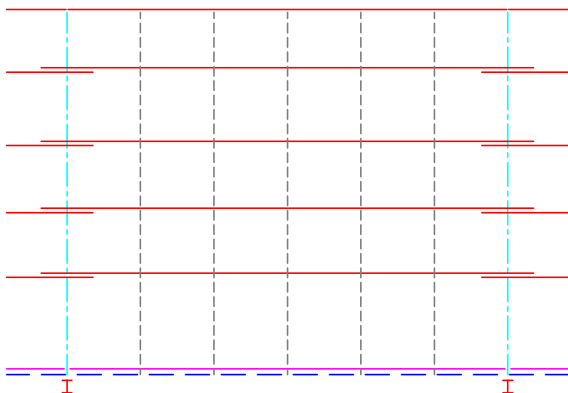

MBS shows bracing rows from the base to the top member, but that's not how the bracing should be detailed. We must only ensure that every girt is braced to another girt with a pair of angles. Avoid bracing to the top member or to the base.

A full bay header (shown) is also a girt. With standard headers (between jambs) verify with the engineer if the header needs to be braced.

DESIGN LAYOUT

DETAILED LAYOUT

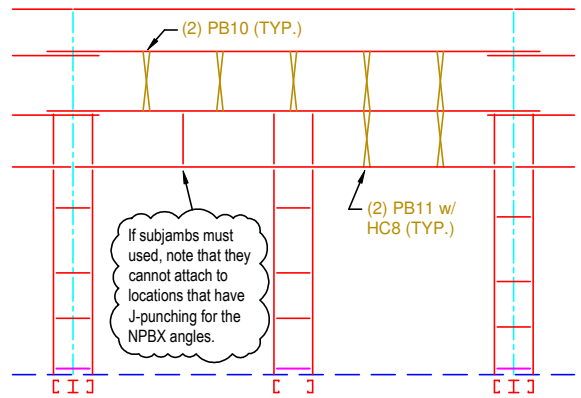
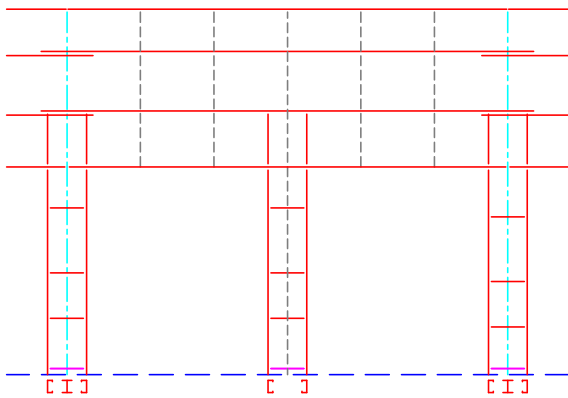

Note: When girts are punched for subjamb or brace angle attachment, then locating dimensions are not required.

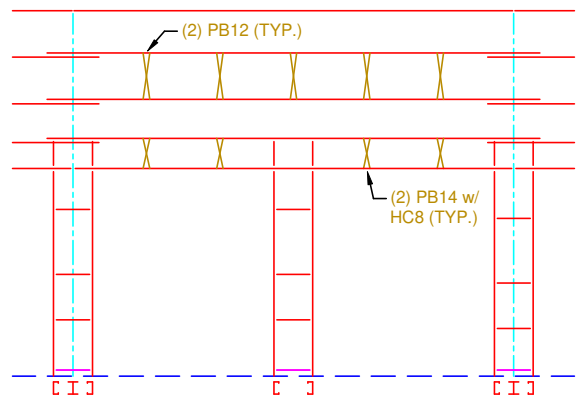
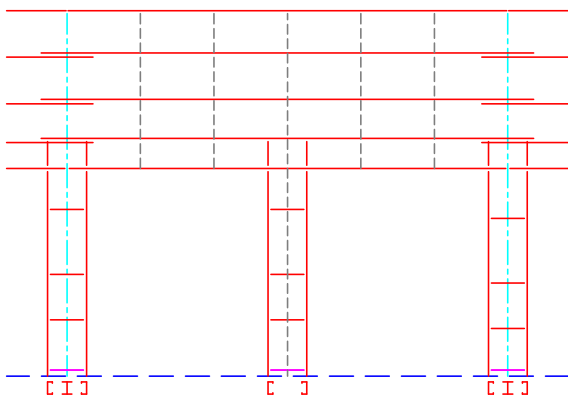

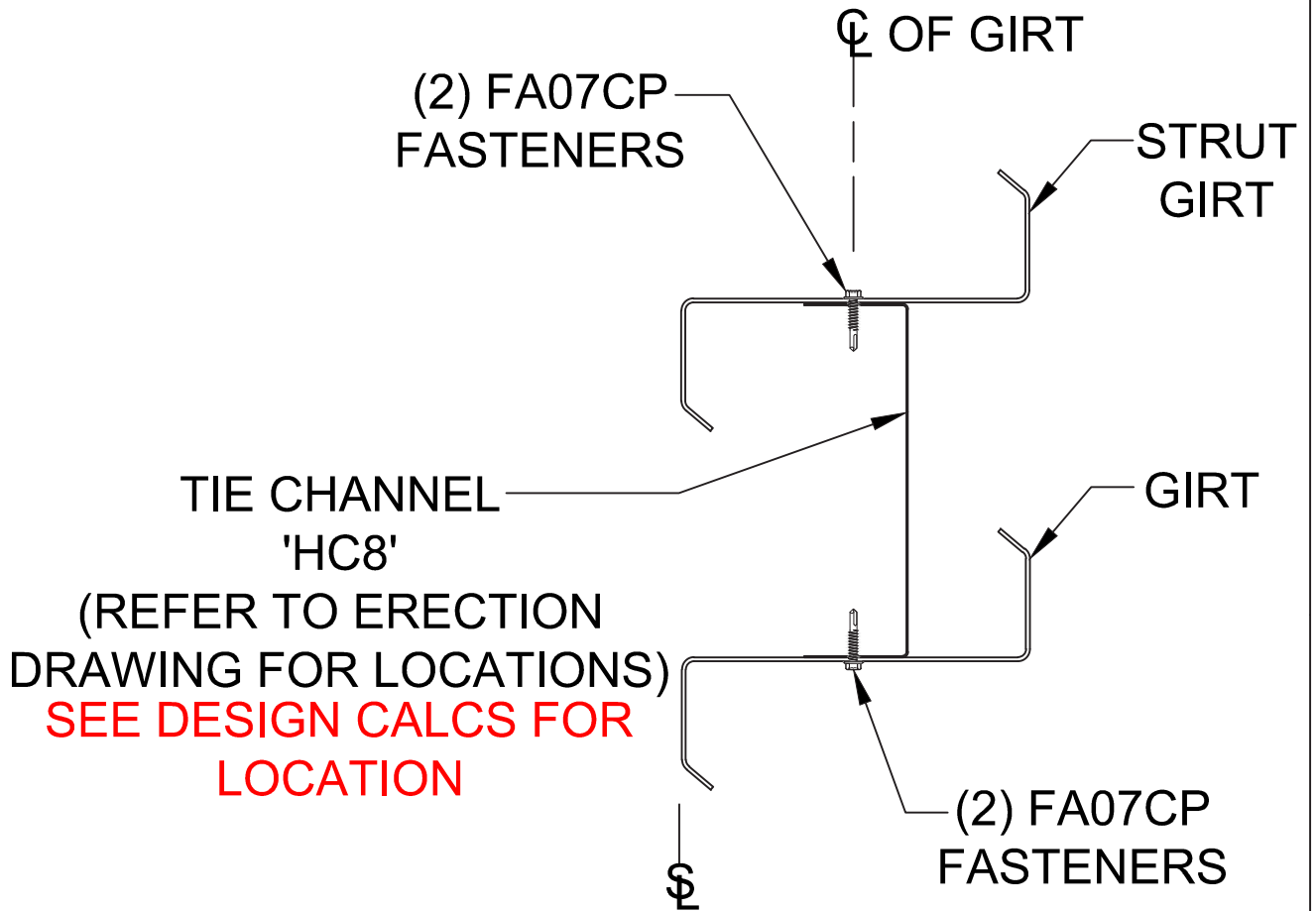

CP0050K

TIE CHANNEL AT STRUT GIRT

INSTALLATION INSTRUCTIONS

1) FOR GIRT BRACE "X", INSERT ANGLES "BACK-TO-BACK" INTO THE FACTORY PUNCHED SLOTS. BEND TABS AS SHOWN AND FASTEN THROUGH TAB WITH (1) FASTENER PER END.

2) CONNECT GIRT BRACE "X" AT THE ANGLE INTERSECTION WITH (1) FASTENER.

NOTE: GIRT BRACING IS NOT TO DISTORT OR ALTER GIRTS FROM THEIR INTENDED SHAPE OR LOCATION.

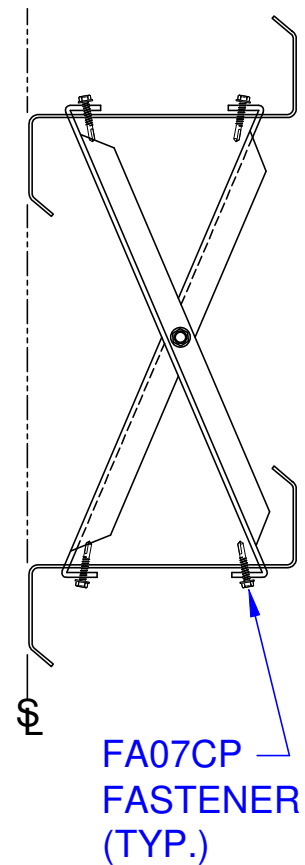

CP3110

STANDARD GIRT BRACE ATTACHMENT

INSTALLATION INSTRUCTIONS

1) FOR GIRT BRACE "X", INSERT ANGLES "BACK-TO-BACK" INTO THE FACTORY PUNCHED SLOTS IN THE UPPER GIRT. BEND UPPER TABS AS SHOWN AND FASTEN THROUGH TAB WITH (1) FASTENER PER END.

2) ATTACH HC_ TO HEADER AS SHOWN. BEND LOWER TABS OF GIRT BRACE ANGLES TO PRESS AGAINST HC_ PART. ATTACH BRACE TABS TO HC_ AS SHOWN.

3) CONNECT GIRT BRACE "X" AT THE ANGLE INTERSECTION WITH (1) FASTENER.

NOTE: GIRT BRACING IS NOT TO DISTORT OR ALTER GIRTS FROM THEIR INTENDED SHAPE OR LOCATION.

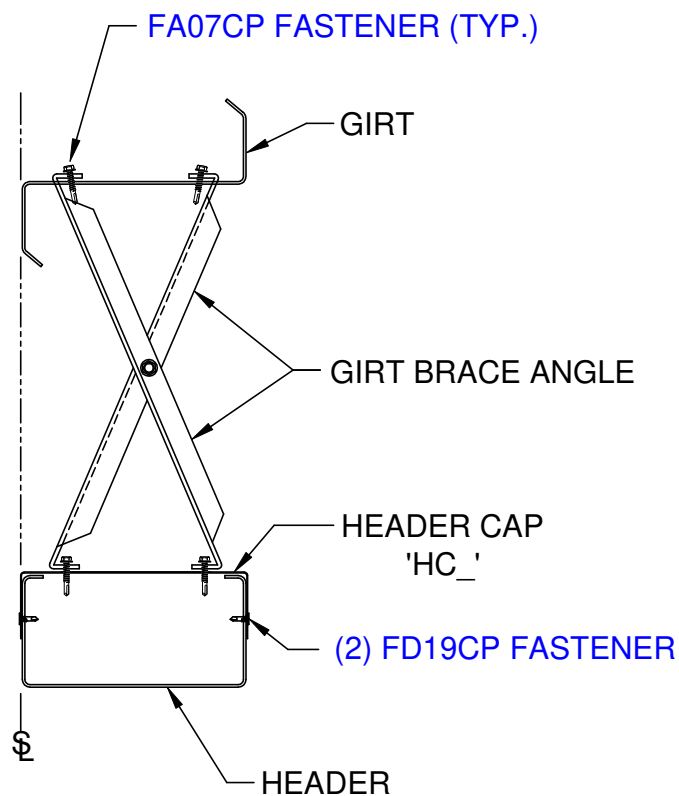

CP3132

BRACE ANGLE ATTACHMENT HEADER TO GIRT